

NEW FasNSeal® 80/90

**Exhausts 90+ condensing appliances with
Type B atmospheric units within the same vent.**

FasNSeal® & FasNSeal® W2

**Single-wall and double-wall special gas vent
systems. UL 1738 and ULC S636.**

FasNSeal® Flex

**Flexible chimney liner for special gas vent
system. UL 1738 and UL 1777.**



FASNSEAL 80/90

Change to High Efficiency? Utilize Your Existing Common Vent!

LISTINGS

M&G DuraVent's FNS 80/90 Combination Cat I and Cat IV gas vent system is designed and UL listed for use with approved M&G DuraVent / Security Chimneys special gas vent components only! Listed to applicable portions of ULC S636/UL1777, and UL441.

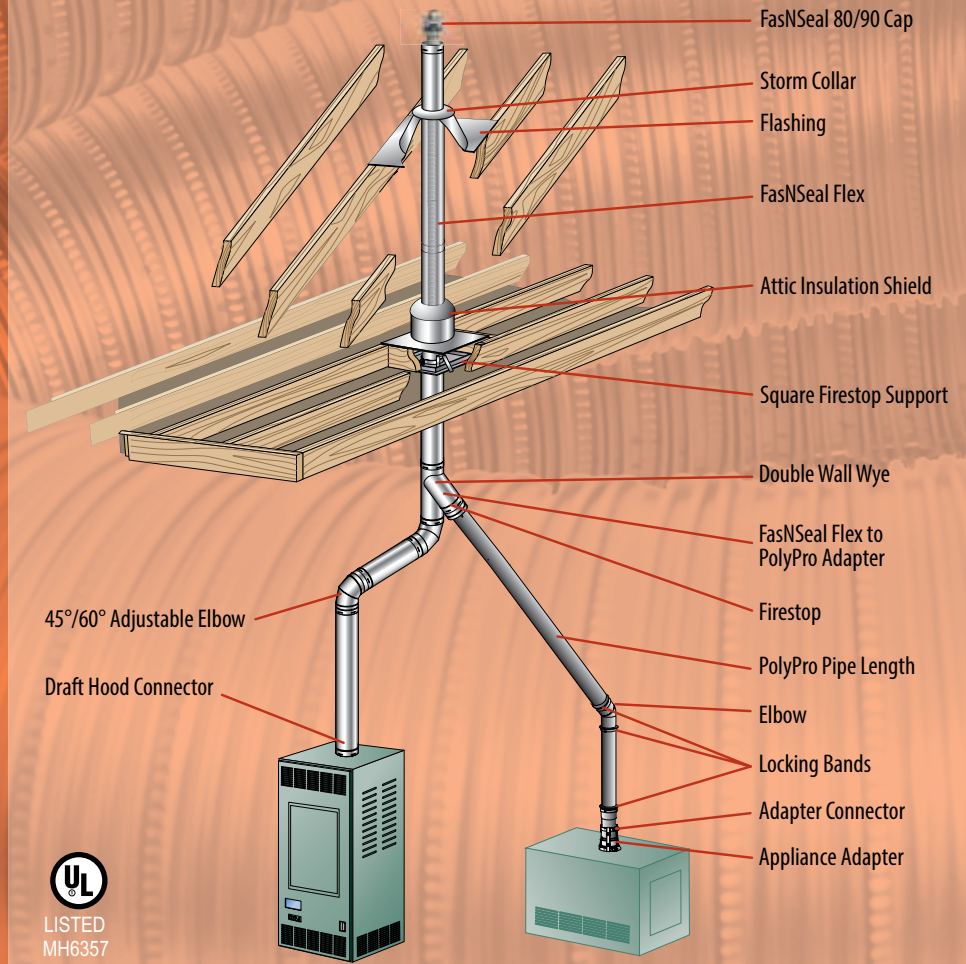

| FasNSeal 80/90 Feature | Benefit |
|---|---|
| Available in 5" - 8" B Vent Diameters. | Fits most residential common vent systems. |
| Approved for installation in other manufacturers B Vent, with listed Cat I adapters available. | Unmatched installation flexibility. |
| SS flex has smooth inner wall. | Superior flow performance allowing longer runs before upsizing, and superior condensate management. |
| Corrosion resistant SS steel flex liner. | Withstands high temperatures inside Cat I vent. |
| Dual path (Cat I / Cat IV) termination cap. | Warm Cat I exhaust helps reduce icing on condensing Cat IV exhaust. |
| Engineered sizing guidance for combined system. | Addition of SS flex to "orphaned" common vent system helps reduce oversizing issues, enhances draft of remaining Cat I appliance. |
| Compatible with portfolio of M&G DuraVent special gas vent products, including PolyPro and FNS. | Utilize exiting appliance adapters, current appliance approvals. |
| Vertical Termination. | Eliminates issues with Horizontal terminations, including wind effects, icing, code issues, etc. |
| Combined Cat I / Cat IV vent system takes up no additional space. | No additional building penetrations required, no disturbing finished internal spaces, etc. |
| UL tested, listed engineered system. | Industry first (and only) listing of it's kind. |

STRAIGHT UP INSTALLATION

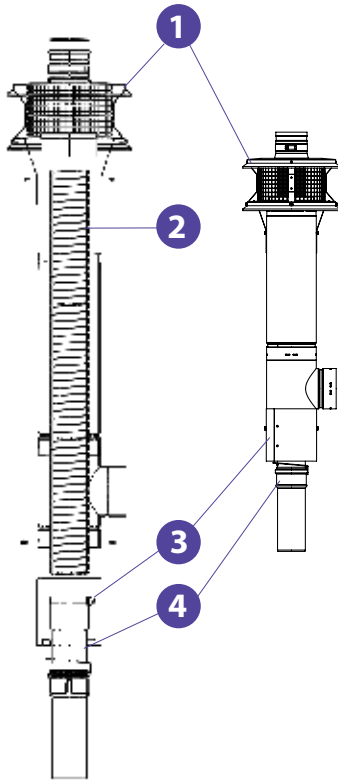

WYE INSTALLATION

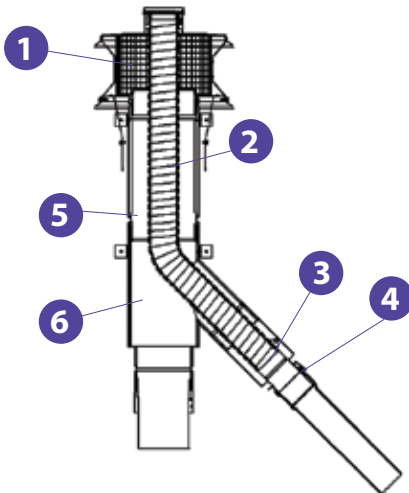

| Description | Order # | Stock # |
|---|-------------|-----------|
| B-Vent Firestop 3 | | |
| 3x2 B-Vent Firestop | FSFS-GVPP32 | 810012604 |
| 4x2 B-Vent Firestop | FSFS-GVPP42 | 810012605 |
| 4x3 B-Vent Firestop | FSFS-GVPP43 | 810012606 |
| 5x2 B-Vent Firestop | FSFS-GVPP52 | 810012607 |
| 5x3 B-Vent Firestop | FSFS-GVPP53 | 810012608 |
| 5x4 B-Vent Firestop | FSFS-GVPP54 | 810012609 |
| 6x2 B-Vent Firestop | FSFS-GVPP62 | 810012610 |
| 6x3 B-Vent Firestop | FSFS-GVPP63 | 810012611 |
| 6x4 B-Vent Firestop | FSFS-GVPP64 | 810012612 |
| 6x5 B-Vent Firestop | FSFS-GVPP65 | 810012613 |
| Universal Female Adapter 5 | | |
| 3" Female Adapter | 3GVAF | 810002517 |
| 4" Female Adapter | 4GVAF | 810002565 |
| 5" Female Adapter | 5GVAF | 810002612 |
| 6" Female Adapter | 6GVAF | 810002661 |
| 7" Female Adapter | 7GVAF | 810002699 |
| 8" Female Adapter | 8GVAF | 810002734 |
| Double Wall Wye 45° Branch 6 | | |
| 4"x4"x3" Double Wall Wye | 4GVY43 | 810002556 |
| 4"x4"x4" Double Wall Wye | 4GVY44 | 810002557 |
| 4"x3"x4" Double Wall Wye | 4GVY34 | 810002558 |
| 5"x3"x4" Double Wall Wye | 5GVY34 | 810002605 |
| 5"x4"x4" Double Wall Wye | 5GVY44 | 810002606 |
| 5"x4"x5" Double Wall Wye | 5GVY45 | 810002607 |
| 6"x3"x4" Double Wall Wye | 6GVY34 | 810002652 |
| 6"x4"x3" Double Wall Wye | 6GVY43 | 810002653 |
| 6"x4"x4" Double Wall Wye | 6GVY44 | 810002654 |
| 6"x4"x5" Double Wall Wye | 6GVY45 | 810002655 |
| 6"x3"x5" Double Wall Wye | 6GVY35 | 810002656 |
| 6"x4"x6" Double Wall Wye | 6GVY46 | 810002657 |
| 7"x3"x5" Double Wall Wye | 7GVY35 | 810002696 |



| | Annular Space - Effective Remaining B Vent Diameter | | | |
|-----------|---|------------------|------------------|------------------|
| | Ø2" Cat IV Liner | Ø3" Cat IV Liner | Ø4" Cat IV Liner | Ø5" Cat IV Liner |
| 5" B Vent | 4" | 3" | N/A | N/A |
| 6" B Vent | 5" | 4" | 4" | N/A |
| 7" B Vent | 6" | 5" | 5" | 4" |
| 8" B Vent | 6" | 6" | 6" | 5" |

| Description | Order # | Stock # |
|---|-------------|-----------|
| Vertical Terminations 1 | | |
| Ø5"x2" Combo Cap | FSCC52 | 810010327 |
| Ø5"x3" Combo Cap | FSCC53 | 810010328 |
| Ø6"x2" Combo Cap | FSCC62 | 810010329 |
| Ø6"x3" Combo Cap | FSCC63 | 810010330 |
| Ø6"x4" Combo Cap | FSCC64 | 810010331 |
| Ø7"x2" Combo Cap | FSCC72 | 810010332 |
| Ø7"x3" Combo Cap | FSCC73 | 810010333 |
| Ø7"x4" Combo Cap | FSCC74 | 810010334 |
| Ø8"x2" Combo Cap | FSCC82 | 810010335 |
| Ø8"x3" Combo Cap | FSCC83 | 810010336 |
| Ø8"x4" Combo Cap | FSCC84 | 810010337 |
| Ø7"x5" Combo Cap | FSCC75 | 810012622 |
| Ø8"x5" Combo Cap | FSCC85 | 810012623 |
| FasNSeal Flex 2 | | |
| Ø2"x20' FasNSeal Flex | 2FSFLEX-20 | 810012522 |
| Ø2"x25' FasNSeal Flex | 2FSFLEX-25 | 810012523 |
| Ø2"x30' FasNSeal Flex | 2FSFLEX-30 | 810012524 |
| Ø2"x35' FasNSeal Flex | 2FSFLEX-35 | 810012525 |
| Ø2"x50' FasNSeal Flex | 2FSFLEX-50 | 810012558 |
| Ø2"x200' FasNSeal Flex | 2FSFLEX-200 | 810012559 |
| Ø2"x20' FasNSeal Flex | 2FSFLEX-200 | 810012559 |
| Ø2" Custom FNS Flex | 2FSFLEX-XX | 810012526 |
| Ø3" x 20' FasNSeal Flex | 3FSFLEX-20 | 810003100 |
| Ø3" x 25' FasNSeal Flex | 3FSFLEX-25 | 810003101 |
| Ø3" x 30' FasNSeal Flex | 3FSFLEX-30 | 810003102 |
| Ø3" x 35' FasNSeal Flex | 3FSFLEX-35 | 810003103 |
| Ø3" x 200" FasNSeal Flex | 3FSFLEX-200 | 810003104 |
| Ø4" x 20' FasNSeal Flex | 4FSFLEX-20 | 810003151 |
| Ø4" x 25' FasNSeal Flex | 4FSFLEX-25 | 810003152 |
| Ø4" x 30' FasNSeal Flex | 4FSFLEX-30 | 810003153 |
| Ø4" x 35" FasNSeal Flex | 4FSFLEX-35 | 810003154 |
| Ø4" x 200" FasNSeal Flex | 4FSFLEX-200 | 810003155 |
| Ø5" x 20' FasNSeal Flex | 5FSFLEX-20 | 810003208 |
| Ø5" x 25' FasNSeal Flex | 5FSFLEX-25 | 810003209 |
| Ø5" x 30' FasNSeal Flex | 5FSFLEX-30 | 810003210 |
| Ø5" x 35" FasNSeal Flex | 5FSFLEX-35 | 810003211 |
| Ø5" x 125" FasNSeal Flex | 5FSFLEX-125 | 810003212 |
| PP to FNS Flex Adapter 4 | | |
| 2" PP to FNS Flex Adapter | FSASMM-PP-2 | 810009850 |
| 3" PP to FNS Flex Adapter | FSASMM-PP-3 | 810010261 |
| 4" PP to FNS Flex Adapter | FSASMM-PP-4 | 810010262 |
| 5" PP to FNS Flex Adapter | FSASMM-PP-5 | 810010263 |

Specifications

Applications

FasNSeal and FasNSeal Flex is for use with natural gas or propane Categories II, III and IV appliances or Canada's Type BH Gas Vent Systems, having a maximum rated operating temperature of 480°F and a maximum positive pressure of 15" (FasNSeal Flex 6") water column. FasNSeal can be used on a wide range of applications, including: high efficiency gas boilers, furnaces, booster heaters, pool heaters, water heaters, unit heaters, or tankless water heaters.

FasNSeal W2 is ideal for use on commercial applications such as: office buildings, medical facilities, condos, or multiple unit apartment complexes where there is the need for low clearances to combustibles. In residential applications, FasNSeal W2 is the perfect solution for running between floor joists or in walls.

Materials and Construction

FasNSeal

3"–7": AL29-4C .016"
8"–12": AL29-4C .019"
14"–24": AL29-4C .024"

FasNSeal Flex

Single strip double layer super-ferritic stainless steel (totalling .010").

FasNSeal W2

3"–6": AL29-4C stainless steel .016" inner wall, stainless steel .016" outer wall.
7": AL29-4C stainless steel .016" inner wall, stainless steel .024" outer wall.
8"–12": AL29-4C stainless steel .019" inner wall, stainless steel .024" outer wall.
14"–24": AL29-4C stainless steel .024" inner wall, stainless steel .024" outer wall.

Diameters

FasNSeal (single- and double-wall)
3"–24"

FasNSeal Flex 3"–12"

Listings

FasNSeal (single- and double-wall)
UL Listed to UL 1738 and ULC S636.

FasNSeal Flex UL Listed to UL 1738 and UL 1777 and ULC S636.

UL 1738 and ULC S636 Systems

FasNSeal & FasNSeal W2

All FasNSeal (single-wall) and FasNSeal W2 (double-wall) vent lengths and components feature patented built-in mechanical locking band and triple-lipped directional gaskets. All pipes and components are engineered with smooth clean welds located 90° from mechanical locking bands. This construction feature allows for ease of installation. The ½" air space between the inner and outer wall on FasNSeal W2 helps to reduce the clearance to combustibles in addition to creating a heat shield for additional safety.

All FasNSeal components which come in contact with exhaust gases and condensates are now silicone free. This important design and manufacturing feature greatly reduces the chances of system breakdown and failure. The main problems with silicone are there are too many adhesion factors which are very difficult to control and the process of binding similar materials with an epoxy, which can weaken the bond over time. Welded seams ensure a leak-free product that is meant to last.

FasNSeal Flex

Made from super-ferritic stainless steel. Corrosion resistant. Manufactured with a sure-seal locking seam for superior strength and flexibility. The smooth inner-wall provides for no output reduction, allowing for full appliance efficiency, ease of cleaning and regular maintenance. The smooth inner wall optimizes gas flow, minimizes back pressure, and facilitates condensate management. Flexible chimney liner is listed to UL 1738 standard.



Typical Installations

Installation Key

| | | | |
|---|------------------------------|----|----------------------------|
| 1 | Rain Cap | 9 | Universal Condensate Drain |
| 2 | Storm Collar | 10 | Appliance Adapter |
| 3 | Variable Pitch Roof Flashing | 11 | Top Plate* |
| 4 | Vent Length | 12 | Female Flex Adapter |
| 5 | Adjustable Vent Length | 13 | FasNSeal Flex |
| 6 | Firestop/Flat Flashing | 14 | Male Flex Adapter |
| 7 | Horizontal Drip Tee | 15 | Standard Tee |
| 8 | Elbow | | |

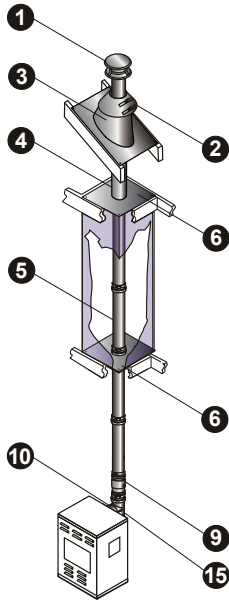

Multi-Story
FasNSeal

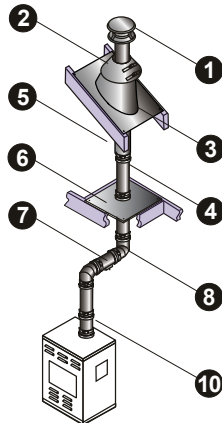

Offset
FasNSeal

Refer to our Typical Venting Installation drawings to select the appropriate component parts for your installation.

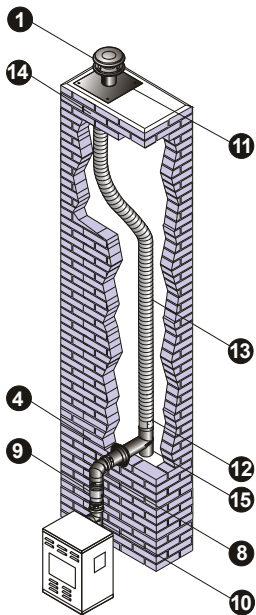

Offset with Tee
FasNSeal Flex & FasNSeal

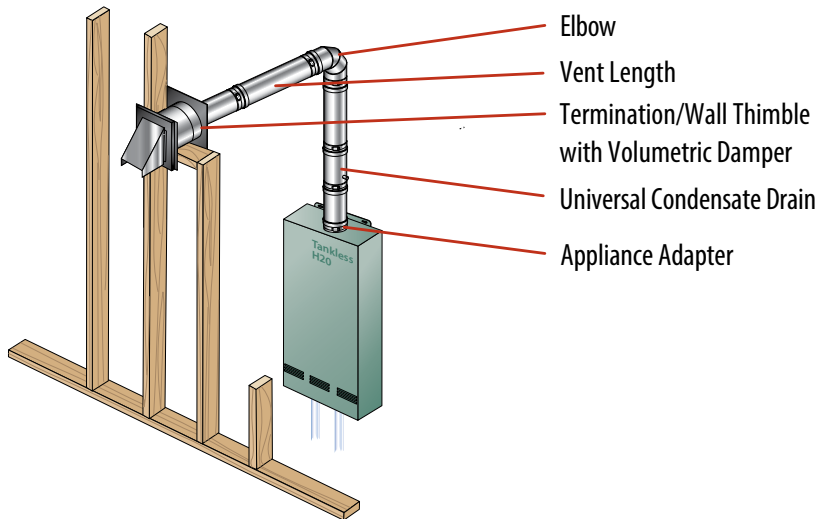

Commercial Applications

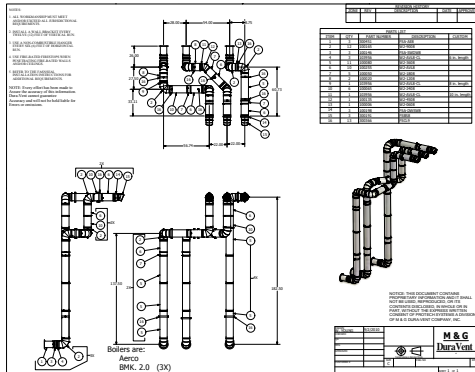

Commercial projects may require custom parts and unique system designs. DuraVent offers complete project assistance:

- **Engineering Services:** Personalized system design services offer comprehensive CAD submittal drawing and complete bills of materials.
- **Custom Parts:** If your project requires innovative solutions, contact DuraVent for custom parts that meet your specific project needs.
- **FasNSeal W2:** FasNSeal W2 is the ideal choice for commercial applications where there is a need for low clearances to combustibles.
- **Up to 24" Vent Diameters:** Many commercial applications require large diameter systems due to the units size and output. Large diameters are available in single and double wall, featuring FasNSeal's triple lipped directional gaskets and built-in locking band which provides a safe and convenient installation.

Clearances Chart

| FasNSeal | | | | | |
|--|-------------------------------|---|---------------|-------------|-------------|
| Rated Operating Temperatures | | Enclosed | | Unenclosed | |
| | | Horizontal | Vertical | Horizontal | Vertical |
| 3" - 4" | 194°F \ 90°C (Canada Only) | 0" | | 0" | |
| | 300°F / 149°C | Sides: 8"/203.2mm Top: 12"/304.8mm Bottom: 4"/101.6mm | 4" 101.6mm | 1" / 25.4mm | |
| | 480°F / 249°C | | | 3" / 76.2mm | 1" / 25.4mm |
| 5" - 24" | 194°F / 90°C (Canada Only) | 0" | | 0" | |
| | 300°F \ 149°C | Noncombustible Enclosure | | 3" / 76.2mm | 3" / 76.2mm |
| | 480°F \ 249°C | | | 3" / 76.2mm | 3" / 76.2mm |
| FasNSeal W2 | | | | | |
| Rated Operating Temperatures | | Enclosed | | Unenclosed | |
| | | Horizontal | Vertical | Horizontal | Vertical |
| 3" - 4" | 194°F (Canada Only) | 0" | 0" | 0" | 0" |
| | 300°F | 3" | 1" | 1" | 1" |
| | 400°F | 6" | 1" | 3" | 1" |
| | 480°F | 6" | 4" | 3" | 1" |
| 5" - 16" | 194°F (Canada Only) | 0" | 0" | 0" | 0" |
| | 300°F | 3" | 1" | 1" | 1" |
| | 400°F | 6" | 1" | 3" | 1" |
| | 480°F | 6" | 6" | 3" | 3" |
| Rated Operating Temperature of 300°F = Max Flue Gas Temperature of 375°F | | | | | |
| Rated Operating Temperature of 480°F = Max Flue Gas Temperature of 550°F | | | | | |

FasNSeal® - Single-Wall

Vent Length

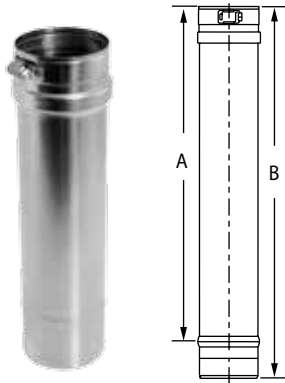

Use to vent category II, III and IV appliances.

| SIZE | ORDER # | STOCK # | A | B | SIZE | ORDER # | STOCK # | A | B |
|------|----------|-----------|-----|-----|------|----------|-----------|-----|-----|
| 3" | FSVL603 | 810003091 | 4" | 6" | 10" | FSVL2410 | 810003429 | 22" | 24" |
| 3" | FSVL1203 | 810003092 | 10" | 12" | 10" | FSVL3610 | 810003430 | 34" | 36" |
| 3" | FSVL1803 | 810003093 | 16" | 18" | 12" | FSVL612 | 810003467 | 4" | 6" |
| 3" | FSVL2403 | 810003094 | 22" | 24" | 12" | FSVL1212 | 810003468 | 10" | 12" |
| 3" | FSVL3603 | 810003095 | 34" | 36" | 12" | FSVL1812 | 810003469 | 16" | 18" |
| 4" | FSVL604 | 810003142 | 4" | 6" | 12" | FSVL2412 | 810003470 | 22" | 24" |
| 4" | FSVL1204 | 810003143 | 10" | 12" | 12" | FSVL3612 | 810003471 | 34" | 36" |
| 4" | FSVL1804 | 810003144 | 16" | 18" | 14" | FSVL614 | 810003508 | 4" | 6" |
| 4" | FSVL2404 | 810003145 | 22" | 24" | 14" | FSVL1214 | 810003509 | 10" | 12" |
| 4" | FSVL3604 | 810003146 | 34" | 36" | 14" | FSVL1814 | 810003510 | 16" | 18" |
| 5" | FSVL605 | 810003200 | 4" | 6" | 14" | FSVL2414 | 810003511 | 22" | 24" |
| 5" | FSVL1205 | 810003201 | 10" | 12" | 14" | FSVL3614 | 810003512 | 34" | 36" |
| 5" | FSVL1805 | 810003202 | 16" | 18" | 16" | FSVL616 | 810003543 | 4" | 6" |
| 5" | FSVL2405 | 810003203 | 22" | 24" | 16" | FSVL1216 | 810003544 | 10" | 12" |
| 5" | FSVL3605 | 810003204 | 34" | 36" | 16" | FSVL1816 | 810003545 | 16" | 18" |
| 6" | FSVL606 | 810003255 | 4" | 6" | 16" | FSVL2416 | 810003546 | 22" | 24" |
| 6" | FSVL1206 | 810003256 | 10" | 12" | 16" | FSVL3616 | 810003547 | 34" | 36" |
| 6" | FSVL1806 | 810003257 | 16" | 18" | 18" | FSVL618 | 810003577 | 4" | 6" |
| 6" | FSVL2406 | 810003258 | 22" | 24" | 18" | FSVL1218 | 810003578 | 10" | 12" |
| 6" | FSVL3606 | 810003259 | 34" | 36" | 18" | FSVL1818 | 810003579 | 16" | 18" |
| 7" | FSVL607 | 810003301 | 4" | 6" | 18" | FSVL2418 | 810003580 | 22" | 24" |
| 7" | FSVL1207 | 810003302 | 10" | 12" | 18" | FSVL3618 | 810003581 | 34" | 36" |
| 7" | FSVL1807 | 810003303 | 16" | 18" | 20" | FSVL620 | 810003597 | 4" | 6" |
| 7" | FSVL2407 | 810003304 | 22" | 24" | 20" | FSVL1220 | 810003598 | 10" | 12" |
| 7" | FSVL3607 | 810003305 | 34" | 36" | 20" | FSVL1820 | 810003599 | 16" | 18" |
| 8" | FSVL608 | 810003343 | 4" | 6" | 20" | FSVL2420 | 810003600 | 22" | 24" |
| 8" | FSVL1208 | 810003344 | 10" | 12" | 20" | FSVL3620 | 810003601 | 34" | 36" |
| 8" | FSVL1808 | 810003345 | 16" | 18" | 22" | FSVL622 | 810003617 | 4" | 6" |
| 8" | FSVL2408 | 810003346 | 22" | 24" | 22" | FSVL1222 | 810003618 | 10" | 12" |
| 8" | FSVL3608 | 810003347 | 34" | 36" | 22" | FSVL1822 | 810003619 | 16" | 18" |
| 9" | FSVL609 | 810003388 | 4" | 6" | 22" | FSVL2422 | 810003620 | 22" | 24" |
| 9" | FSVL1209 | 810003389 | 10" | 12" | 22" | FSVL3622 | 810003621 | 34" | 36" |
| 9" | FSVL1809 | 810003390 | 16" | 18" | 24" | FSVL624 | 810003636 | 4" | 6" |
| 9" | FSVL2409 | 810003391 | 22" | 24" | 24" | FSVL1224 | 810003637 | 10" | 12" |
| 9" | FSVL3609 | 810003392 | 34" | 36" | 24" | FSVL1824 | 810003638 | 16" | 18" |
| 10" | FSVL610 | 810003426 | 4" | 6" | 24" | FSVL2424 | 810003639 | 22" | 24" |
| 10" | FSVL1210 | 810003427 | 10" | 12" | 24" | FSVL3624 | 810003640 | 34" | 36" |
| 10" | FSVL1810 | 810003428 | 16" | 18" | | | | | |

Adjustable Vent Length

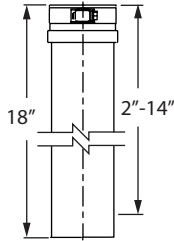

Use to add length to straight length of FasNSeal pipe. Adds 2"–14" of length. Requires at least 4" overlap for a secure connection.
Available in Custom Lengths.

| SIZE | ORDER # | STOCK # | SIZE | ORDER # | STOCK # |
|------|---------|-----------|------|---------|-----------|
| 3" | FSAVL3 | 810003097 | 12" | FSAVL12 | 810003472 |
| 4" | FSAVL4 | 810003148 | 14" | FSAVL14 | 810003513 |
| 5" | FSAVL5 | 810003205 | 16" | FSAVL16 | 810003548 |
| 6" | FSAVL6 | 810003260 | 18" | FSAVL18 | 810003582 |
| 7" | FSAVL7 | 810003306 | 20" | FSAVL20 | 810003602 |
| 8" | FSAVL8 | 810003348 | 22" | FSAVL22 | 810003622 |
| 9" | FSAVL9 | 810003393 | 24" | FSAVL24 | 810003641 |
| 10" | FSAVL10 | 810003431 | | | |

2° Adjustable Vent Length

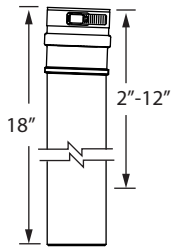

Use to facilitate for the 2° pitched required in horizontal runs.
Available in Custom Lengths.

| SIZE | ORDER # | STOCK # | SIZE | ORDER # | STOCK # |
|------|-----------|-----------|------|-----------|-----------|
| 3" | FSAVL03-2 | 810003099 | 9" | FSAVL09-2 | 810003395 |
| 4" | FSAVL04-2 | 810003150 | 10" | FSAVL10-2 | 810003433 |
| 5" | FSAVL05-2 | 810003207 | 12" | FSAVL12-2 | 810003474 |
| 6" | FSAVL06-2 | 810003262 | 14" | FSAVL14-2 | 810003515 |
| 7" | FSAVL07-2 | 810003308 | 16" | FSAVL16-2 | 810003550 |
| 8" | FSAVL08-2 | 810003350 | | | |

FasNSeal Flex



Use to vent Category II,III and IV gas burning appliances. Listed to UL 1738. Can only be used in vertical or near vertical runs. **Custom lengths are available for 3"-12" diameters.** Minimum length of 10' for custom orders. Maximum length of 50' for 3" - 9" diameter custom orders and 25' for 10" and 12" diameter custom orders. Must be ordered in 10' increments. Use with FasNSeal components only.

| SIZE | 20' | | 25' | | 30' | | 35' | |
|------|------------|-----------|-------------|-------------|-------------|-----------|-------------|-----------|
| | Order # | Stock # | Order # | Stock # | Order # | Stock # | Order # | Stock # |
| 3" | 3FSFLEX-20 | 810003100 | 3FSFLEX-25 | 810003101 | 3FSFLEX-30 | 810003102 | 3FSFLEX-35 | 810003103 |
| 4" | 4FSFLEX-20 | 810003151 | 4FSFLEX-25 | 810003152 | 4FSFLEX-30 | 810003153 | 4FSFLEX-35 | 810003154 |
| 5" | 5FSFLEX-20 | 810003208 | 5FSFLEX-25 | 810003209 | 5FSFLEX-30 | 810003210 | 5FSFLEX-35 | 810003211 |
| 6" | 6FSFLEX-20 | 810003263 | 6FSFLEX-25 | 810003264 | 6FSFLEX-30 | 810003265 | 6FSFLEX-35 | 810003266 |
| 7" | 7FSFLEX-20 | 810003309 | 7FSFLEX-25 | 810003310 | 7FSFLEX-30 | 810003311 | 7FSFLEX-35 | 810003312 |
| 8" | 8FSFLEX-20 | 810003351 | 8FSFLEX-25 | 810003352 | 8FSFLEX-30 | 810003353 | 8FSFLEX-35 | 810003354 |
| SIZE | 50' | | 100' | | 125' | | 200' | |
| | Order # | Stock # | Order # | Stock # | Order # | Stock # | Order # | Stock # |
| 3" | -- | -- | -- | -- | -- | -- | 3FSFLEX-200 | 810003104 |
| 4" | -- | -- | -- | -- | -- | -- | 4FSFLEX-200 | 810003155 |
| 5" | -- | -- | -- | -- | 5FSFLEX-125 | 810003212 | -- | -- |
| 6" | -- | -- | 6FSFLEX-100 | 810003267 | -- | -- | -- | -- |
| 8" | 8FSFLEX-50 | 810003355 | -- | -- | -- | -- | -- | -- |
| SIZE | CUSTOM | | SIZE | CUSTOM | | | | |
| | ORDER # | STOCK # | | ORDER # | STOCK # | | | |
| 3" | 3FSFLEX-XX | 810003105 | 8" | 8FSFLEX-XX | 810003356 | | | |
| 4" | 4FSFLEX-XX | 810003156 | 9" | 9FSFLEX-XX | 810003396 | | | |
| 5" | 5FSFLEX-XX | 810003213 | 10" | 10FSFLEX-XX | 810003434 | | | |
| 6" | 6FSFLEX-XX | 810003268 | 12" | 12FSFLEX-XX | 810003475 | | | |
| 7" | 7FSFLEX-XX | 810003314 | | | | | | |

Male Flex Adapter

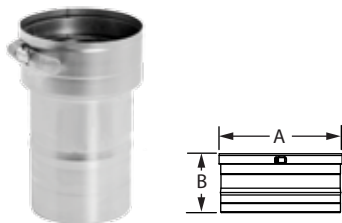

Use to connect FasNSeal rigid Vent Pipe to FasNSeal Flex at base of masonry chimney or bottom termination.

| SIZE | ORDER # | STOCK # | A | B | SIZE | ORDER # | STOCK # | A | B |
|------|----------|-----------|--------|--------|------|-----------|-----------|---------|---------|
| 3" | FSASMM-3 | 810003140 | 2 4/5" | 3 1/3" | 8" | FSASMM-8 | 810003386 | 7 4/5" | 8 1/3" |
| 4" | FSASMM-4 | 810003198 | 3 4/5" | 4 1/3" | 9" | FSASMM-9 | 810003424 | 8 4/5" | 9 1/3" |
| 5" | FSASMM-5 | 810003247 | 4 4/5" | 5 1/3" | 10" | FSASMM-10 | 810003465 | 9 4/5" | 10 1/3" |
| 6" | FSASMM-6 | 810003299 | 5 4/5" | 6 1/3" | 12" | FSASMM-12 | 810003506 | 11 4/5" | 12 1/3" |
| 7" | FSASMM-7 | 810003341 | 6 4/5" | 7 1/3" | | | | | |

Female Flex Adapter

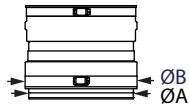

Use to connect FasNSeal Flex to FasNSeal rigid Vent Pipe at the top of the system.

| SIZE | ORDER # | STOCK # | A | B | SIZE | ORDER # | STOCK # | A | B |
|------|----------|-----------|--------|--------|------|-----------|-----------|---------|---------|
| 3" | FSASMF-3 | 810003141 | 2 4/5" | 3 1/5" | 8" | FSASMF-8 | 810003387 | 7 4/5" | 8 1/5" |
| 4" | FSASMF-4 | 810003199 | 3 4/5" | 4 1/5" | 9" | FSASMF-9 | 810003425 | 8 4/5" | 9 1/5" |
| 5" | FSASMF-5 | 810003248 | 4 4/5" | 5 1/5" | 10" | FSASMF-10 | 810003466 | 9 4/5" | 10 1/5" |
| 6" | FSASMF-6 | 810003300 | 5 4/5" | 6 1/5" | 12" | FSASMF-12 | 810003507 | 11 4/5" | 12 1/5" |
| 7" | FSASMF-7 | 810003342 | 6 4/5" | 7 1/5" | | | | | |

Test Port

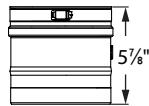

Use to test for proper appliance operation without penetrating the vent wall. Easy access to perform flue gas analysis. More options available, see Universal Adapter w/Test Port in FasNSeal Appliance Adapter section.

| SIZE | ORDER # | STOCK # | SIZE | ORDER # | STOCK # |
|------|---------|-----------|------|---------|-----------|
| 3" | FSTP03 | 810003135 | 9" | FSTP09 | 810003422 |
| 4" | FSTP04 | 810003196 | 10" | FSTP10 | 810003463 |
| 5" | FSTP05 | 810003245 | 12" | FSTP12 | 810003504 |
| 6" | FSTP06 | 810003297 | 14" | FSTP14 | 810003541 |
| 7" | FSTP07 | 810003339 | 16" | FSTP16 | 810003575 |
| 8" | FSTP08 | 810003384 | | | |

90° Elbow

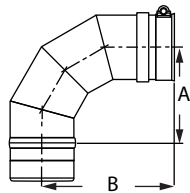

Use to go from horizontal to vertical runs or vertical to horizontal runs. Use to turn vent 90°.

| SIZE | ORDER # | STOCK # | A | B | SIZE | ORDER # | STOCK # | A | B |
|------|-----------|-----------|--------|--------|------|-----------|-----------|---------|---------|
| 3" | FSELB9003 | 810003106 | 4" | 6" | 12" | FSELB9012 | 810003476 | 8 1/2" | 10 1/4" |
| 4" | FSELB9004 | 810003157 | 4 1/2" | 6 1/4" | 14" | FSELB9014 | 810003516 | 9 1/2" | 11 3/8" |
| 5" | FSELB9005 | 810003214 | 5" | 6 3/4" | 16" | FSELB9016 | 810003551 | 11" | 12 1/2" |
| 6" | FSELB9006 | 810003269 | 5 1/2" | 7 1/2" | 18" | FSELB9018 | 810003583 | 11 1/2" | 13 1/8" |
| 7" | FSELB9007 | 810003315 | 6 1/8" | 7 7/8" | 20" | FSELB9020 | 810003603 | 12 1/2" | 14 1/2" |
| 8" | FSELB9008 | 810003357 | 6 1/2" | 8 1/4" | 22" | FSELB9022 | 810003623 | 13 3/8" | 15" |
| 9" | FSELB9009 | 810003397 | 7" | 9" | 24" | FSELB9024 | 810003642 | 14 1/2" | 16 1/8" |
| 10" | FSELB9010 | 810003435 | 7 1/2" | 9 3/8" | | | | | |

88° Elbow

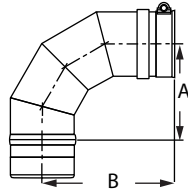

Use to transition from a vertical to a horizontal run. Stabilizes a 2° pitch towards the condensate drain for good condensate management.

| SIZE | ORDER # | STOCK # | A | B | SIZE | ORDER # | STOCK # | A | B |
|------|-----------|-----------|--------|--------|------|-----------|-----------|--------|---------|
| 3" | FSELB8803 | 810003107 | 4" | 6" | 9" | FSELB8809 | 810003398 | 7" | 9" |
| 4" | FSELB8804 | 810003158 | 4 1/2" | 6 1/4" | 10" | FSELB8810 | 810003436 | 7 1/2" | 9 3/8" |
| 5" | FSELB8805 | 810003215 | 5" | 6 3/4" | 12" | FSELB8812 | 810003477 | 8 1/2" | 10 1/4" |
| 6" | FSELB8806 | 810003270 | 5 1/2" | 7 1/2" | 14" | FSELB8814 | 810003517 | 9 1/2" | 11 3/8" |
| 7" | FSELB8807 | 810003316 | 6 1/8" | 7 7/8" | 16" | FSELB8816 | 810003552 | 11" | 12 1/2" |
| 8" | FSELB8808 | 810003358 | 6 1/2" | 8 1/4" | | | | | |

45° Elbow

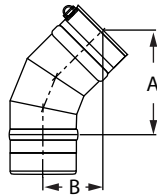

Offsets obstructions as needed. Allows for better condensate management and less back pressure.

| SIZE | ORDER # | STOCK # | A | B | SIZE | ORDER # | STOCK # | A | B |
|------|-----------|-----------|--------|--------|------|-----------|-----------|---------|--------|
| 3" | FSELB4503 | 810003108 | 5 3/8" | 3" | 12" | FSELB4512 | 810003478 | 8 1/2" | 4 1/4" |
| 4" | FSELB4504 | 810003159 | 5 5/8" | 3 1/8" | 14" | FSELB4514 | 810003518 | 9 1/4" | 4 5/8" |
| 5" | FSELB4505 | 810003216 | 6" | 3 1/4" | 16" | FSELB4516 | 810003553 | 10" | 4 7/8" |
| 6" | FSELB4506 | 810003271 | 6 3/8" | 3 3/8" | 18" | FSELB4518 | 810003585 | 10 1/8" | 5" |
| 7" | FSELB4507 | 810003317 | 6 3/4" | 3 1/2" | 20" | FSELB4520 | 810003605 | 10 7/8" | 5 1/4" |
| 8" | FSELB4508 | 810003359 | 7 1/8" | 3 5/8" | 22" | FSELB4522 | 810003625 | 11 5/8" | 5 5/8" |
| 9" | FSELB4509 | 810003399 | 7 1/2" | 3 7/8" | 24" | FSELB4524 | 810003644 | 12 3/8" | 5 7/8" |
| 10" | FSELB4510 | 810003437 | 7 7/8" | 4" | | | | | |

30° Elbow

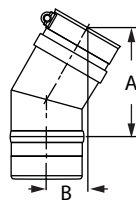

Offsets obstructions as needed. Allows for better condensate management and less back pressure.

| SIZE | ORDER # | STOCK # | A | B | SIZE | ORDER # | STOCK # | A | B |
|------|-----------|-----------|--------|--------|------|-----------|-----------|--------|--------|
| 3" | FSELB3003 | 810003109 | 4 7/8" | 1 7/8" | 9" | FSELB3009 | 810003400 | 7" | 2 1/2" |
| 4" | FSELB3004 | 810003160 | 5 1/8" | 1 7/8" | 10" | FSELB3010 | 810003438 | 6 1/2" | 2 1/4" |
| 5" | FSELB3005 | 810003217 | 5 1/4" | 2" | 12" | FSELB3012 | 810003479 | 7" | 2 1/2" |
| 6" | FSELB3006 | 810003272 | 5 1/2" | 2" | 14" | FSELB3014 | 810003519 | 7 1/2" | 2 1/2" |
| 7" | FSELB3007 | 810003318 | 5 7/8" | 2" | 16" | FSELB3016 | 810003554 | 8 1/8" | 2 3/4" |
| 8" | FSELB3008 | 810003360 | 6 1/8" | 2 1/8" | | | | | |

15° Elbow

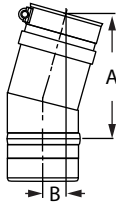

Offsets obstructions as needed. Allows for better condensate management and less back pressure.

| SIZE | ORDER # | STOCK # | A | B | SIZE | ORDER # | STOCK # | A | B |
|------|-----------|-----------|--------|------|------|-----------|-----------|--------|----|
| 3" | FSELB1503 | 810003110 | 4 3/8" | 7/8" | 9" | FSELB1509 | 810003401 | 5 1/4" | 1" |
| 4" | FSELB1504 | 810003161 | 4 1/2" | 1" | 10" | FSELB1510 | 810003439 | 5 1/4" | 1" |
| 5" | FSELB1505 | 810003218 | 4 5/8" | 7/8" | 12" | FSELB1512 | 810003480 | 5 1/2" | 1" |
| 6" | FSELB1506 | 810003273 | 4 3/4" | 7/8" | 14" | FSELB1514 | 810003520 | 5 3/4" | 1" |
| 7" | FSELB1507 | 810003319 | 4 7/8" | 1" | 16" | FSELB1516 | 810003555 | 6 1/8" | 1" |
| 8" | FSELB1508 | 810003361 | 5 1/8" | 1" | | | | | |

Wide Mouth Boot Tee

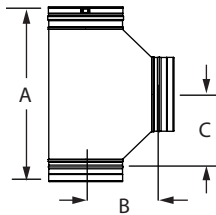

Use to transition from horizontal to vertical. Provides improved flue gas flow with angled gradual transitions. Can also be used as a manifold connection to gang boilers into a common vent.

| SIZE | ORDER # | STOCK # | A | B | C |
|------|---------|-----------|---------|--------|----------|
| 4" | FSWBT4 | 810003164 | 15 3/4" | 7" | 6 9/16" |
| 5" | FSWBT5 | 810003220 | 16 3/4" | 7 1/2" | 7 3/16" |
| 6" | FSWBT6 | 810003275 | 17 3/4" | 8" | 7 9/16" |
| 7" | FSWBT7 | 810003321 | 18 3/4" | 8 1/2" | 8 3/16" |
| 8" | FSWBT8 | 810003363 | 19 3/4" | 9" | 8 9/16" |
| 9" | FSWBT9 | 810003403 | 20 3/4" | 9 1/2" | 9 3/16" |
| 10" | FSWBT10 | 810003441 | 21 3/4" | 10" | 9 9/16" |
| 12" | FSWBT12 | 810003482 | 23 3/4" | 11" | 10 9/16" |
| 14" | FSWBT14 | 810003522 | 25 3/4" | 12" | 11 9/16" |
| 16" | FSWBT16 | 810003557 | 27 3/4" | 13" | 12 9/16" |
| 18" | FSWBT18 | 810003587 | 29 3/4" | 14" | 13 9/16" |
| 20" | FSWBT20 | 810003607 | 31 3/4" | 15" | 14 9/16" |
| 22" | FSWBT22 | 810003627 | 33 3/4" | 16" | 15 9/16" |
| 24" | FSWBT24 | 810003646 | 35 3/4" | 17" | 16 9/16" |

Standard Tee

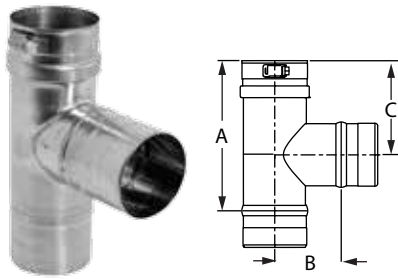

Use for a 90° offset, or to combine connections from two or more appliances into a common vent. Can also use as a condensate management point when used in conjunction with drain fitting. All Standard Tees are completely welded.

| SIZE | ORDER # | STOCK # | A | B | C | SIZE | ORDER # | STOCK # | A | B | C |
|------|---------|-----------|-----|--------|--------|------|---------|-----------|---------|--------|---------|
| 3" | FST3 | 810003111 | 7" | 3" | 4 1/2" | 12" | FST12 | 810003481 | 16" | 7" | 9" |
| 4" | FST4 | 810003162 | 8" | 3 1/2" | 5" | 14" | FST14 | 810003521 | 20" | 8 1/2" | 11" |
| 5" | FST5 | 810003219 | 10" | 4" | 6" | 16" | FST16 | 810003556 | 22" | 9 1/2" | 12" |
| 6" | FST6 | 810003274 | 10" | 4 1/2" | 6" | 18" | FST18 | 810003586 | 22 7/8" | 11" | 12 1/2" |
| 7" | FST7 | 810003320 | 12" | 5" | 7" | 20" | FST20 | 810003606 | 24 7/8" | 12" | 13 1/2" |
| 8" | FST8 | 810003362 | 14" | 5 1/2" | 8" | 22" | FST22 | 810003626 | 26 7/8" | 13" | 14 1/2" |
| 9" | FST9 | 810003402 | 14" | 6" | 8" | 24" | FST24 | 810003645 | 28 7/8" | 14" | 15 1/2" |
| 10" | FST10 | 810003440 | 14" | 6 1/2" | 8" | | | | | | |

Branch Tee

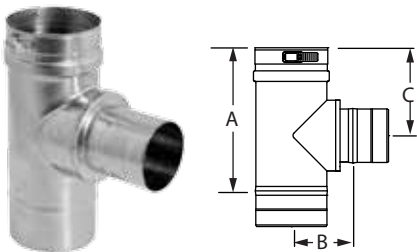

Use as a Tee increaser or as a manifold connection to gang boilers into a common vent. **Available in custom size combinations.**

| SIZE | ORDER # | STOCK # | A | B | C |
|--------------|----------|-----------|---------|--------|--------|
| 4" x 4" x 3" | FST04B03 | 810003112 | 8 1/10" | 3 1/2" | 5" |
| 5" x 5" x 3" | FST05B03 | 810003113 | 8 1/10" | 4" | 5 3/5" |
| 6" x 6" x 5" | FST06B05 | 810003222 | 10 1/5" | 4 1/2" | 5 3/4" |

Boot Tee

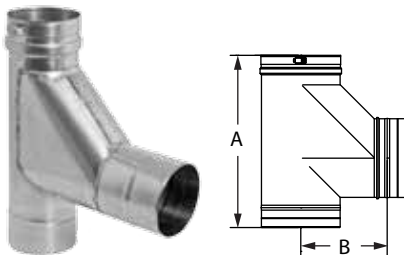

Use to transition from horizontal to vertical with improved flue gas flow.

| SIZE | ORDER # | STOCK # | A | B | SIZE | ORDER # | STOCK # | A | B |
|------|---------|-----------|---------|--------|------|---------|-----------|---------|---------|
| 4" | FSBT4 | 810003164 | 11 1/2" | 7 1/2" | 9" | FSBT9 | 810003404 | 16 1/2" | 10" |
| 5" | FSBT5 | 810003221 | 12 1/2" | 8" | 10" | FSBT10 | 810003442 | 17 1/2" | 10 1/2" |
| 6" | FSBT6 | 810003276 | 13 1/2" | 8 1/2" | 12" | FSBT12 | 810003483 | 19 1/2" | 11 1/2" |
| 7" | FSBT7 | 810003322 | 14 1/2" | 9" | 14" | FSBT14 | 810003523 | 21 1/2" | 12 1/2" |
| 8" | FSBT8 | 810003364 | 15 1/2" | 9 1/2" | 16" | FSBT16 | 810003558 | 23 1/2" | 13 1/2" |

Single-Wall Wye

***new sizes available**

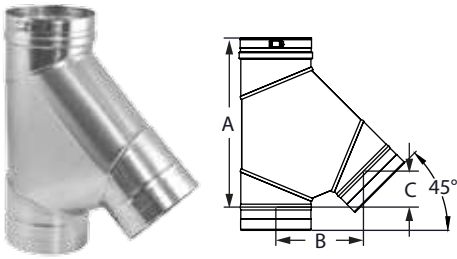

Use in place of any M&G DuraVent tee for a 45° angle instead of 90°; can be used as a manifold connection to gang multiple boilers into a common vent.

| SIZE | ORDER # | STOCK # | A | B | C |
|------|---------|-----------|----------|----------|----------|
| 6" | FSWYE06 | 810005506 | 14 1/2" | 7 1/2" | 3 1/10" |
| 7" | FSWYE07 | 810007017 | 16 1/3" | 8 3/5" | 3 1/2" |
| 8" | FSWYE08 | 810005507 | 18" | 9 7/10" | 4" |
| 9" | FSWYE09 | 810005508 | 19 7/10" | 10 7/10" | 4 2/5" |
| 10" | FSWYE10 | 810005509 | 21 2/5" | 11 4/5" | 4 9/10" |
| 12" | FSWYE12 | 810005510 | 24 9/10" | 14" | 5 4/5" |
| 14" | FSWYE14 | 810007018 | 28 3/10" | 16 1/10" | 6 3/5" |
| 16" | FSWYE16 | 810009330 | 31 4/5" | 18 1/5" | 7 1/2" |
| 18" | FSWYE18 | 810009331 | 35 1/5" | 20 2/5" | 8 2/5" |
| 20" | FSWYE20 | 810009332 | 38 3/5" | 22 1/2" | 9 3/10" |
| 22" | FSWYE22 | 810007548 | 42 1/10" | 24 7/10" | 10 1/5" |
| 24" | FSWYE24 | 810007129 | 45 1/2" | 26 4/5" | 11 1/10" |

Single-Wall Increaser Wye

***new part**



Use in place of any tee for a 45° angle instead of 90°. The branch has a smaller diameter, so it can be used to increase to a larger diameter as a manifold connection to gang multiple boilers into a common vent. Maximum diameter increase is 6". Available in custom size combinations.

| SIZE | ORDER # | STOCK # | A | B | C |
|-----------|-----------|-----------|---------|---------|--------|
| 6" x 8" | FSWYE0608 | 810012530 | 15 3/8" | 9 1/4" | 3 3/8" |
| 6" x 10" | FSWYE0610 | 810012531 | 16" | 10 5/8" | 3 5/8" |
| 6" x 12" | FSWYE0612 | 810012556 | 17 1/8" | 12 1/2" | 4" |
| 8" x 10" | FSWYE0810 | 810012532 | 18 3/4" | 11 3/8" | 4 3/8" |
| 8" x 12" | FSWYE0812 | 810012533 | 19 3/8" | 12 3/4" | 4 1/2" |
| 8" x 14" | FSWYE0814 | 810012557 | 20" | 14 1/4" | 4 5/8" |
| 10" x 12" | FSWYE1012 | 810010236 | 22 1/4" | 13 1/2" | 5 1/8" |
| 10" x 14" | FSWYE1014 | 810012534 | 22 7/8" | 15" | 5 3/8" |
| 10" x 16" | FSWYE1016 | 810010311 | 23 1/2" | 16 3/8" | 5 1/2" |
| 12" x 14" | FSWYE1214 | 810010055 | 25 5/8" | 15 3/8" | 6 1/8" |

Tee Cap

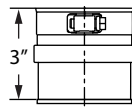

Use to cap Standard Tee, Branch Tee or Boot Tee. Remove Tee Cap to inspect the system; clean out debris or collected condensate.

| SIZE | ORDER # | STOCK # | SIZE | ORDER # | STOCK # |
|------|---------|-----------|------|---------|-----------|
| 3" | FSTC3 | 810003114 | 12" | FSTC12 | 810003484 |
| 4" | FSTC4 | 810003168 | 14" | FSTC14 | 810003524 |
| 5" | FSTC5 | 810003224 | 16" | FSTC16 | 810003559 |
| 6" | FSTC6 | 810003277 | 18" | FSTC18 | 810003588 |
| 7" | FSTC7 | 810003323 | 20" | FSTC20 | 810003608 |
| 8" | FSTC8 | 810003365 | 22" | FSTC22 | 810003628 |
| 9" | FSTC9 | 810003405 | 24" | FSTC24 | 810003647 |
| 10" | FSTC10 | 810003443 | | | |

Universal Condensate Drain

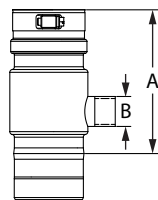

Use to properly manage corrosive condensates common with high efficiency gas appliances. For best results, install close to the appliance. Can be used horizontally, vertically, or any angle in between. The top photo shows the 3"-5" diameters with 5/8" straight tube; the bottom photo shows 6"-16" diameters with a 1" IPS Fitting.

| SIZE | ORDER # | STOCK # | A | B |
|------|---------|-----------|--------|--------|
| 3" | FSUCD3 | 810003115 | 6 2/5" | 5/8" |
| 4" | FSUCD4 | 810003169 | 6 2/5" | 5/8" |
| 5" | FSUCD5 | 810003225 | 6 2/5" | 5/8" |
| 6" | FSUCD6 | 810003278 | 6 2/5" | 1 1/4" |
| 7" | FSUCD7 | 810003324 | 6 2/5" | 1 1/4" |
| 8" | FSUCD8 | 810003366 | 6 2/5" | 1 1/4" |
| 9" | FSUCD9 | 810003406 | 6 2/5" | 1 1/4" |
| 10" | FSUCD10 | 810003444 | 6 2/5" | 1 1/4" |
| 12" | FSUCD12 | 810003485 | 6 2/5" | 1 1/4" |
| 14" | FSUCD14 | 810003525 | 6 2/5" | 1 1/4" |
| 16" | FSUCD16 | 810003560 | 6 2/5" | 1 1/4" |

Drain Fitting

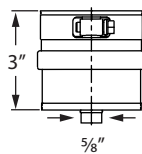

Use instead of Tee Cap to manage condensates at the bottom of a vertical run. For vent systems larger than 5", use an IPS Drain Fitting.

| SIZE | ORDER # | STOCK # |
|------|---------|-----------|
| 3" | FSDF3 | 810003116 |
| 4" | FSDF4 | 810003170 |
| 5" | FSDF5 | 810003226 |

IPS Drain Fitting

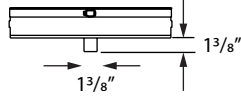

Use to connect iron drain pipe to flow acidic condensates to a neutralization tank before disposal. Uses 1" NPT thread.

| SIZE | ORDER # | STOCK # | SIZE | ORDER # | STOCK # |
|------|-----------|-----------|------|-----------|-----------|
| 3" | FSIPSDF03 | 810003117 | 12" | FSIPSDF12 | 810003486 |
| 4" | FSIPSDF04 | 810003171 | 14" | FSIPSDF14 | 810003526 |
| 5" | FSIPSDF05 | 810003227 | 16" | FSIPSDF16 | 810003561 |
| 6" | FSIPSDF06 | 810003279 | 18" | FSIPSDF18 | 810003589 |
| 7" | FSIPSDF07 | 810003325 | 20" | FSIPSDF20 | 810003609 |
| 8" | FSIPSDF08 | 810003367 | 22" | FSIPSDF22 | 810003629 |
| 9" | FSIPSDF09 | 810003407 | 24" | FSIPSDF24 | 810003648 |
| 10" | FSIPSDF10 | 810003445 | | | |

Horizontal Drain Fitting

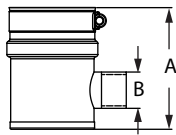

Use to manage condensates in horizontal runs. Optimal when ganging multiple appliances into a common vent. The top photo shows the 3"-5" diameters with 5/8" straight tube; the bottom photo shows 6"-16" diameters with a 1" IPS Fitting.

| SIZE | ORDER # | STOCK # | A | B |
|------|---------|-----------|--------|--------|
| 3" | FSHDF03 | 810003118 | 3 1/2" | 5/8" |
| 4" | FSHDF04 | 810003172 | 3 1/2" | 5/8" |
| 5" | FSHDF05 | 810003228 | 3 1/2" | 5/8" |
| 6" | FSHDF06 | 810003280 | 4 3/8" | 1 1/4" |
| 7" | FSHDF07 | 810003326 | 4 3/8" | 1 1/4" |
| 8" | FSHDF08 | 810003368 | 4 3/8" | 1 1/4" |
| 9" | FSHDF09 | 810003408 | 4 3/8" | 1 1/4" |
| 10" | FSHDF10 | 810003446 | 4 3/8" | 1 1/4" |
| 12" | FSHDF12 | 810003487 | 4 3/8" | 1 1/4" |
| 14" | FSHDF14 | 810003527 | 4 3/8" | 1 1/4" |
| 16" | FSHDF16 | 810003562 | 4 3/8" | 1 1/4" |

Horizontal Drip Tee

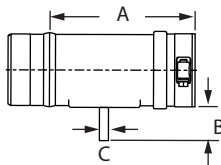

Use to manage condensate in horizontal runs.

| SIZE | ORDER # | STOCK # | A | B | C |
|------|---------|-----------|----|--------|------|
| 3" | FSHDT3 | 810003119 | 6" | 1 1/2" | 3/8" |
| 4" | FSHDT4 | 810003173 | 6" | 1 1/2" | 3/8" |

Bird Screen



Use for 3" and 4" standard through-the-wall terminations. Check installation instructions for restrictions on horizontal terminations, such as minimum distance from windows and doors.

| SIZE | ORDER # | STOCK # | A |
|------|---------|-----------|----|
| 3" | FSBS3 | 810003120 | 2" |
| 4" | FSBS4 | 810003174 | 2" |

23° Bird Screen

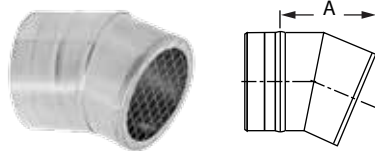

Use for 5" to 16" through-the-wall termination. Deters rain and other elements from entering the vent system. Check installation instructions for restrictions on horizontal terminations, such as minimum distance from windows and doors.

| SIZE | ORDER # | STOCK # | A |
|------|---------|-----------|----------|
| 5" | FSBS5 | 810003229 | 4 1/8" |
| 6" | FSBS6 | 810003281 | 5 3/8" |
| 7" | FSBS7 | 810003327 | 6 7/8" |
| 8" | FSBS8 | 810003369 | 7 1/10" |
| 9" | FSBS9 | 810003409 | 7 9/10" |
| 10" | FSBS10 | 810003447 | 8 7/10" |
| 12" | FSBS12 | 810003488 | 10 1/5" |
| 14" | FSBS14 | 810003528 | 11 7/10" |
| 16" | FSBS16 | 810003563 | 13 1/5" |

Termination Tee

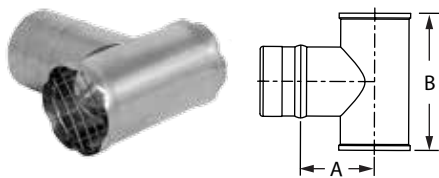

Use for standard and high-wind through-the-wall terminations. Check installation instructions for restrictions on horizontal terminations, such as minimum distance from windows and doors.

| SIZE | ORDER # | STOCK # | A | B |
|------|---------|-----------|--------|----|
| 3" | FSTT3 | 810003121 | 3" | 6" |
| 4" | FSTT4 | 810003175 | 3 1/2" | 7" |
| 5" | FSTT5 | 810003230 | 4" | 8" |
| 6" | FSTT6 | 810003282 | 4 1/2" | 9" |

Termination Box

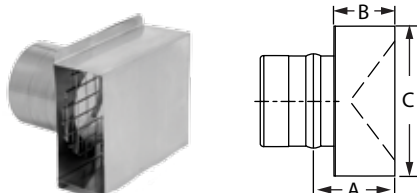

Use for horizontal through-the-wall terminations. Check installation instructions for restrictions on horizontal terminations, such as minimum distance from windows and doors. Larger sizes available, contact customer service.

| SIZE | ORDER # | STOCK # | A | B | C |
|------|---------|-----------|---------|----|----|
| 3" | FSTB3 | 810003122 | 2 3/10" | 2" | 5" |
| 4" | FSTB4 | 810003176 | 2 3/10" | 2" | 6" |

Wall Thimble w/ Termination Damper

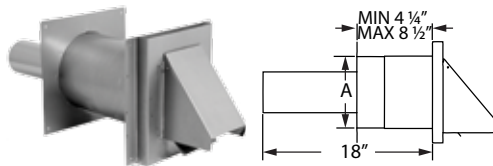

Use for horizontal through-the-wall terminations. Check installation instructions for restrictions on horizontal cap terminations, such as minimum distance from windows and doors. Accommodates wall thickness of 4 1/4" to 8 1/2". Damper prevents backdraft of cold air to appliance. Not a UL Listed component.

| SIZE | ORDER # | STOCK # | A |
|------|---------|-----------|----|
| 3" | FSWTT3 | 810003123 | 6" |
| 4" | FSWTT4 | 810003177 | 7" |
| 5" | FSWTT5 | 810005425 | 8" |

Wall Thimble w/ AVL

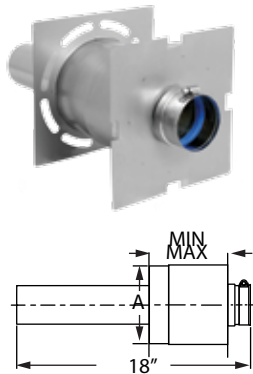

Use for through-the-wall termination. Fits between standard wall studs. 3"-5" diameters accommodates wall thickness of 4 1/4" to 8 1/2". 6"-16" diameters accommodate wall thickness of 5 3/4" to 11 1/2". AVL pipe allows for adjustability in length variance.

| SIZE | ORDER # | STOCK # | A |
|------|---------|-----------|-----|
| 3" | FSWT3 | 810003124 | 6" |
| 4" | FSWT4 | 810003178 | 7" |
| 5" | FSWT5 | 810003231 | 8" |
| 6" | FSWT6 | 810003284 | 9" |
| 7" | FSWT7 | 810003328 | 10" |
| 8" | FSWT8 | 810003371 | 11" |
| 9" | FSWT9 | 810003410 | 12" |
| 10" | FSWT10 | 810003448 | 13" |
| 12" | FSWT12 | 810003489 | 15" |
| 14" | FSWT14 | 810003529 | 17" |
| 16" | FSWT16 | 810003564 | 19" |

Wall Pass Through

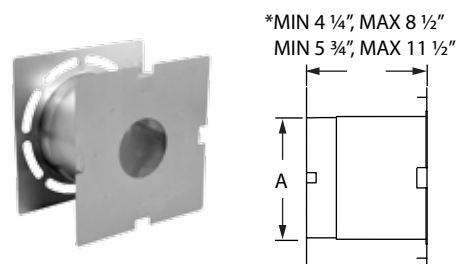

Use for through-the-wall termination. Fits between standard wall studs. 3"-5" diameters accommodates wall thickness of 4 1/4" to 8 1/2". 6"-16" diameters accommodate wall thickness of 5 3/4" to 11 1/2".

| SIZE | ORDER # | STOCK # | A | SIZE | ORDER # | STOCK # | A |
|------|---------|-----------|-----|------|---------|-----------|-----|
| 3" | FSWPT3 | 810003125 | 6" | 9" | FSWPT9 | 810003411 | 12" |
| 4" | FSWPT4 | 810003179 | 7" | 10" | FSWPT10 | 810003449 | 13" |
| 5" | FSWPT5 | 810003232 | 8" | 12" | FSWPT12 | 810003490 | 15" |
| 6" | FSWPT6 | 810003285 | 9" | 14" | FSWPT14 | 810003530 | 17" |
| 7" | FSWPT7 | 810003329 | 10" | 16" | FSWPT16 | 810003565 | 19" |
| 8" | FSWPT8 | 810003372 | 11" | | | | |

Wall Thimble Sleeve Extension

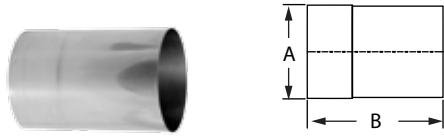

Use to add 6" of length to Wall Pass Through and Wall Thimble for thicker walls.

| SIZE | ORDER # | STOCK # | A |
|------|---------|-----------|-----|
| 3" | FSWTE3 | 810003126 | 6" |
| 4" | FSWTE4 | 810003180 | 7" |
| 5" | FSWTE5 | 810003233 | 8" |
| 6" | FSWTE6 | 810003286 | 9" |
| 7" | FSWTE7 | 810003330 | 10" |
| 8" | FSWTE8 | 810003373 | 11" |
| 9" | FSWTE9 | 810003412 | 12" |
| 10" | FSWTE10 | 810003450 | 13" |
| 12" | FSWTE12 | 810003491 | 15" |
| 14" | FSWTE14 | 810003531 | 17" |
| 16" | FSWTE16 | 810003566 | 19" |

Firestop/Flat Flashing

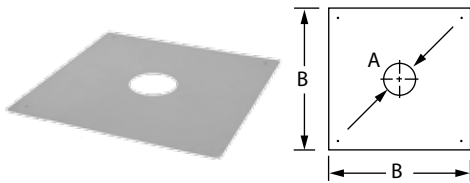

Use when penetrating floor levels.

| SIZE | ORDER # | STOCK # | A | B | SIZE | ORDER # | STOCK # | A | B |
|------|---------|-----------|---------|-----|------|---------|-----------|---------|-----|
| 3" | FSFS3 | 810003127 | 3 3/8" | 15" | 12" | FSFS12 | 810003492 | 12 3/8" | 24" |
| 4" | FSFS4 | 810003181 | 4 3/8" | 15" | 14" | FSFS14 | 810003532 | 14 3/8" | 26" |
| 5" | FSFS5 | 810003234 | 5 3/8" | 17" | 16" | FSFS16 | 810003567 | 16 3/8" | 28" |
| 6" | FSFS6 | 810003287 | 6 3/8" | 17" | 18" | FSFS18 | 810003591 | 18 3/8" | 30" |
| 7" | FSFS7 | 810003331 | 7 3/8" | 19" | 20" | FSFS20 | 810003611 | 20 3/8" | 32" |
| 8" | FSFS8 | 810003374 | 8 3/8" | 19" | 22" | FSFS22 | 810003631 | 22 3/8" | 34" |
| 9" | FSFS9 | 810003413 | 9 3/8" | 22" | 24" | FSFS24 | 810003650 | 24 3/8" | 36" |
| 10" | FSFS10 | 810003451 | 10 3/8" | 22" | | | | | |

Support Clamp

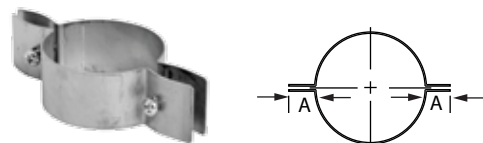

Use to support vertical and horizontal runs using threaded rod. Recommended every 10' on vertical runs and every 6' in horizontals. Use additional Support Clamps as needed.

| SIZE | ORDER # | STOCK # | A | SIZE | ORDER # | STOCK # | A |
|------|---------|-----------|--------|------|---------|-----------|--------|
| 3" | FSCL3 | 810003128 | 1 1/2" | 12" | FSCL12 | 810003493 | 1 1/2" |
| 4" | FSCL4 | 810003182 | 1 1/2" | 14" | FSCL14 | 810003533 | 1 1/2" |
| 5" | FSCL5 | 810003288 | 1 1/2" | 16" | FSCL16 | 810003568 | 1 1/2" |
| 6" | FSCL6 | 810003288 | 1 1/2" | 18" | FSCL18 | 810003592 | 1 1/2" |
| 7" | FSCL7 | 810003332 | 1 1/2" | 20" | FSCL20 | 810003612 | 1 1/2" |
| 8" | FSCL8 | 810003375 | 1 1/2" | 22" | FSCL22 | 810003632 | 1 1/2" |
| 9" | FSCL9 | 810003414 | 1 1/2" | 24" | FSCL24 | 810003651 | 1 1/2" |
| 10" | FSCL10 | 810003452 | 1 1/2" | | | | |

Wall Bracket

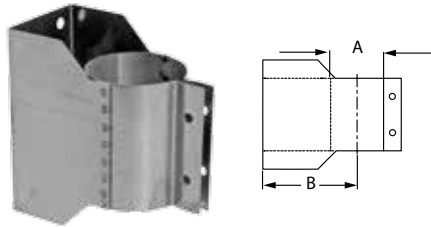

Use to support vent pipe or tee sections. Provides proper clearance to combustibles.

| SIZE | ORDER # | STOCK # | A | B | SIZE | ORDER # | STOCK # | A | B |
|------|---------|-----------|----|--------|------|---------|-----------|-----|--------|
| 3" | FSWB3 | 810003129 | 3" | 3 1/2" | 9" | FSWB9 | 810003415 | 9" | 6 1/2" |
| 4" | FSWB4 | 810003183 | 4" | 4" | 10" | FSWB10 | 810003453 | 10" | 7" |
| 5" | FSWB5 | 810003236 | 5" | 4 1/2" | 12" | FSWB12 | 810003494 | 12" | 8" |
| 6" | FSWB6 | 810003289 | 6" | 5" | 14" | FSWB14 | 810003534 | 14" | 9" |
| 7" | FSWB7 | 810003333 | 7" | 5 1/2" | 16" | FSWB16 | 810003569 | 16" | 10" |
| 8" | FSWB8 | 810003376 | 8" | 6" | | | | | |

Adjustable Wall Bracket

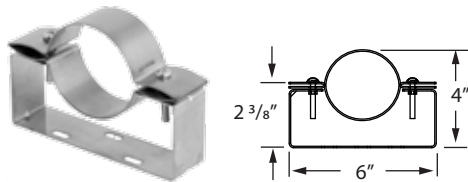

Use to support vent pipe in lateral and horizontal runs. Assist in achieving proper pitch for condensate management. Adjusts up to 3".

| SIZE | ORDER # | STOCK # |
|------|---------|-----------|
| 3" | FSAWB03 | 810003130 |
| 4" | FSAWB04 | 810003184 |

Rain Cap

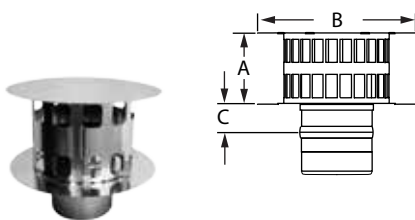

Use to terminate above the roof line. When terminating above 12" vent diameter use a Termination Cone.

| SIZE | ORDER # | STOCK # | A | B | C |
|------|---------|-----------|--------|----------|----|
| 3" | FSRC3 | 810003131 | 3 1/2" | 6 4/5" | 1" |
| 4" | FSRC4 | 810003185 | 4 1/2" | 8 9/10" | 1" |
| 5" | FSRC5 | 810003237 | 5 4/5" | 11 3/10" | 1" |
| 6" | FSRC6 | 810003292 | 6 4/5" | 13 1/2" | 1" |
| 7" | FSRC7 | 810003334 | 7 4/5" | 15 4/5" | 1" |
| 8" | FSRC8 | 810003377 | 8 4/5" | 18" | 1" |
| 9" | FSRC9 | 810003416 | 10" | 20 3/10" | 1" |
| 10" | FSRC10 | 810003454 | 11" | 22 1/2" | 1" |
| 12" | FSRC12 | 810003495 | 13" | 27" | 1" |

Severe Weather Rain Cap

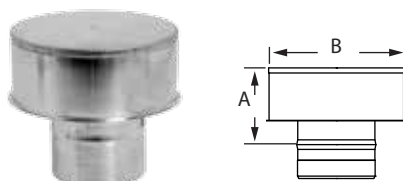

Use where high winds and horizontal rain are present. For vertical termination only.

| SIZE | ORDER # | STOCK # | A | B |
|------|----------|-----------|----|---------|
| 4" | FSSWRC04 | 810003186 | 6" | 7 1/10" |

Termination Cone

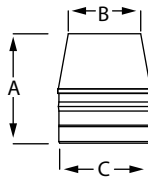

Use for vertical termination. Creates static back pressure to adjust harmonics. Venturi effect increases velocity of flue gases. Reduced opening provides for a smaller cross section to deter rain from entering the system. **Available in custom size combinations.**

| SIZE | ORDER # | STOCK # | A | B | C |
|-----------|----------|-----------|--------|-----|-----|
| 5" x 4" | FSCN0504 | 810003244 | 6 7/8" | 4" | 5" |
| 12" x 10" | FSCN1210 | 810003496 | 6 7/8" | 10" | 12" |
| 14" x 12" | FSCN1412 | 810003535 | 6 7/8" | 12" | 14" |
| 16" x 14" | FSCN1614 | 810003570 | 6 7/8" | 14" | 16" |
| 18" x 16" | FSCN1816 | 810003590 | 6 7/8" | 16" | 18" |
| 20" x 18" | FSCN2018 | 810003610 | 6 7/8" | 18" | 20" |
| 22" x 20" | FSCN2220 | 810003630 | 6 7/8" | 20" | 22" |
| 24" x 22" | FSCN2422 | 810003649 | 6 7/8" | 22" | 24" |

Storm Collar

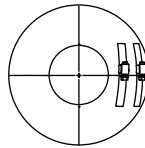

Use to create a weather tight seal between the pipe and flashing.

| SIZE | ORDER # | STOCK # | SIZE | ORDER # | STOCK # |
|------|---------|-----------|------|---------|-----------|
| 3" | FSC3 | 810003132 | 12" | FSC12 | 810003501 |
| 4" | FSC4 | 810003188 | 14" | FSC14 | 810003538 |
| 5" | FSC5 | 810003239 | 16" | FSC16 | 810003572 |
| 6" | FSC6 | 810003293 | 18" | FSC18 | 810003594 |
| 7" | FSC7 | 810003336 | 20" | FSC20 | 810003614 |
| 8" | FSC8 | 810003381 | 22" | FSC22 | 810003634 |
| 9" | FSC9 | 810003419 | 24" | FSC24 | 810003653 |
| 10" | FSC10 | 810003460 | | | |

Roof Jack

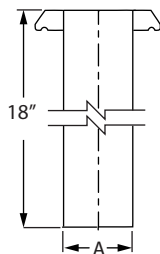

Use as a heat shield within the flashing. Maintains center-line and clearance to combustibles.

| SIZE | ORDER # | STOCK # | A | SIZE | ORDER # | STOCK # | A |
|------|---------|-----------|-----|------|---------|-----------|-----|
| 3" | FSVRJ3 | 810003133 | 4" | 12" | FSVRJ12 | 810003502 | 13" |
| 4" | FSVRJ4 | 810003189 | 5" | 14" | FSVRJ14 | 810003539 | 15" |
| 5" | FSVRJ5 | 810003240 | 6" | 16" | FSVRJ16 | 810003573 | 17" |
| 6" | FSVRJ6 | 810003294 | 7" | 18" | FSVRJ18 | 810003595 | 19" |
| 7" | FSVRJ7 | 810003337 | 8" | 20" | FSVRJ20 | 810003615 | 21" |
| 8" | FSVRJ8 | 810003382 | 9" | 22" | FSVRJ22 | 810005454 | 23" |
| 9" | FSVRJ9 | 810003420 | 10" | 24" | FSVRJ24 | 810003654 | 25" |
| 10" | FSVRJ10 | 810003461 | 11" | | | | |

Variable Pitch Roof Flashing

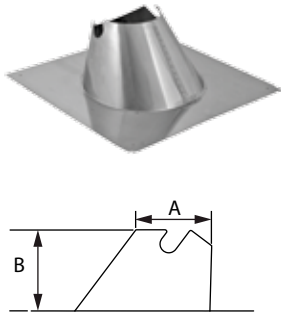

Use to create a weather-tight penetration where the vent pipe passes through the roof. Roof Jack and Storm Collar required. 3"-24"Ø accommodates flat to 9/12 roof pitch.

| SIZE | ORDER # | STOCK # | A | B | SIZE | ORDER # | STOCK # | A | B |
|------|---------|-----------|-----|----|------|---------|-----------|-----|---------|
| 3" | FSVPF3 | 810003134 | 5" | 7" | 12" | FSVPF12 | 810003503 | 14" | 7" |
| 4" | FSVPF4 | 810003190 | 6" | 7" | 14" | FSVPF14 | 810003540 | 16" | 7" |
| 5" | FSVPF5 | 810003241 | 7" | 7" | 16" | FSVPF16 | 810003574 | 18" | 7" |
| 6" | FSVPF6 | 810003295 | 8" | 7" | 18" | FSVPF18 | 810003596 | 20" | 28 1/2" |
| 7" | FSVPF7 | 810003338 | 9" | 7" | 20" | FSVPF20 | 810003616 | 22" | 29 1/2" |
| 8" | FSVPF8 | 810003383 | 10" | 7" | 22" | FSVPF22 | 810003635 | 24" | 30 1/2" |
| 9" | FSVPF9 | 810003421 | 11" | 7" | 24" | FSVPF24 | 810003655 | 26" | 31 1/2" |
| 10" | FSVPF10 | 810003462 | 12" | 7" | | | | | |

Tall Cone Roof Jack

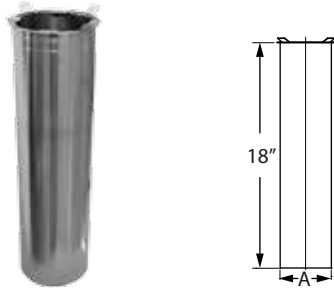

Use as a heat shield within the flashing. Maintains center-line and clearance to combustibles. Use with Tall Cone Flashings.

| SIZE | ORDER # | STOCK # | A | SIZE | ORDER # | STOCK # | A |
|------|---------|-----------|----|------|---------|-----------|-----|
| 3" | FSRJ3 | 810005286 | 4" | 9" | FSRJ9 | 810005290 | 10" |
| 4" | FSRJ4 | 810005287 | 5" | 10" | FSRJ10 | 810005291 | 11" |
| 5" | FSRJ5 | 810005288 | 6" | 12" | FSRJ12 | 810005292 | 13" |
| 6" | FSRJ6 | 810005289 | 7" | 14" | FSRJ14 | 810005293 | 15" |
| 7" | FSRJ7 | 810007023 | 8" | 16" | FSRJ16 | 810005294 | 17" |
| 8" | FSRJ8 | 810005434 | 9" | | | | |

Tall Cone Flashing

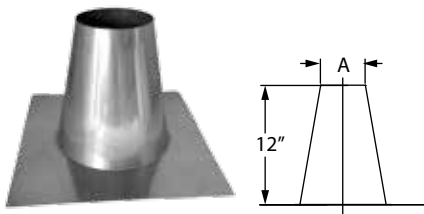

Use to create a weather-tight penetration where the vent passes through a flat roof. Roof Jack and Storm Collar required.

| SIZE | ORDER # | STOCK # | A | SIZE | ORDER # | STOCK # | A |
|------|---------|-----------|--------|------|---------|-----------|---------|
| 3" | FSAF3 | 810005257 | 4 1/3" | 9" | FSAF9 | 810005263 | 10 1/3" |
| 4" | FSAF4 | 810005258 | 5 1/3" | 10" | FSAF10 | 810005264 | 11 1/3" |
| 5" | FSAF5 | 810005259 | 6 1/3" | 12" | FSAF12 | 810005269 | 13 1/3" |
| 6" | FSAF6 | 810005260 | 7 1/3" | 14" | FSAF14 | 810005270 | 15 1/3" |
| 7" | FSAF7 | 810005261 | 8 1/3" | 16" | FSAF16 | 810005271 | 17 1/3" |
| 8" | FSAF8 | 810005262 | 9 1/3" | | | | |

Tapered Increaser



Use to increase vent diameter. Creates a smooth transition for an undistruptive flow. **Available in custom size combinations.**

| SIZE | ORDER # | STOCK # | A | B | C |
|---------|----------|-----------|----|----|--------------------|
| 3" x 4" | FS0304TI | 810003136 | 3" | 4" | 6 $\frac{9}{10}$ " |
| 4" x 5" | FS0405TI | 810003191 | 4" | 5" | 6 $\frac{9}{10}$ " |

Eccentric Increaser

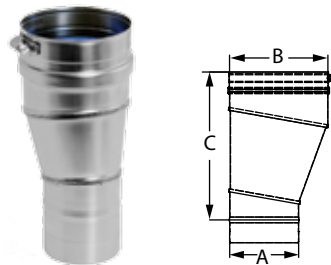

Use to transition to a larger diameter pipe. Prevents condensate puddling when used on horizontal runs. Aids in reducing formation of condensates. Maximum 10" difference between diameter increase size on both sizes. **Available in custom size combinations.**

| SIZE | ORDER # | STOCK # | A | B | C |
|---------|----------|-----------|----|----|--------------------|
| 3" x 4" | FS0304EI | 810003137 | 6" | 8" | 10 $\frac{3}{8}$ " |
| 4" x 5" | FS0405EI | 810003193 | 4" | 5" | 7 $\frac{3}{25}$ " |

Stepped Increaser

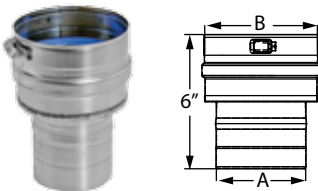

Use to increase vent diameter when space constraints are an issue. **Available in custom size combinations.**

| SIZE | ORDER # | STOCK # | A | B |
|---------|---------|-----------|----|----|
| 3" x 4" | FS34I | 810003138 | 3" | 4" |
| 4" x 5" | FS45I | 810003195 | 4" | 5" |

Tapered Reducer

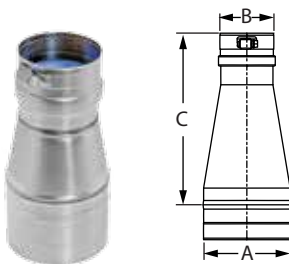

Use to reduce vent diameter. Creates a smooth transition for an undistruptive flow. Maximum 10" diameter increase size on both sizes. **Available in custom size combinations.**

| SIZE | ORDER # | STOCK # | A | B | C |
|---------|----------|-----------|----|----|--------------------|
| 4" x 3" | FS0403TR | 810003192 | 4" | 3" | 6 $\frac{9}{10}$ " |
| 5" x 4" | FS0504TR | 810003242 | 5" | 4" | 6 $\frac{9}{10}$ " |

Stepped Reducer

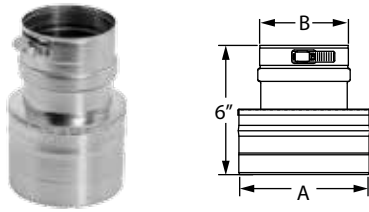

Use to reduce vent diameter when space constraints are an issue. Available in custom size combinations.

| SIZE | ORDER # | STOCK # | A | B |
|---------|---------|-----------|----|----|
| 4" x 3" | FS43R | 810003194 | 4" | 3" |
| 5" x 4" | FS54R | 810003243 | 5" | 4" |

Double-Wall Adapter

***updated description**

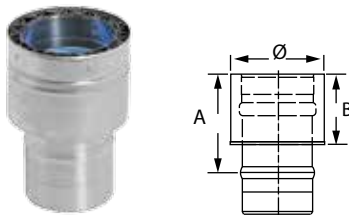

Use to transition from a single-wall pipe to double-wall pipe. To transition from double-wall to single-wall, please reference single-wall adapter available in double-wall FasNSeal section.

| SIZE | ORDER # | STOCK # | A | B | SIZE | ORDER # | STOCK # | A | B |
|------|------------|-----------|----|----|------|------------|-----------|----|----|
| 3" | FSA-SWDW3 | 810003139 | 4" | 3" | 12" | FSA-SWDW12 | 810003505 | 4" | 3" |
| 4" | FSA-SWDW4 | 810003197 | 4" | 3" | 14" | FSA-SWDW14 | 810003542 | 4" | 3" |
| 5" | FSA-SWDW5 | 810003246 | 4" | 3" | 16" | FSA-SWDW16 | 810003576 | 4" | 3" |
| 6" | FSA-SWDW6 | 810003298 | 4" | 3" | 18" | FSA-SWDW18 | 810003593 | 4" | 3" |
| 7" | FSA-SWDW7 | 810003340 | 4" | 3" | 20" | FSA-SWDW20 | 810003613 | 4" | 3" |
| 8" | FSA-SWDW8 | 810003385 | 4" | 3" | 22" | FSA-SWDW22 | 810003633 | 4" | 3" |
| 9" | FSA-SWDW9 | 810003423 | 4" | 3" | 24" | FSA-SWDW24 | 810003652 | 4" | 3" |
| 10" | FSA-SWDW10 | 810003464 | 4" | 3" | | | | | |

Standard Wall Mount Kit



Kit includes: Wall Thimble w/ Termination, Adjustable 90° Elbow, and Universal Appliance Adapter.

Use to vent wall mounted boilers or tankless water heaters. Terminates through-the-wall only. Available in 3", 4" and 5" vent diameters. Adjust vertically from 16 1/2" to 21" and horizontally from 8" to 12 1/2". 3"& 4" compatible with most gas-burning appliances. 5" compatible with tankless. Not a UL Listed component.

| SIZE | ORDER # | STOCK # |
|------|---------|-----------|
| 3" | FSWMKB3 | 810003070 |
| 4" | FSWMK4 | 810003071 |
| 5" | FSWMK5 | 810003072 |

Severe Weather Kit



Kit includes: Wall Thimble w/ Termination Tee, Adjustable 90° Elbow, and Universal Appliance Adapter w/Condensate Drain and Back Draft Preventer.

Use to vent wall mounted boilers or tankless water heaters. Use in areas of extreme wet and cold weather. Designed to prevent appliance freeze-up while maintaining an obstruction free exhaust. Available in 4" vent diameters, compatible with most 4" exhaust gas appliances. Add a 90° Elbow and Vent Length on the outside of the house to clear high snow lines.

| SIZE | ORDER # | STOCK # |
|------|----------|-----------|
| 4" | FSSWWMK4 | 810003075 |

Variable Pitch Flashing Kit



Kit includes: Rain Cap, Storm Collar, Roof Jack, and Roof Flashing. (*VPKA Kit includes: a Universal Appliance Adapter w/ Condensate Drain).

Use to terminate through-the-roof vent systems. Kit accommodates flat to 9/12 roof pitch.

| SIZE | ORDER # | STOCK # | SIZE | ORDER # | STOCK # |
|------|----------|-----------|------|---------|-----------|
| 3" | FSVPK3 | 810003056 | 9" | FSVPK9 | 810003062 |
| 4" | FSVPK4 | 810003057 | 10" | FSVPK10 | 810003063 |
| 4" | FSVPKA4* | 810003067 | 12" | FSVPK12 | 810003064 |
| 5" | FSVPK5 | 810003058 | 14" | FSVPK14 | 810003065 |
| 6" | FSVPK6 | 810003059 | 16" | FSVPK16 | 810003066 |
| 7" | FSVPK7 | 810003060 | | | |
| 8" | FSVPK8 | 810003061 | | | |

90° Bird Screen Wall Mount Kit



Kit includes: 90° Bird Screen Termination, Wall Thimble, Adjustable 90° Elbow, and Universal Appliance Adapter.

Use to vent wall mounted boilers or tankless water heaters. 3" kit adjusts vertically from 14 1/2" to 19" and horizontally from 9" to 13 1/2". 4" kit adjusts vertically from 14" to 18 1/2" and horizontally from 9" to 13 1/2". Compatible with all Rheem gas appliances. 3" kit requires a FSA-RI-4.2 Adapter.

| SIZE | ORDER # | STOCK # |
|------|----------|-----------|
| 3" | FSWMKEB3 | 810003073 |
| 4" | FSWMKE4 | 810003074 |

Ceiling Mounted Heater Vent Kit

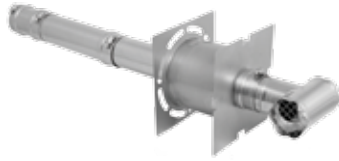

Kit includes Termination Tee, Wall Thimble w/Adjustable Vent Length, (2) 12" Vent Lengths, and Universal Appliance Adapter. *4" kit includes Universal Appliance Adapter with Condensate Drain.

Use to vent ceiling mounted heaters, through-the-wall termination only. Compatible with Modine ceiling heaters.

| SIZE | ORDER # | STOCK # |
|------|---------|-----------|
| 3" | FSCMK3 | 810003068 |
| 4" | FSCMK04 | 810003069 |

Universal Concentric Kit

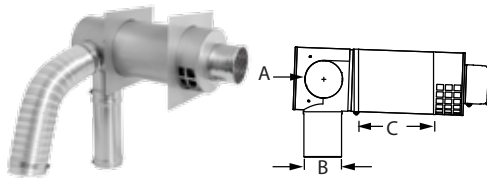

Use for through-the-wall termination with direct vent wall mounted gas appliances. an adjustable right and left hand air intake snout and accommodates wall thickness of 10" - 18". Check installation instructions for restrictions on horizontal termination, such as minimum distance from windows and doors.

| SIZE | ORDER # | STOCK # | A | B | C |
|------|-------------|-----------|----|----|-----------|
| 4" | FSEDVWMT04U | 810003081 | 4" | 4" | 10" - 18" |
| 5" | FSEDVWMT05U | 810003084 | 5" | 5" | 10" - 18" |

Wall Mount Concentric Kit

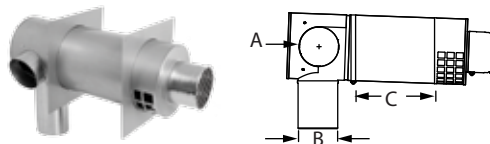

Use for through-the-wall termination with direct vent wall mounted gas appliances. Features a fixed right or left hand air intake snout and accommodates a maximum of 8" wall thickness. Check installation instructions for restrictions on horizontal termination, such as minimum distance from windows and doors.

| SIZE | ORDER # | STOCK # | A | B | C |
|------|--------------|-----------|----|----|---------|
| 4" | FDVWMT0403RH | 810003077 | 4" | 3" | 8" max. |
| 4" | FDVWMT0403LH | 810003078 | 4" | 3" | 8" max. |
| 4" | FDVWMT04RH | 810003079 | 4" | 4" | 8" max. |
| 4" | FSEDVWMT04LH | 810003080 | 4" | 4" | 8" max. |

Remote Concentric Kit

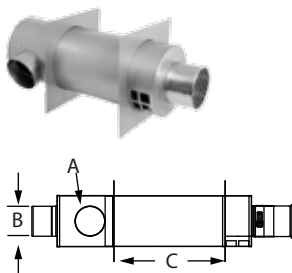

Use for through-the-wall termination with direct vent gas appliances located away from the wall. Check installation instructions for restrictions on horizontal termination, such as minimum distance from windows and doors.

| SIZE | ORDER # | STOCK # | A | B | C |
|------|-----------|-----------|----|----|----------|
| 3" | FDVMT03 | 810003085 | 3" | 3" | 11" max. |
| 4" | FDVWT04 | 810003083 | 4" | 4" | 11" max. |
| 4" | FDVWT0403 | 810003082 | 3" | 4" | 11" max. |

FasNSeal W2® - Double-Wall

Vent Length

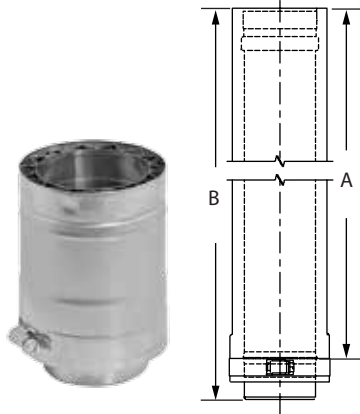

Used for venting special gas burning Categories II, III and IV appliances. To calculate O.D. add 1" to vent diameter.

| SIZE | ORDER # | STOCK # | A | B | SIZE | ORDER # | STOCK # | A | B |
|------|---------|-----------|-----|-----|------|---------|-----------|-----|-----|
| 3" | W2-603 | 810003656 | 4" | 6" | 10" | W2-2410 | 810003806 | 22" | 24" |
| 3" | W2-1203 | 810003657 | 10" | 12" | 10" | W2-3610 | 810003807 | 34" | 36" |
| 3" | W2-1803 | 810003658 | 16" | 18" | 12" | W2-612 | 810003828 | 4" | 6" |
| 3" | W2-2403 | 810003659 | 22" | 24" | 12" | W2-1212 | 810003829 | 10" | 12" |
| 3" | W2-3603 | 810003660 | 34" | 36" | 12" | W2-1812 | 810003830 | 16" | 18" |
| 4" | W2-604 | 810003677 | 4" | 6" | 12" | W2-2412 | 810003831 | 22" | 24" |
| 4" | W2-1204 | 810003678 | 10" | 12" | 12" | W2-3612 | 810003832 | 34" | 36" |
| 4" | W2-1804 | 810003679 | 16" | 18" | 14" | W2-614 | 810003853 | 4" | 6" |
| 4" | W2-2404 | 810003680 | 22" | 24" | 14" | W2-1214 | 810003854 | 10" | 12" |
| 4" | W2-3604 | 810003681 | 34" | 36" | 14" | W2-1814 | 810003855 | 16" | 18" |
| 5" | W2-605 | 810003698 | 4" | 6" | 14" | W2-2414 | 810003856 | 22" | 24" |
| 5" | W2-1205 | 810003699 | 10" | 12" | 14" | W2-3614 | 810003857 | 34" | 36" |
| 5" | W2-1805 | 810003700 | 16" | 18" | 16" | W2-616 | 810003876 | 4" | 6" |
| 5" | W2-2405 | 810003701 | 22" | 24" | 16" | W2-1216 | 810003877 | 10" | 12" |
| 5" | W2-3605 | 810003702 | 3" | 36" | 16" | W2-1816 | 810003878 | 16" | 18" |
| 6" | W2-606 | 810003719 | 4" | 6" | 16" | W2-2416 | 810003879 | 22" | 24" |
| 6" | W2-1206 | 810003720 | 10" | 12" | 16" | W2-3616 | 810003880 | 34" | 36" |
| 6" | W2-1806 | 810003721 | 16" | 18" | 18" | W2-618 | 810003899 | 4" | 6" |
| 6" | W2-2406 | 810003722 | 22" | 24" | 18" | W2-1218 | 810003900 | 10" | 12" |
| 6" | W2-3606 | 810003723 | 34" | 36" | 18" | W2-1818 | 810003901 | 16" | 18" |
| 7" | W2-607 | 810003740 | 4" | 6" | 18" | W2-2418 | 810003902 | 22" | 24" |
| 7" | W2-1207 | 810003741 | 10" | 12" | 18" | W2-3618 | 810003903 | 34" | 36" |
| 7" | W2-1807 | 810003742 | 16" | 18" | 20" | W2-620 | 810003916 | 4" | 6" |
| 7" | W2-2407 | 810003743 | 22" | 24" | 20" | W2-1220 | 810003917 | 10" | 12" |
| 7" | W2-3607 | 810003744 | 34" | 36" | 20" | W2-1820 | 810003918 | 16" | 18" |
| 8" | W2-608 | 810003760 | 4" | 6" | 20" | W2-2420 | 810003919 | 22" | 24" |
| 8" | W2-1208 | 810003761 | 10" | 12" | 20" | W2-3620 | 810003920 | 34" | 36" |
| 8" | W2-1808 | 810003762 | 16" | 18" | 22" | W2-622 | 810003933 | 4" | 6" |
| 8" | W2-2408 | 810003763 | 22" | 24" | 22" | W2-1222 | 810003934 | 10" | 12" |
| 8" | W2-3608 | 810003764 | 34" | 36" | 22" | W2-1822 | 810003935 | 16" | 18" |
| 9" | W2-609 | 810003783 | 4" | 6" | 22" | W2-2422 | 810003936 | 20" | 24" |
| 9" | W2-1209 | 810003784 | 10" | 12" | 22" | W2-3622 | 810003937 | 34" | 36" |
| 9" | W2-1809 | 810003785 | 16" | 18" | 24" | W2-624 | 810003949 | 4" | 6" |
| 9" | W2-2409 | 810003786 | 22" | 24" | 24" | W2-1224 | 810003950 | 10" | 12" |
| 9" | W2-3609 | 810003787 | 34" | 36" | 24" | W2-1824 | 810003951 | 16" | 18" |
| 10" | W2-610 | 810003803 | 4" | 6" | 24" | W2-2424 | 810003952 | 22" | 24" |
| 10" | W2-1210 | 810003804 | 10" | 12" | 24" | W2-3624 | 810003953 | 34" | 36" |
| 10" | W2-1810 | 810003805 | 16" | 18" | | | | | |

Adjustable Vent Length

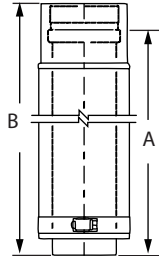

Use to add variable length to your straight length of FasNSeal pipe. Adds 2"-14" of length. Requires at least 4" overlap for a secure connection.

| SIZE | ORDER # | STOCK # | A | B | SIZE | ORDER # | STOCK # | A | B |
|------|----------|-----------|--------|-----|------|----------|-----------|--------|-----|
| 3" | W2-AVL3 | 810003661 | 2"-14" | 18" | 12" | W2-AVL12 | 810003833 | 2"-14" | 18" |
| 4" | W2-AVL4 | 810003682 | 2"-14" | 18" | 14" | W2-AVL14 | 810003858 | 2"-14" | 18" |
| 5" | W2-AVL5 | 810003703 | 2"-14" | 18" | 16" | W2-AVL16 | 810003881 | 2"-14" | 18" |
| 6" | W2-AVL6 | 810003724 | 2"-14" | 18" | 18" | W2-AVL18 | 810003904 | 2"-14" | 18" |
| 7" | W2-AVL7 | 810003745 | 2"-14" | 18" | 20" | W2-AVL20 | 810003921 | 2"-14" | 18" |
| 8" | W2-AVL8 | 810003765 | 2"-14" | 18" | 22" | W2-AVL22 | 810003938 | 2"-14" | 18" |
| 9" | W2-AVL9 | 810003788 | 2"-14" | 18" | 24" | W2-AVL24 | 810003954 | 2"-14" | 18" |
| 10" | W2-AVL10 | 810003808 | 2"-14" | 18" | | | | | |

90° Elbow

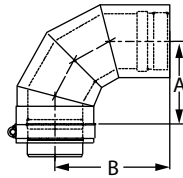

Use to go from horizontal to vertical runs or vertical to horizontal runs. Use to turn vent 90°.

| SIZE | ORDER # | STOCK # | A | B | SIZE | ORDER # | STOCK # | A | B |
|------|---------|-----------|--------|--------|------|---------|-----------|---------|---------|
| 3" | W2-9003 | 810003662 | 4" | 6" | 12" | W2-9012 | 810003834 | 8 1/2" | 10 1/4" |
| 4" | W2-9004 | 810003683 | 4 1/2" | 6 1/4" | 14" | W2-9014 | 810003859 | 9 1/2" | 11 3/8" |
| 5" | W2-9005 | 810003704 | 5" | 6 3/4" | 16" | W2-9016 | 810003882 | 11" | 12 1/2" |
| 6" | W2-9006 | 810003725 | 5 1/2" | 7 1/2" | 18" | W2-9018 | 810003905 | 11 1/2" | 13 1/8" |
| 7" | W2-9007 | 810003746 | 6 1/8" | 7 7/8" | 20" | W2-9020 | 810003922 | 12 1/2" | 14 1/2" |
| 8" | W2-9008 | 810003766 | 6 1/2" | 8 1/4" | 22" | W2-9022 | 810003939 | 13 3/8" | 15" |
| 9" | W2-9009 | 810003789 | 7" | 9" | 24" | W2-9024 | 810003955 | 14 1/2" | 16 1/8" |
| 10" | W2-9010 | 810003809 | 7 1/2" | 9 3/8" | | | | | |

88° Elbow

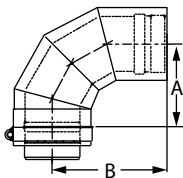

Use to transition from a vertical to a horizontal run. Facilitates a 2° pitch towards the condensate drain for good condensate management.

| SIZE | ORDER # | STOCK # | A | B | SIZE | ORDER # | STOCK # | A | B |
|------|---------|-----------|--------|--------|------|---------|-----------|--------|---------|
| 3" | W2-8803 | 810003663 | 4" | 6" | 12" | W2-8812 | 810003835 | 8 1/2" | 10 1/4" |
| 4" | W2-8804 | 810003684 | 4 1/2" | 6 3/5" | 14" | W2-8814 | 810003860 | 9 1/2" | 11 3/8" |
| 5" | W2-8805 | 810003705 | 5" | 6 3/4" | 16" | W2-8816 | 810003883 | 11" | 12 1/2" |
| 6" | W2-8806 | 810003726 | 5 1/2" | 7 1/2" | | | | | |
| 7" | W2-8807 | 810003747 | 6 1/8" | 7 7/8" | | | | | |
| 8" | W2-8808 | 810003767 | 6 1/2" | 8 1/4" | | | | | |
| 9" | W2-8809 | 810003790 | 7" | 9" | | | | | |
| 10" | W2-8810 | 810003810 | 7 1/2" | 9 3/8" | | | | | |

45° Elbow

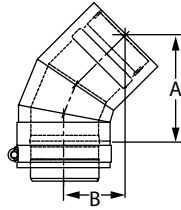

Offsets obstructions as needed. Allows for better condensate management and less back pressure.

| SIZE | ORDER # | STOCK # | A | B | SIZE | ORDER # | STOCK # | A | B |
|------|---------|-----------|--------|--------|------|---------|-----------|---------|--------|
| 3" | W2-4503 | 810003664 | 5 3/8" | 3" | 12" | W2-4512 | 810003836 | 8 1/2" | 4 1/4" |
| 4" | W2-4504 | 810003685 | 5 5/8" | 3 1/8" | 14" | W2-4514 | 810003861 | 9 1/4" | 4 5/8" |
| 5" | W2-4505 | 810003706 | 6" | 3 1/4" | 16" | W2-4516 | 810003884 | 10" | 4 7/8" |
| 6" | W2-4506 | 810003727 | 6 3/8" | 3 3/8" | 18" | W2-4518 | 810003907 | 11 1/8" | 5" |
| 7" | W2-4507 | 810003748 | 6 3/4" | 3 1/2" | 20" | W2-4520 | 810003924 | 12 7/8" | 5 1/4" |
| 8" | W2-4508 | 810003768 | 7 1/8" | 3 5/8" | 22" | W2-4522 | 810003941 | 11 5/8" | 5 5/8" |
| 9" | W2-4509 | 810003791 | 7 1/2" | 3 7/8" | 24" | W2-4524 | 810003957 | 12 3/8" | 5 7/8" |
| 10" | W2-4510 | 810003811 | 7 7/8" | 4" | | | | | |

30° Elbow

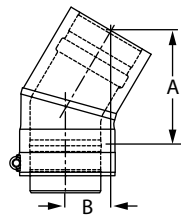

Offsets obstructions as needed. Allows for better condensate management and less back pressure.

| SIZE | ORDER # | STOCK # | A | B | SIZE | ORDER # | STOCK # | A | B |
|------|---------|-----------|--------|--------|------|---------|-----------|--------|--------|
| 3" | W2-3003 | 810003665 | 4 7/8" | 1 7/8" | 9" | W2-3009 | 810003792 | 7" | 2 1/2" |
| 4" | W2-3004 | 810003686 | 5 1/8" | 1 7/8" | 10" | W2-3010 | 810003812 | 6 1/2" | 2 1/4" |
| 5" | W2-3005 | 810003707 | 5 1/4" | 2" | 12" | W2-3012 | 810003837 | 7" | 2 1/2" |
| 6" | W2-3006 | 810003728 | 5 1/2" | 2" | 14" | W2-3014 | 810003862 | 7 1/2" | 2 1/2" |
| 7" | W2-3007 | 810003749 | 5 7/8" | 2" | 16" | W2-3016 | 810003885 | 8 1/8" | 2 3/4" |
| 8" | W2-3008 | 810003769 | 6 1/8" | 2 1/8" | | | | | |

15° Elbow

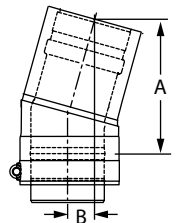

Offsets obstructions as needed. Allows for better condensate management and less back pressure.

| SIZE | ORDER # | STOCK # | A | B | SIZE | ORDER # | STOCK # | A | B |
|------|---------|-----------|--------|------|------|---------|-----------|--------|----|
| 3" | W2-1503 | 810003666 | 4 3/8" | 7/8" | 9" | W2-1509 | 810003793 | 5 1/4" | 1" |
| 4" | W2-1504 | 810003687 | 4 1/2" | 1" | 10" | W2-1510 | 810003813 | 5 1/4" | 1" |
| 5" | W2-1505 | 810003708 | 4 5/8" | 7/8" | 12" | W2-1512 | 810003838 | 5 1/2" | 1" |
| 6" | W2-1506 | 810003729 | 4 3/4" | 7/8" | 14" | W2-1514 | 810003863 | 5 3/4" | 1" |
| 7" | W2-1507 | 810003750 | 4 7/8" | 1" | 16" | W2-1516 | 810003886 | 6 1/8" | 1" |
| 8" | W2-1508 | 810003770 | 5 1/8" | 1" | | | | | |

Standard Tee

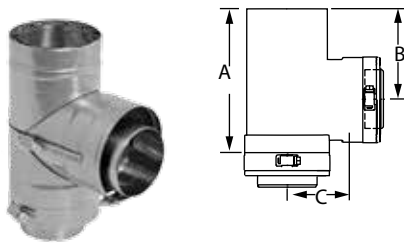

Use for a 90° offset, to combine connections from two or more appliances into a common vent or as a condensate management point when used in conjunction with drain fitting. All Standard Tees have completely welded inner walls.

| SIZE | ORDER # | STOCK # | A | B | C | SIZE | ORDER # | STOCK # | A | B | C |
|------|---------|-----------|----------|---------|--------|------|---------|-----------|----------|---------|--------|
| 3" | W2-T3 | 810003667 | 7 3/10" | 4 1/2" | 3" | 12" | W2-T12 | 810003839 | 16 3/10" | 9" | 7" |
| 4" | W2-T4 | 810003688 | 8 3/10" | 4 5/8" | 3 1/2" | 14" | W2-T14 | 810003864 | 20 3/10" | 11" | 8 1/2" |
| 5" | W2-T5 | 810003709 | 9 3/10" | 5 3/10" | 4" | 16" | W2-T16 | 810003887 | 22 3/10" | 12" | 9 1/2" |
| 6" | W2-T6 | 810003730 | 10 3/10" | 5 4/8" | 4 1/2" | 18" | W2-T18 | 810003908 | 22 7/8" | 12 1/2" | 11" |
| 7" | W2-T7 | 810003751 | 11 3/10" | 6 3/10" | 5" | 20" | W2-T20 | 810003925 | 24 7/8" | 13 1/2" | 12" |
| 8" | W2-T8 | 810003771 | 12 3/10" | 6 4/8" | 5 1/2" | 22" | W2-T22 | 810003942 | 26 7/8" | 14 1/2" | 13" |
| 9" | W2-T9 | 810003794 | 13 3/10" | 7 3/10" | 6" | 24" | W2-T24 | 810003958 | 28 7/8" | 15 1/2" | 14" |
| 10" | W2-T10 | 810003814 | 14 3/10" | 7 4/8" | 6 1/2" | | | | | | |

Wide Mouth Boot Tee

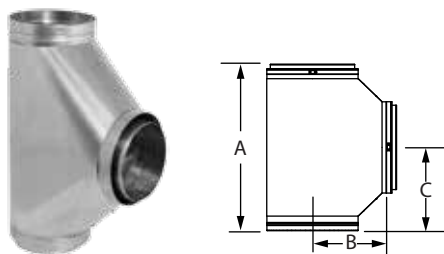

Use to transition from horizontal to vertical with improved flue gas flow with angled gradual transitions. Can also be used as a manifold connection to gang boilers into a common vent. Completely welded inner walls.

| SIZE | ORDER # | STOCK # | A | B | C | SIZE | ORDER # | STOCK # | A | B | C |
|------|----------|-----------|---------|--------|---------|------|----------|-----------|---------|-----|----------|
| 4" | W2-WBT4 | 810003689 | 15 3/4" | 7" | 6 9/10" | 12" | W2-WBT12 | 810003840 | 23 3/4" | 11" | 10 9/10" |
| 5" | W2-WBT5 | 810003710 | 16 3/4" | 7 1/2" | 7 4/10" | 14" | W2-WBT14 | 810003865 | 25 3/4" | 12" | 11 9/10" |
| 6" | W2-WBT6 | 810003731 | 17 3/4" | 8" | 7 9/10" | 16" | W2-WBT16 | 810003888 | 27 3/4" | 13" | 12 9/10" |
| 7" | W2-WBT7 | 810003752 | 18 3/4" | 8 1/2" | 8 4/10" | 18" | W2-WBT18 | 810003909 | 29 3/4" | 14" | 13 9/10" |
| 8" | W2-WBT8 | 810003772 | 19 3/4" | 9" | 8 9/10" | 20" | W2-WBT20 | 810003926 | 31 3/4" | 15" | 14 9/10" |
| 9" | W2-WBT9 | 810003795 | 20 3/4" | 9 1/2" | 9 4/10" | 22" | W2-WBT22 | 810003943 | 33 3/4" | 16" | 15 9/10" |
| 10" | W2-WBT10 | 810003815 | 21 3/4" | 10" | 9 9/10" | 24" | W2-WBT24 | 810003959 | 35 3/4" | 17" | 16 9/10" |

Double-Wall Wye

*new sizes available

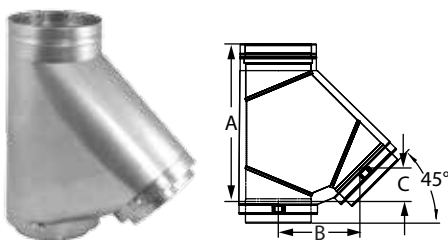

Use in place of any M&G DuraVent tee for a 45° angle instead of 90°; can be used as a manifold connection to gang multiple boilers into a common vent.

| SIZE | ORDER # | STOCK # | A | B | C |
|------|----------|-----------|----------|----------|----------|
| 6" | W2-WYE06 | 810004863 | 14 1/2" | 7 1/2" | 3 1/10" |
| 7" | W2-WYE07 | 810007021 | 16 1/3" | 8 3/5" | 3 1/2" |
| 8" | W2-WYE08 | 810004864 | 18" | 9 7/10" | 4" |
| 9" | W2-WYE09 | 810007022 | 19 7/10" | 10 7/10" | 4 2/5" |
| 10" | W2-WYE10 | 810004865 | 21 2/5" | 11 4/5" | 4 9/10" |
| 12" | W2-WYE12 | 810004866 | 24 9/10" | 14" | 5 4/5" |
| 14" | W2-WYE14 | 810004867 | 28 3/10" | 16 1/10" | 6 3/5" |
| 16" | W2-WYE16 | 810009327 | 31 4/5" | 18 1/5" | 7 1/2" |
| 18" | W2-WYE18 | 810010046 | 35 1/5" | 20 2/5" | 8 2/5" |
| 20" | W2-WYE20 | 810010047 | 38 3/5" | 22 1/2" | 9 3/10" |
| 22" | W2-WYE22 | 810007545 | 42 1/10" | 24 7/10" | 10 1/5" |
| 24" | W2-WYE24 | 810007546 | 45 1/2" | 26 4/5" | 11 1/10" |

Double-Wall Inceaser Wye

***new part**

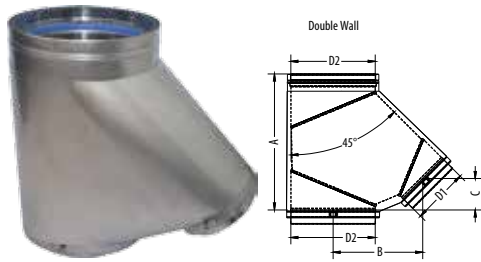

Use in place of any tee for a 45° angle instead of 90°. The branch has a smaller diameter, so it can be used to increase to a larger diameter as a manifold connection to gang multiple boilers into a common vent. Maximum diameter increase is 6". Available in custom size combinations.

| SIZE | ORDER # | STOCK # | A | B | C |
|----------|------------|-----------|---------|---------|--------|
| 6"x 8" | W2-WYE0608 | 810012570 | 15 3/8" | 9 1/4" | 3 3/8" |
| 6"x 10" | W2-WYE0610 | 810012571 | 16" | 10 5/8" | 3 5/8" |
| 6"x 12" | W2-WYE0612 | 810012572 | 17 1/8" | 12 1/2" | 4" |
| 8"x 10" | W2-WYE0810 | 810012573 | 18 3/4" | 11 3/8" | 4 3/8" |
| 8"x 12" | W2-WYE0812 | 810012574 | 19 3/8" | 12 3/4" | 4 1/2" |
| 8"x 14" | W2-WYE0814 | 810012575 | 20" | 14 1/4" | 4 5/8" |
| 10"x 12" | W2-WYE1012 | 810012576 | 22 1/4" | 13 1/2" | 5 1/8" |
| 10"x 14" | W2-WYE1014 | 810012577 | 22 7/8" | 15" | 5 3/8" |
| 10"x 16" | W2-WYE1016 | 810012578 | 23 1/2" | 16 3/8" | 5 1/2" |
| 12"x 14" | W2-WYE1214 | 810012579 | 25 5/8" | 15 5/8" | 6 1/8" |

Tee Cap



Use to cap Standard Tee, Branch Tee or Boot Tee. Remove Tee Cap to inspect the system; clean out debris.

| SIZE | ORDER # | STOCK # | A | SIZE | ORDER # | STOCK # | A |
|------|---------|-----------|--------|------|---------|-----------|--------|
| 3" | W2-TC3 | 810003668 | 3 1/2" | 12" | W2-TC12 | 810003841 | 3 1/2" |
| 4" | W2-TC4 | 810003690 | 3 1/2" | 14" | W2-TC14 | 810003866 | 3 1/2" |
| 5" | W2-TC5 | 810003711 | 3 1/2" | 16" | W2-TC16 | 810003889 | 3 1/2" |
| 6" | W2-TC6 | 810003732 | 3 1/2" | 18" | W2-TC18 | 810003910 | 3 1/2" |
| 7" | W2-TC7 | 810003753 | 3 1/2" | 20" | W2-TC20 | 810003927 | 3 1/2" |
| 8" | W2-TC8 | 810003774 | 3 1/2" | 22" | W2-TC22 | 810003944 | 3 1/2" |
| 9" | W2-TC9 | 810003796 | 3 1/2" | 24" | W2-TC24 | 810003960 | 3 1/2" |
| 10" | W2-TC10 | 810003817 | 3 1/2" | | | | |

Drain Fitting



Use instead of Tee Cap to manage condensates at the bottom of a vertical run. For vent systems larger than 5", use an IPS Drain Fitting.

| SIZE | ORDER # | STOCK # | A | B |
|------|---------|-----------|--------|------|
| 3" | W2-DF3 | 810003670 | 3 1/2" | 5/8" |
| 4" | W2-DF4 | 810003692 | 3 1/2" | 5/8" |
| 5" | W2-DF5 | 810003713 | 3 1/2" | 5/8" |

IPS Drain Fitting

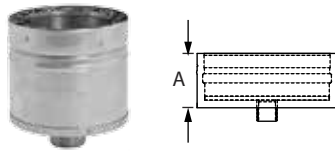

Use to connect iron drain pipe to flow acidic condensates to a neutralization tank before disposal. Uses 1" NPT thread.

| SIZE | ORDER # | STOCK # | A | SIZE | ORDER # | STOCK # | A |
|------|------------|-----------|--------|------|------------|-----------|--------|
| 3" | W2-IPSDF3 | 810003671 | 3 1/2" | 12" | W2-IPSDF12 | 810003843 | 3 1/2" |
| 4" | W2-IPSDF4 | 810003693 | 3 1/2" | 14" | W2-IPSDF14 | 810003868 | 3 1/2" |
| 5" | W2-IPSDF5 | 810003714 | 3 1/2" | 16" | W2-IPSDF16 | 810003890 | 3 1/2" |
| 6" | W2-IPSDF6 | 810003734 | 3 1/2" | 18" | W2-IPSDF18 | 810003911 | 3 1/2" |
| 7" | W2-IPSDF7 | 810003755 | 3 1/2" | 20" | W2-IPSDF20 | 810003928 | 3 1/2" |
| 8" | W2-IPSDF8 | 810003775 | 3 1/2" | 22" | W2-IPSDF22 | 810003945 | 3 1/2" |
| 9" | W2-IPSDF9 | 810003798 | 3 1/2" | 24" | W2-IPSDF24 | 810003961 | 3 1/2" |
| 10" | W2-IPSDF10 | 810003818 | 3 1/2" | | | | |

Wall Thimble w/ AVL

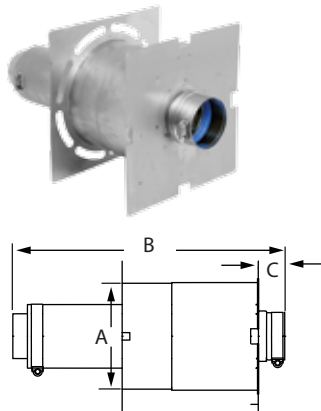

Use for through-the-wall termination. Fits between standard wall studs. 3"-5" diameters accommodates wall thickness of 4 1/4" to 8 1/2". 6"-16" diameters accommodate wall thickness of 5 3/4" to 11 1/2". AVL pipe allows for adjustability in length variance.

| SIZE | ORDER # | STOCK # | A | B | C |
|------|---------|-----------|-----|-----|--------|
| 3" | W2-WT3 | 810003672 | 6" | 18" | 1 1/5" |
| 4" | W2-WT4 | 810003694 | 7" | 18" | 1 1/5" |
| 5" | W2-WT5 | 810003715 | 8" | 18" | 1 1/5" |
| 6" | W2-WT6 | 810003735 | 9" | 18" | 1 1/5" |
| 7" | W2-WT7 | 810003756 | 10" | 18" | 1 1/5" |
| 8" | W2-WT8 | 810003776 | 11" | 18" | 1 1/5" |
| 9" | W2-WT9 | 810003799 | 12" | 18" | 1 1/5" |
| 10" | W2-WT10 | 810003819 | 13" | 18" | 1 1/5" |
| 12" | W2-WT12 | 810003844 | 15" | 18" | 1 1/5" |
| 14" | W2-WT14 | 810003869 | 17" | 18" | 1 1/5" |
| 16" | W2-WT16 | 810003892 | 19" | 18" | 1 1/5" |

Wall Thimble Sleeve

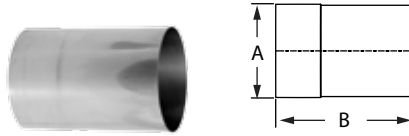

When installing FasNSeal W2 with this component use 1" larger diameter, (e.g. 10" vent system, use 11" size).

| SIZE | ORDER # | STOCK # | A | B |
|------|---------|-----------|-----|----|
| 3" | FSWTE3 | 810003126 | 6" | 9" |
| 4" | FSWTE4 | 810003180 | 7" | 9" |
| 5" | FSWTE5 | 810003233 | 8" | 9" |
| 6" | FSWTE6 | 810003286 | 9" | 9" |
| 7" | FSWTE7 | 810003330 | 10" | 9" |
| 8" | FSWTE8 | 810003373 | 11" | 9" |
| 9" | FSWTE9 | 810003412 | 12" | 9" |
| 10" | FSWTE10 | 810003450 | 13" | 9" |
| 12" | FSWTE12 | 810003491 | 15" | 9" |
| 14" | FSWTE14 | 810003531 | 17" | 9" |
| 16" | FSWTE16 | 810003566 | 19" | 9" |

Support Clamp



Use to support vertical and horizontal runs. Recommended every 10' in the vertical run. Use additional Support Clamps as needed. When installing FasNSeal W2 with this component use 1" larger diameter, (e.g. 10" vent system, use 11" size).

| SIZE | ORDER # | STOCK # | A | SIZE | ORDER # | STOCK # | A |
|------|---------|-----------|--------|------|---------|-----------|--------|
| 4" | FSCL4 | 810003182 | 1 1/2" | 13" | FSCL13 | 810003849 | 1 1/2" |
| 5" | FSCL5 | 810003235 | 1 1/2" | 15" | FSCL15 | 810003873 | 1 1/2" |
| 6" | FSCL6 | 810003288 | 1 1/2" | 17" | FSCL17 | 810003895 | 1 1/2" |
| 7" | FSCL7 | 810003332 | 1 1/2" | 19" | FSCL19 | 810003913 | 1 1/2" |
| 8" | FSCL8 | 810003375 | 1 1/2" | 21" | FSCL21 | 810003930 | 1 1/2" |
| 9" | FSCL9 | 810003414 | 1 1/2" | 23" | FSCL23 | 810003947 | 1 1/2" |
| 10" | FSCL10 | 810003452 | 1 1/2" | 25" | FSCL25 | 810003963 | 1 1/2" |
| 11" | FSCL11 | 810003825 | 1 1/2" | | | | |

Rain Cap

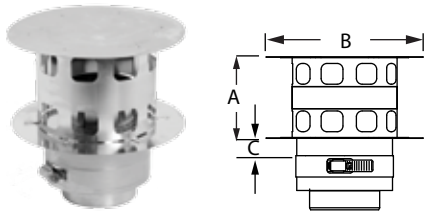

Use where pipe terminates above the roof line. When terminating larger than 12" vent diameter use a Termination Cone.

| SIZE | ORDER # | STOCK # | A | B | C |
|------|---------|-----------|--------|----------|----|
| 3" | W2-RC3 | 810003673 | 3 1/2" | 6 4/5" | 1" |
| 4" | W2-RC4 | 810003695 | 4 1/2" | 8 9/10" | 1" |
| 5" | W2-RC5 | 810003716 | 5 1/2" | 11 3/10" | 1" |
| 6" | W2-RC6 | 810003736 | 6 4/5" | 13 1/2" | 1" |
| 7" | W2-RC7 | 810003757 | 7 4/5" | 15 4/5" | 1" |
| 8" | W2-RC8 | 810003777 | 8 4/5" | 18" | 1" |
| 9" | W2-RC9 | 810003800 | 10" | 20 3/10" | 1" |
| 10" | W2-RC10 | 810003820 | 11" | 22 1/2" | 1" |
| 12" | W2-RC12 | 810003845 | 13" | 27" | 1" |

Termination Cone

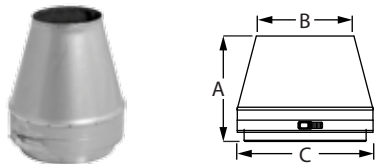

Use for vertical termination. Creates static back pressure to adjust harmonics. Venturi effect increases velocity of flue gases. Reduced opening provides for a smaller cross section to deter rain from entering the system. **Available in custom size combinations.**

| SIZE | ORDER # | STOCK # | A | B | C |
|-----------|-----------|-----------|-----|-----|--------|
| 8" x 6" | W2-CN0806 | 810003778 | 8" | 6" | 6 2/5" |
| 14" x 12" | W2-CN1412 | 810003870 | 14" | 12" | 6 2/5" |

Stepped In increaser



Use to increase vent diameter when space constraints are an issue. **Available in custom size combinations.**

| SIZE | ORDER # | STOCK # | A | B |
|---------|---------|-----------|----|----|
| 4" x 5" | W2-45I | 810003696 | 4" | 5" |
| 8" x 9" | W2-89I | 810003779 | 8" | 9" |

Tapered In increaser

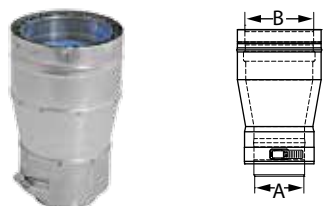

Use to increase vent diameter. Creates a smooth transition for an undistruptive flow. FasNSeal W2 has a 10" max change in diameter. **Available in custom size combinations.**

| SIZE | ORDER # | STOCK # | A | B |
|---------|-----------|-----------|----|----|
| 3" x 4" | W2-0304TI | 810003674 | 3" | 4" |
| 3" x 6" | W2-0306TI | 810003675 | 3" | 6" |

Eccentric Increaser

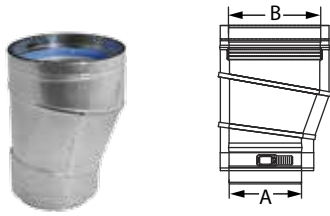

Use to transition to a larger diameter pipe. Adjusts the systems center point to offset from obstructions. Aids in reducing formation of condensates on horizontal runs. FasNSeal W2 has a 10" max change in diameter. **Available in custom size combinations.**

| SIZE | ORDER # | STOCK # | A | B |
|----------|-----------|-----------|----|-----|
| 8" x 10" | W2-0810E1 | 810003781 | 8" | 10" |

Stepped Reducer

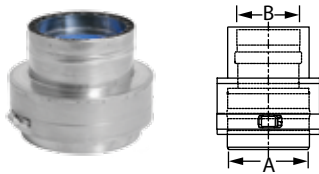

Use to reduce vent diameter when space constraints are an issue. **Available in custom size combinations.**

| SIZE | ORDER # | STOCK # | A | B |
|-----------|----------|-----------|-----|-----|
| 7" x 5" | W2-75R | 810003758 | 7" | 5" |
| 12" x 10" | W2-1210R | 810003847 | 12" | 10" |

Tapered Reducer

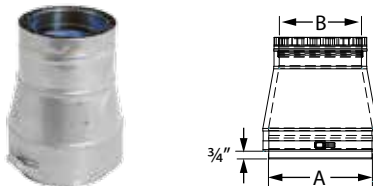

Use to reduce vent diameter. Creates a smooth transition for an undisruptive flow. FasNSeal W2 has a 10" max change in diameter. **Available in custom size combinations.**

| SIZE | ORDER # | STOCK # | A | B |
|----------|-----------|-----------|-----|----|
| 8" x 7" | W2-0807TR | 810003780 | 8" | 7" |
| 10" x 7" | W2-1007TR | 810003822 | 10" | 7" |

Single-Wall Adapter

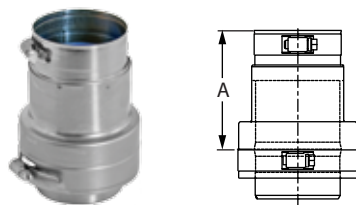

Use to transition from double-wall pipe to single-wall pipe. To transition from single-wall to double-wall, please reference double-wall adapter available in single-wall FasNSeal section.

| SIZE | ORDER # | STOCK # | A | SIZE | ORDER # | STOCK # | A |
|------|-----------|-----------|----|------|------------|-----------|----|
| 3" | FSA-DWSW3 | 810003676 | 4" | 9" | FSA-DWSW9 | 810003801 | 4" |
| 4" | FSA-DWSW4 | 810003697 | 4" | 10" | FSA-DWSW10 | 810003821 | 4" |
| 5" | FSA-DWSW5 | 810003717 | 4" | 12" | FSA-DWSW12 | 810003846 | 4" |
| 6" | FSA-DWSW6 | 810003737 | 4" | 14" | FSA-DWSW14 | 810003871 | 4" |
| 7" | FSA-DWSW7 | 810003759 | 4" | 16" | FSA-DWSW16 | 810003893 | 4" |
| 8" | FSA-DWSW8 | 810003782 | 4" | | | | |

Firestop/Flat Flashing

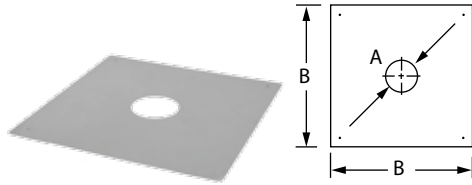

Use when penetrating floor levels. When installing double-wall with this component use 1" larger diameter, (e.g. 10" vent system, use 11" size).

| SIZE | ORDER # | STOCK # | A | B | SIZE | ORDER # | STOCK # | A | B |
|------|---------|-----------|---------|-----|------|---------|-----------|---------|-----|
| 4" | FSFS4 | 810003181 | 4 1/4" | 15" | 15" | FSFS15 | 810003872 | 15 3/5" | 28" |
| 5" | FSFS5 | 810003234 | 5 3/5" | 17" | 16" | FSFS16 | 810003567 | 16 3/5" | 28" |
| 6" | FSFS6 | 810003287 | 6 3/5" | 17" | 17" | FSFS17 | 810003894 | 17 3/5" | 30" |
| 7" | FSFS7 | 810003331 | 7 3/5" | 19" | 18" | FSFS18 | 810003591 | 18 3/5" | 30" |
| 8" | FSFS8 | 810003374 | 8 3/5" | 19" | 19" | FSFS19 | 810003912 | 19 3/5" | 32" |
| 9" | FSFS9 | 810003413 | 9 3/5" | 22" | 20" | FSFS20 | 810003611 | 20 3/5" | 32" |
| 10" | FSFS10 | 810003451 | 10 3/5" | 22" | 21" | FSFS21 | 810003929 | 21 3/5" | 34" |
| 11" | FSFS11 | 810003823 | 11 3/5" | 24" | 22" | FSFS22 | 810003631 | 22 3/5" | 34" |
| 12" | FSFS12 | 810003492 | 12 3/5" | 24" | 23" | FSFS23 | 810003946 | 23 3/5" | 36" |
| 13" | FSFS13 | 810003848 | 13 3/5" | 26" | 24" | FSFS24 | 810003650 | 24 3/5" | 36" |
| 14" | FSFS14 | 810003532 | 14 3/5" | 26" | | | | | |

Wall Bracket

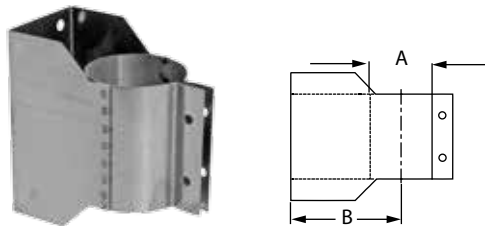

Use to support vent pipe or tee sections. Provides proper clearance to combustibles. When installing FasNSeal W2 with this component use 1" larger diameter, (e.g. 10" vent system, use 11" size).

| SIZE | ORDER # | STOCK # | A | B | SIZE | ORDER # | STOCK # | A | B |
|------|---------|-----------|-----|--------|------|---------|-----------|-----|---------|
| 4" | FSWB4 | 810003183 | 4" | 4" | 11" | FSWB11 | 810003826 | 11" | 7 1/2" |
| 5" | FSWB5 | 810003236 | 5" | 4 1/2" | 12" | FSWB12 | 810003494 | 12" | 8" |
| 6" | FSWB6 | 810003289 | 6" | 5" | 13" | FSWB13 | 810003850 | 13" | 8 1/2" |
| 7" | FSWB7 | 810003333 | 7" | 5 1/2" | 14" | FSWB14 | 810003534 | 14" | 9" |
| 8" | FSWB8 | 810003376 | 8" | 6" | 15" | FSWB15 | 810003874 | 15" | 9 1/2" |
| 9" | FSWB9 | 810003415 | 9" | 6 1/2" | 16" | FSWB16 | 810003569 | 16" | 10" |
| 10" | FSWB10 | 810003453 | 10" | 7" | 17" | FSWB17 | 810003896 | 17" | 10 1/2" |

Bird Screen



Use for 3" and 4" standard through-the-wall terminations. Check installation instructions for restrictions on horizontal terminations, such as minimum distance from windows and doors.

| SIZE | ORDER # | STOCK # | A |
|------|---------|-----------|----|
| 3" | FSBS3 | 810003120 | 2" |
| 4" | FSBS4 | 810003174 | 2" |

23° Bird Screen

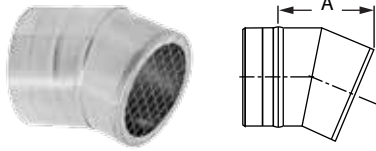

Use for 5" to 16" through-the-wall termination. Deters rain and other elements from entering the vent system. Check installation instructions for restrictions on horizontal terminations, such as minimum distance from windows and doors.

| SIZE | ORDER # | STOCK # | A |
|------|---------|-----------|----------|
| 5" | FSBS5 | 810003229 | 4 4/5" |
| 6" | FSBS6 | 810003281 | 5 3/5" |
| 7" | FSBS7 | 810003327 | 6 2/5" |
| 8" | FSBS8 | 810003369 | 7 1/10" |
| 9" | FSBS9 | 810003409 | 7 9/10" |
| 10" | FSBS10 | 810003447 | 8 7/10" |
| 12" | FSBS12 | 810003488 | 10 1/5" |
| 14" | FSBS14 | 810003528 | 11 7/10" |
| 16" | FSBS16 | 810003563 | 13 1/5" |

Termination Tee

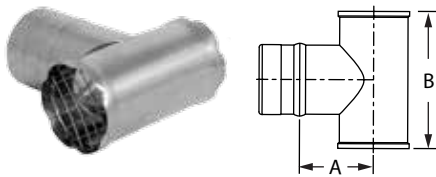

Use for standard and high-wind through-the-wall terminations. Check installation instructions for restrictions on horizontal terminations, such as minimum distance from windows and doors.

| SIZE | ORDER # | STOCK # | A | B |
|------|---------|-----------|--------|----|
| 3" | FSTT3 | 810003121 | 3" | 6" |
| 4" | FSTT4 | 810003175 | 3 1/2" | 7" |
| 5" | FSTT5 | 810003230 | 4" | 8" |
| 6" | FSTT6 | 810003282 | 4 1/2" | 9" |

Termination Box

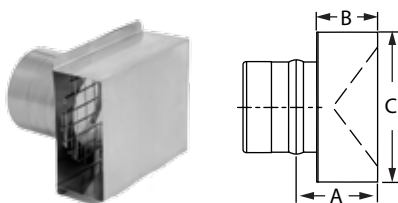

Use for horizontal through-the-wall terminations. Check installation instructions for restrictions on horizontal terminations, such as minimum distance from windows and doors.

| SIZE | ORDER # | STOCK # | A | B | C |
|------|---------|-----------|---------|----|----|
| 3" | FSTB3 | 810003122 | 2 3/10" | 2" | 5" |
| 4" | FSTB4 | 810003176 | 2 3/10" | 2" | 6" |

Storm Collar



Use to create a weather tight seal between the pipe and flashing. When installing FasNSeal W2 with this component use 1" larger diameter, (e.g. 10" vent system, use 11" size).

| SIZE | ORDER # | STOCK # | SIZE | ORDER # | STOCK # |
|------|---------|-----------|------|---------|-----------|
| 4" | FSC4 | 810003188 | 13" | FSC13 | 810003852 |
| 5" | FSC5 | 810003239 | 15" | FSC15 | 810003875 |
| 6" | FSC6 | 810003293 | 17" | FSC17 | 810003898 |
| 7" | FSC7 | 810003336 | 19" | FSC19 | 810003915 |
| 8" | FSC8 | 810003381 | 21" | FSC21 | 810003932 |
| 9" | FSC9 | 810003419 | 23" | FSC23 | 810003948 |
| 10" | FSC10 | 810003460 | 25" | FSC25 | 810003965 |
| 11" | FSC11 | 810003827 | | | |

Variable Pitch Roof Flashing

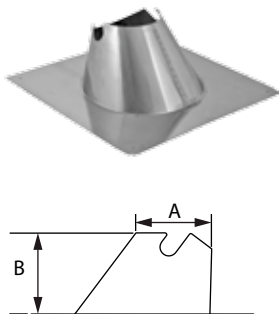

Use to create a weather-tight penetration where the vent pipe passes through the roof. Storm Collar required. When ordering Flashings for FasNSeal W2 product the flashing diameter and vent diameter are the same. ie. W2-3610 requires a FSVPF10. Accommodates flat to 9/12 roof pitch.

| SIZE | ORDER # | STOCK # | A | B | SIZE | ORDER # | STOCK # | A | B |
|------|---------|-----------|-----|----|------|---------|-----------|-----|---------|
| 4" | FSVPF4 | 810003190 | 6" | 7" | 12" | FSVPF12 | 810003503 | 14" | 7" |
| 5" | FSVPF5 | 810003241 | 7" | 7" | 14" | FSVPF14 | 810003540 | 16" | 7" |
| 6" | FSVPF6 | 810003295 | 8" | 7" | 16" | FSVPF16 | 810003574 | 18" | 7" |
| 7" | FSVPF7 | 810003338 | 9" | 7" | 18" | FSVPF18 | 810003596 | 20" | 28 1/2" |
| 8" | FSVPF8 | 810003383 | 10" | 7" | 20" | FSVPF20 | 810003616 | 22" | 29 1/2" |
| 9" | FSVPF9 | 810003421 | 11" | 7" | 22" | FSVPF22 | 810003635 | 24" | 30 1/2" |
| 10" | FSVPF10 | 810003462 | 12" | 7" | 24" | FSVPF24 | 810003655 | 26" | 31 1/2" |

Tall Cone Flashing

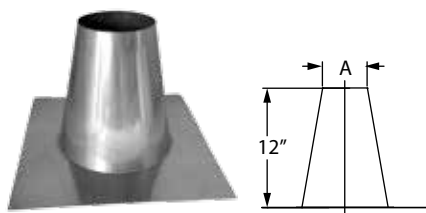

Use to create a weather-tight penetration where the vent pipe passes through a flat roof. Storm Collar required. When ordering Flashings for FasNSeal W2 product the flashing diameter and vent diameter are the same. ie. W2-3610 requires a FSAF10.

| SIZE | ORDER # | STOCK # | A | SIZE | ORDER # | STOCK # | A |
|------|---------|-----------|--------|------|---------|-----------|---------|
| 3" | FSAF3 | 810005257 | 4 1/3" | 9" | FSAF9 | 810005263 | 10 1/3" |
| 4" | FSAF4 | 810005258 | 5 1/3" | 10" | FSAF10 | 810005264 | 11 1/3" |
| 5" | FSAF5 | 810005259 | 6 1/3" | 12" | FSAF12 | 810005269 | 13 1/3" |
| 6" | FSAF6 | 810005260 | 7 1/3" | 14" | FSAF14 | 810005270 | 15 1/3" |
| 7" | FSAF7 | 810005261 | 8 1/3" | 16" | FSAF16 | 810005271 | 17 1/3" |
| 8" | FSAF8 | 810005262 | 9 1/3" | | | | |

Appliances and Adapters ***updated information**

| Manufacturer | Model | Appliance Adapter | Termination Adapter |
|---------------------|---------------------------|---------------------------|---------------------|
| Aerco International | Benchmark 2.0 GWS, 3.0 LN | FSA-AE8 | |
| | Benchmark 1000 | FSA-AE6 | |
| | KC-1000 | FSA-AE6 | |
| | Modulex Series | Standard Vent Pipe 4", 6" | |
| Ajax | Atlas GS Series | FSA-HFA6, 8 | |
| | A250, A300 | FSAAU12 | |
| A.O. Smith | Burkay Genesis Series | FSA-HFA4 a, 5 a | |
| | Legend 2000 Series | FSA-HFA6 a, 7 a | |
| | ProStar Series | FSAAU4 | |
| | GB/GW 400, 500 | FSAAU6 | |
| | GB/GW 1000 | FSAAU10 | |
| | GB/GW 1300, 1500 | FSAAU12 | |
| | GB/GW 1850, 2100 | FSAAU14 | |
| | GB/GW 2500 | FSAAU16 | |
| | GB/GW 300 | FSAAU10 | |
| | GB/GW 650, 750 | FSAAU8 | |
| | ATI 705-N | FSAAU4 | |
| | ATIO 910-N | FSAAU5 | |
| | Cyclone BTH-150 | FSA-PVC3 | |
| | Cyclone BTH-300, 400, 500 | FSA-PVC4 | |
| | VW-750 | FSA-HFA6 | |
| | VW-1500 | FSA-HFA7 | |
| Aerco | Benchmark 1.5 | FSA-AE6 | |
| | Benchmark 750 | FSA-AE6 | |
| | Benchmark 1000 | FSA-AE6 | |
| | Benchmark 3000 | FSA-AE8 | |
| | Benchmark 6000 | FSA-AE14 | |
| | Esteem 399 (tankless) | FSA-ULT4 | |
| Atlas | 300 | FS34I | |
| Beacon/Morris | BRU Series | FSAAU4 | |
| | BTU Series | FSAAU4, 5, 6 | |
| Bosch | Aquastar 125 FX | FSA-LMGD4 a | |
| | Aquastar GHW-635-ES | Standard Vent Pipe 3" | |
| | Aquastar 250SX | Standard Vent Pipe 3" | |
| | Aquastar 240FX | FSAAU3 | |
| | AquaStar 2400ES | FSAAU4 | |
| | AquaStar 2700ES | FSAAU4 | |
| | GWH 425EF | FSAAU4 | |
| | 660 EF | FSAAU3 | |
| | SB625WS-160 | FSA-200-8TP, W2-200-8TP | |
| | SB625WS-220 | FSA-200-8TP, W2-200-8TP | |
| | SB625WS-290 | FSA-250-10TP, W2-250-10TP | |
| | SB625WS-370 | FSA-250-10TP, W2-250-10TP | |
| | SB625WS-480 | FSA-300-12TP, W2-300-12TP | |
| | SB625WS-640 | FSA-300-12TP, W2-300-12TP | |

| | | | |
|-------------------------|-------------------|---------------------------|-----------------|
| Bosch | SB745WS-800 | FSA-350-14TP, W2-350-14TP | |
| | SB745WS-1050 | FSA-350-14TP, W2-350-14TP | |
| | SB745WS-1300 | FSA-400-16TP, W2-400-16TP | |
| | SB745WS-1550 | FSA-450-18TP, W2-450-18TP | |
| Bradford-White | EF Series | FSA-PVC3 | |
| Bryan | AB Series | FSAAU | |
| Buderus | G115 Series | FSAAU4 or FSAAU5 | |
| | G124X Series | FSAAU5, 6 | |
| | G-515/ 7-12 | FSAAU10 | |
| | GA124 Series | FSAAU3 | |
| | GA244/37, 44, 53 | FSAAU3 | |
| | Buderus | GA244/62 | FSAAU4 |
| GB142 Series | | FSAAU3 | |
| GB312/90 to GB312/160 | | FSA-158-6F | |
| GB312/200 to GB312/280 | | FSA-197-8F | |
| SB615 Series | | FSA-SB7, 8, 10, 12 | |
| SB735 Series | | FSA-SB14 | |
| Burnham | | Independence PV | FSA-HFB3 b |
| | Minute Man II | FSA-HFB3 b | FSA-PV3 |
| | Revolution | FSA-HFB3 b | FSA-PV3 |
| | Revolution II | FSA-HFB3 b | FSA-PV3 |
| | Series 2PV | FSA-HFB3 b | FSA-PV3 |
| | Spirit | FSA-HFB3 b | FSA-PV3 |
| | PVG/SCG Series | FSA-HFB3 b, 4 b | |
| | V11 Series | FSAAU8, 10, 12, 14, 16 | |
| | V905 | FSAAU8 | |
| | ALP 150 | FSA-PVC3 | |
| | ALP 285 | FSA-PVC4 | |
| | ALP 399 | FSA-PVC4 | |
| | ALP 500 | FSA-PVC4 | |
| | Camus Boiler | MicoFlame Series I | FSAAU3, 4, 5, 6 |
| MicoFlame Series II | | FSAAU8, 10, 12 | |
| MicoFlame Grande Series | | FSAAU12, 14 | |
| DynaFlame Series | | FSAAU6, 8, 10, 12, 14 | |
| Camus | DynaMax | Standard Vent Pipe 6" | |
| | DynaForce 1000 | FSAAU6 or 7 | |
| | DynaForce 1600 | FSAAU7 | |
| | DynaForce 3000 | FSAAU9 | |
| Carel | Humidifier UG 180 | FSAAU5 | |
| Cleaver Brooks | MCF Series | FSA-MCF6, 8, 10, 12 | |
| | FLX Series | FSA-FLX10, 12, 16 | |
| | CFC 500 | FSAAU6 | |
| | CFC 1000 | FSA-MCF8 | |
| | CFC 1500 | FSAAU10 | |
| | CFC 1800 | FSA-MCF12 | |
| | CFC 2500 | FSAAU12 | |