



TYPE B GAS VENT
Edition 5



MODEL TYPE B GAS VENT

INTRODUCTION	2	TEE	18
ROUND		REDUCING TEE	18
PIPE SECTIONS	3	OVAL TEE CAP	18
ADJUSTABLE LENGTH	4	TEE SUPPORT	18
ADJUSTABLE 90° ELBOW	4	CAP	19
45° ELBOW	5	TEE COLLAR	19
TEE	5	OVAL CAP	19
REDUCING TEE	6	STORM COLLAR	19
TEE CAPS	6	ALL- PITCH FLASHING	19
STANDARD WYE	6	FIRESTOP SPACERS	20
REDUCTION WYE	6	TYPE BW HOLD-DOWN PLATE	20
CAPS	7	TYPE BW PLATE SPACERS	20
UNIVERSAL ADAPTERS	8	TYPE BW ATTIC SHIELD	20
VENT PIPE HANGERS	8	TYPE BW INSTALLATION KIT	20
DRAFT HOOD CONNECTOR	8	GAS VENT TERMINATION TABLE	21
INCREASER	9	GAS VENT OFFSETS TABLE	21
GRIPPER SUPPORT	9	SYSTEM DESIGN AND INSTALLATION GUIDE ..	22
BUCKET CONNECTOR	9	GAS VENT INSTALLATION DIAGRAM	23
BUCKET SUPPORT	10	SPECIFICATIONS AND DIMENSIONS	24
FIRESTOP SUPPORT	10	GAS VENT CONNECTORS	
SUPPORT PLATE	11	DOUBLE - WALL GAS VENT SEGMENT	25
TEE SUPPORT PLATE	11	DOUBLE - WALL GAS VENT SEGMENT	25
VENT COLLAR	11	ASSEMBLIES	26
WALL THIMBLE	12	WYES	26
STORM COLLAR	12	SINGLE - WALL INCREASER	27
FLASHINGS	13	SINGLE - WALL APPLIANCE CONNECTOR	27
FLASHINGS	14	SINGLE - WALL UNIVERSAL ADAPTER	27
OVAL		TYPICAL INSTALLATIONS DIAGRAM	28
PIPE SECTION	15	FLEXI - LINER LINER KITS	29
ADJUSTABLE LENGTH	16	CHIMNEY LINER KITS	30
INCREASER	16	LIMITED LIFETIME WARRANTY	32
ADAPTERS	16		
45° ELBOW - STANDARD	17		
45° ELBOW - FLAT	17		

Model TYPE B GAS VENT

Model TYPE B GAS VENT is used for venting all Category 1 listed gas appliances having draft hoods and other appliances listed to be used with Type B Gas Vent. For more information on venting unlisted gas appliances or appliances burning solid or liquid fuels, request our **All-Fuel Chimneys** catalog.

The AmeriVent System

AmeriVent is a pioneer in the development and simplification of effective venting products since 1951, AmeriVent components are crafted for today's building and appliance requirements. For any Type B gas venting, you will find AmeriVent has the most complete line of pipe and accessories.

One of the fire safety features of double-wall Type B gas vent is that its outer wall, insulated by the airspace beneath it requires only 1" clearance to combustible material in the structure. AmeriVent is a complete gas venting system, from draft hood connectors to caps. Whatever your gas venting needs - from 3" to 30" pipe diameters in 7 different pipe lengths, from single- to multi-appliance hook-ups - you can create almost any system from our more than 350 coordinated parts. Featuring Snap-Lock joints that are quick and easy to disconnect, the AmeriVent Type B gas vent system is lightweight with no sacrifice in strength, and is available in large sizes, adjustable components, and multi-story Type BW venting installation.



Product Description

The Type B designation is assigned to gas venting systems that meet the safety requirements of Underwriters Laboratories, Inc. The AmeriVent all-metal, double-wall gas vent is listed as Type B by UL and is approved for such residential and commercial applications as Category 1 water heaters, boilers, furnaces, space heaters, or wall heaters. UL-approved Type B gas vent products form a continuous passageway from an approved gas appliance to the termination of the vent above the roof of the structure.



Available Pipe Sizes and Lengths

Round

Sizes: 3", 4", 5", 6", 7", and 8"

Lengths: 6", 12", 18", 24", 3', 4' (except 8" size), and 5'

Sizes: 9", 10", 12", 14", 16", 18", 20", 22", 24", 26", 28" and 30"

Lengths: 12", 18", 24" and 3'

Oval

Sizes: 4" and 5"

Lengths: 6", 12", 18", 24", 3', 4, and 5'

Sizes: 6"

Lengths: 6", 12", 18", 24" and 3'

Maximum Height

Unlimited if properly supported

Insulation

1/2 BTU per hour per square foot per degree F temperature differential. (U factor=0.5)

Accepted by AGA, NFPA, HUD, NBC, UBC

Listed by Underwriters Laboratories, Inc. to UL441 test standard

How to Specify

Gas vents shall be UL-listed AmeriVent Gas Vent or equal installed in accordance with terms of the UL-listing and the manufacturer's published instructions.

The AmeriVent Type B Quick Disconnect System

To Connect: Snap-lock pipe and fittings together.

To Disengage the Locking Tab: Align the seams and pull apart.

Locking Tab: To ensure a secure fit, push in the locking tab to lock the pipe together.

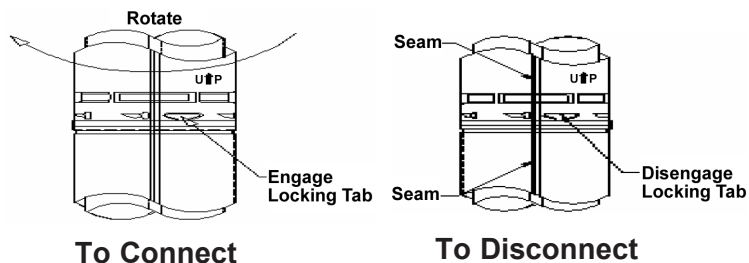

Round Pipe Section

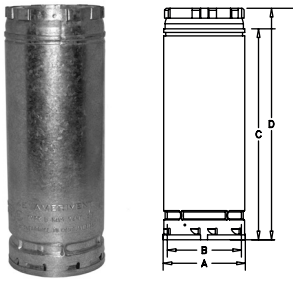

- AmeriVent pipe is made of corrosion-resistant galvanized steel and aluminum as double-wall construction.
- Ends have a snap-lock coupling for easy installation.
- AmeriVent snap-lock joints overlap. To calculate height deduct 1" for each joint.

Size	Part #	A.O.D.	B.I.D.	C	D	Size	Part #	A.O.D.	B.I.D.	C	D	Size	Part #	A.O.D.	B.I.D.	C	D
3"	3E5	3½"	3"	59"	60"	4"	4E5	4½"	4"	59"	60"	5"	5E5	5½"	5"	59"	60"
	3E4	3½"	3"	47"	48"		4E4	4½"	4"	47"	48"		5E4	5½"	5"	47"	48"
	3E3	3½"	3"	35"	36"		4E3	4½"	4"	35"	36"		5E3	5½"	5"	35"	36"
	3E24	3½"	3"	23"	24"		4E24	4½"	4"	23"	24"		5E24	5½"	5"	23"	24"
	3E18	3½"	3"	17"	18"		4E18	4½"	4"	17"	18"		5E18	5½"	5"	17"	18"
	3E12	3½"	3"	11"	12"		4E12	4½"	4"	11"	12"		5E12	5½"	5"	11"	12"
	3E6	3½"	3"	5"	6"		4E6	4½"	4"	5"	6"		5E6	5½"	5"	5"	6"
6"	6E5	6½"	6"	59"	60"	7"	7R5	8"	7"	59"	60"	8"	8R5	9"	8"	59"	60"
	6E4	6½"	6"	47"	48"		7R4	8"	7"	47"	48"		8R4	9"	8"	NA	48"
	6E3	6½"	6"	35"	36"		7R3	8"	7"	35"	36"		8R3	9"	8"	35"	36"
	6E24	6½"	6"	23"	24"		7R24	8"	7"	23"	24"		8R24	9"	8"	23"	24"
	6E18	6½"	6"	17"	18"		7R18	8"	7"	17"	18"		8R18	9"	8"	17"	18"
	6E12	6½"	6"	11"	12"		7R12	8"	7"	11"	12"		8R12	9"	8"	11"	12"
	6E6	6½"	6"	5"	6"		7R6	8"	7"	5"	6"		8R6	9"	8"	5"	6"
9"	9R3	10"	9"	35"	36"	10"	10R3	11"	10"	35"	36"	12"	12R3	13"	12"	35"	36"
	9R24	10"	9"	23"	24"		10R24	11"	10"	23"	24"		12R24	13"	12"	23"	24"
	9R18	10"	9"	17"	18"		10R18	11"	10"	17"	18"		12R18	13"	12"	17"	18"
	9R12	10"	9"	11"	12"		10R12	11"	10"	11"	12"		12R12	13"	12"	11"	12"
14"	14R3	15"	14"	35"	36"	16"	16R3	17"	16"	35"	36"	18"	18R3	19"	18"	35"	36"
	14R24	15"	14"	23"	24"		16R24	17"	16"	23"	24"		18R24	19"	18"	23"	24"
	14R18	15"	14"	17"	18"		16R18	17"	16"	17"	18"		18R18	19"	18"	17"	18"
	14R12	15"	14"	11"	12"		16R12	17"	16"	11"	12"		18R12	19"	18"	11"	12"
20"	20R3	21"	20"	35"	36"	22"	22R3	23"	22"	35"	36"	24"	24R3	25"	24"	35"	36"
	20R24	21"	20"	23"	24"		22R24	23"	22"	23"	24"		24R24	25"	24"	23"	24"
	20R18	21"	20"	17"	18"		22R18	23"	22"	17"	18"		24R18	25"	24"	17"	18"
	20R12	21"	20"	11"	12"		22R12	23"	22"	11"	12"		24R12	25"	24"	11"	12"
26"	26R3	27"	26"	35"	36"	28"	28R3	29"	28"	35"	36"	30"	30R3	25"	31"	35"	36"
	26R24	27"	26"	23"	24"		28R24	29"	28"	23"	24"		30R24	25"	31"	23"	24"
	26R18	27"	26"	17"	18"		28R18	29"	28"	17"	18"		30R18	25"	31"	17"	18"
	26R12	27"	26"	11"	12"		28R12	29"	28"	11"	12"		30R12	25"	31"	11"	12"

Adjustable Length



- Adjustable lengths telescope into standard AmeriVent pipe sections to reach desired length.

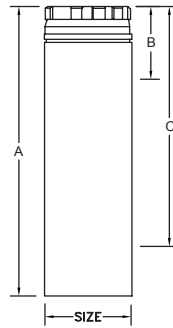

Part #	Size	A	Extension From B	Length To C
3E12A	3"	12"	3"	10"
4E12A	4"	12"	3"	10"
5E12A	5"	12"	3"	10"
6E12A	6"	12"	3"	10"
7R12A	7"	12"	3"	10"
8R12A	8"	12"	3"	10"
9R18A	9"	18"	3"	16"
10R18A	10"	18"	3"	16"
12R18A	12"	18"	3"	16"
14R18A	14"	18"	5"	16"
16R18A	16"	18"	5"	16"
18R18A	18"	18"	5"	16"
20R18A	20"	18"	5"	16"
22R18A	22"	18"	5"	16"
24R18A	24"	18"	5"	16"
26R18A	26"	18"	5"	16"
28R18A	28"	18"	5"	16"
30R18A	30"	18"	5"	16"

Adjustable 90° Elbow



- The elbow adjusts from 0° to 90° easily in order to clear rafters or ceiling joists.
- The adjustable 90° elbow is constructed of four sections for smoother bends and less resistance.

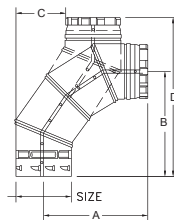

Part#	Size	A	B	C	D
3EAL	3"	4½"	5¼"	1½"	8"
4EAL	4"	5"	5½"	1½"	8¾"
5EAL	5"	5½"	6"	2 ¼"	9¼"
6EAL	6"	6½"	7"	2½"	10¼"
7RAL	7"	7¾"	8"	3"	12¼"
8RAL	8"	8¾"	9"	3¼"	13"



45° Elbow



- Elbows are used to offset installation to avoid obstructions such as rafters & joists.
- Size 3" through 14" adjust easily from 0° to 45°.
- Sizes 16" through 30" are non-adjustable.
- See the Gas Vent Offsets.

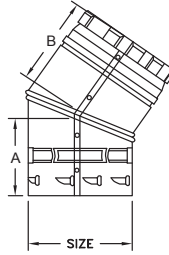

Part #	Size	A	B	Adjustable
3E45	3"	3"	2¾"	0° - 45°
4E45	4"	3⅛"	3⅛"	0° - 45°
5E45	5"	3½"	3½"	0° - 45°
6E45	6"	4"	3⅓⅓"	0° - 45°
7R45	7"	4 ¹⁵ / ₁₆ "	4¼"	0° - 45°
8R45	8"	4¾"	4 ⁹ / ₁₆ "	0° - 45°
9R45	9"	5"	5 ³ / ₈ "	0° - 45°
10R45	10"	5 ⁷ / ₈ "	5 ³ / ₈ "	0° - 45°
12R45	12"	6"	5 ³ / ₈ "	0° - 45°
14R45	14"	6 ⁵ / ₈ "	6½"	0° - 45°
16R45	16"	7"	7"	NON
18R45	18"	7½"	7½"	NON
20R45	20"	8"	7 ⁵ / ₈ "	NON
22R45	22"	8½"	8 ⁵ / ₈ "	NON
24R45	24"	8 ⁵ / ₈ "	8 ¹⁵ / ₁₆ "	NON
26R45	26"	9"	9"	NON
28R45	28"	9½"	9½"	NON
30R45	30"	10"	10"	NON

Tee

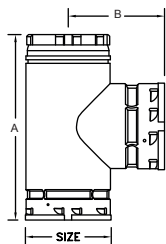

- A tee transitions a system from horizontal to vertical orientation.
- Branch and trunk diameters of the standard tee are the same size.
- For smaller branch sizes, use a reducing tee up to 6" size.
- For larger sizes, use an increaser with a standard tee.

Part#	Size	A	B	Part#	Size	A	B
3ET	3"	7⅛"	4⅛"	14RT	14"	24"	11¾"
4ET	4"	8 ⁷ / ₈ "	4 ⁵ / ₈ "	16RT	16"	26"	13"
5ET	5"	10"	5¼"	18RT	18"	28½"	14¼"
6ET	6"	11½"	5¾"	20RT	20"	30"	15½"
7RT	7"	13"	6½"	22RT	22"	33"	16¾"
8RT	8"	14"	6 ⁷ / ₈ "	24RT	24"	36"	18"
9RT	9"	15"	7¾"	26RT	26"	38"	19"
10RT	10"	16"	8⅛"	28RT	28"	40"	20"
12RT	12"	17 ⁹ / ₁₆ "	9¾"	30RT	30"	42"	21"

Reducing Tee



- The reducing tee features a branch with a smaller diameter than its trunk size, and provides a convenient connection of the furnace and water heater to a common vent.

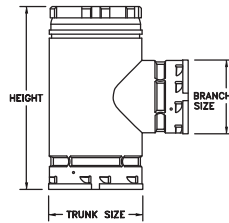

Part #	Trunk Size	Branch Size	Height
4ET-3	4"	3"	8 ⁷ / ₈ "
5ET-4	5"	4"	10"
6ET-3	6"	3"	11 ¹ / ₂ "
6ET-4	6"	4"	11 ¹ / ₂ "
6ET-5	6"	5"	11 ¹ / ₂ "

Tee Caps



- The tee cap provides closure for the tee.

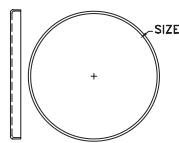

Part #	Size	Part #	Size	Part #	Size
3ETC	3"	9RTC	9"	20RTC	20"
4ETC	4"	10RTC	10"	22RTC	22"
5ETC	5"	12RTC	12"	24RTC	24"
6ETC	6"	14RTC	14"	26RTC	26"
7ETC	7"	16RTC	16"	28RTC	28"
8ETC	8"	18RTC	18"	30RTC	30"

Standard Wye



- A wye is used to common vent two or more appliances and provides better gas flow than a standard tee.
- The standard wye features the branch, trunk, and base diameter with the same size.

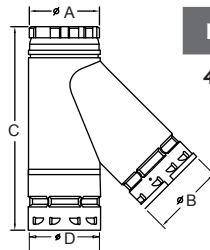

Part#	Size	A	B	C	D
4EY	4"	4 ¹ / ₂ "	4 ¹ / ₂ "	9"	4 ¹ / ₂ "

Reduction Wye



- A wye is used to common vent two or more appliances and provides better gas flow than a standard tee.
- The reduction wye features a branch and/or base with a smaller diameter than the trunk size.

Part#	Size	A	B	C	D
4EY-3	4"	4 ¹ / ₂ "	3 ¹ / ₂ "	9"	4 ¹ / ₂ "
5EY-3	5"	5 ¹ / ₂ "	3 ¹ / ₂ "	9"	5 ¹ / ₂ "
5EY-4	5"	5 ¹ / ₂ "	4 ¹ / ₂ "	10 ¹ / ₂ "	5 ¹ / ₂ "
5EY-33	5"	5 ¹ / ₂ "	3 ¹ / ₂ "	12"	3 ¹ / ₂ "
5EY-34	5"	5 ¹ / ₂ "	3 ¹ / ₂ "	12"	4 ¹ / ₂ "
5EY-43	5"	5 ¹ / ₂ "	4 ¹ / ₂ "	13 ¹ / ₂ "	3 ¹ / ₂ "
5EY-44	5"	5 ¹ / ₂ "	4 ¹ / ₂ "	13 ¹ / ₂ "	4"
6EY-3	6"	6 ¹ / ₂ "	3 ¹ / ₂ "	9"	6 ¹ / ₂ "
6EY-4	6"	6 ¹ / ₂ "	4 ¹ / ₂ "	10 ¹ / ₂ "	6 ¹ / ₂ "
6EY-5	6"	6 ¹ / ₂ "	5 ¹ / ₂ "	12"	6 ¹ / ₂ "

Caps

- Used as a ventilation cap as well as a Type B gas vent termination.
- Protect against wind conditions that can cause gases to spill back into the structure through the appliance draft hood.
- UL-listed, and its patented design of ports and baffles keep rain and debris out of the vent.
- Permits termination of vents at the minimum height necessary above the roof surface.



**Model CW
Universal Cap**

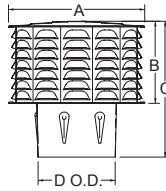

**Model ECW or RCW
Snap-Lock Cap**

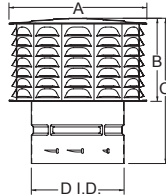

Part #	Size	A	B	C	D O.D.
3CW	3"	6 ³ / ₄ "	2 ⁷ / ₈ "	4 ³ / ₄ "	2 ³ / ₄ "
4CW	4"	6 ³ / ₄ "	4 ³ / ₈ "	6 ¹ / ₂ "	3 ⁷ / ₈ "
5CW	5"	9 ⁷ / ₈ "	4 ⁵ / ₁₆ "	7 ³ / ₈ "	4 ³ / ₄ "
6CW	6"	9 ⁷ / ₈ "	5 ³ / ₄ "	9"	5 ³ / ₄ "
7RW	7"	12 ⁷ / ₈ "	6 ³ / ₈ "	9 ³ / ₁₆ "	6 ³ / ₄ "
8RW	8"	12 ⁷ / ₈ "	7"	10"	7 ⁵ / ₈ "

Part #	Size	A	B	C	D I.D.
3ECW	3"	6 ³ / ₄ "	2 ⁷ / ₈ "	5 ⁵ / ₁₆ "	3 ¹ / ₂ "
4ECW	4"	6 ³ / ₄ "	4 ³ / ₈ "	7"	4 ¹ / ₂ "
5ECW	5"	9 ⁷ / ₈ "	4 ⁵ / ₁₆ "	7 ³ / ₈ "	5 ¹ / ₂ "
6ECW	6"	9 ⁷ / ₈ "	5 ³ / ₄ "	9"	6 ¹ / ₂ "
7RCW	7"	12 ⁷ / ₈ "	6 ³ / ₈ "	9 ¹ / ₂ "	8"
8RCW	8"	12 ⁷ / ₈ "	7"	10 ⁵ / ₁₆ "	9"

Part #	Size	A	B
9C	9"	15 ³ / ₄ "	7 ¹ / ₂ "
10C	10"	15 ³ / ₄ "	7 ¹ / ₂ "
12C	12"	19"	9"
14C	14"	22"	11"
16C	16"	25"	12"
18C	18"	28 ¹ / ₄ "	13 ¹ / ₂ "
20C	20"	31 ¹ / ₂ "	15"
22C	22"	34 ¹ / ₂ "	16 ¹ / ₂ "
24C	24"	37 ³ / ₄ "	18"
26C	26"	42"	19 ¹ / ₂ "
28C	28"	44"	21"
30C	30"	48"	22 ¹ / ₂ "



**Model C
Universal Cap**

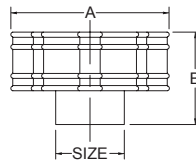

**Model RC
Snap-Lock Cap**

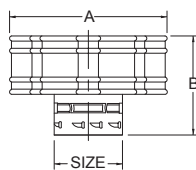

Part #	Size	A	B
9RC	9"	15 ³ / ₄ "	7 ¹ / ₂ "
10RC	10"	15 ³ / ₄ "	7 ¹ / ₂ "
12RC	12"	19"	9"
14RC	14"	22"	11"
16RC	16"	25"	12"
18RC	18"	28 ¹ / ₄ "	13 ¹ / ₂ "
20RC	20"	31 ¹ / ₂ "	15"
22RC	22"	34 ¹ / ₂ "	16 ¹ / ₂ "
24RC	24"	37 ³ / ₄ "	18"
26RC	26"	42"	19 ¹ / ₂ "
28RC	28"	44"	21"
30RC	30"	48"	22 ¹ / ₂ "

Universal Adapters

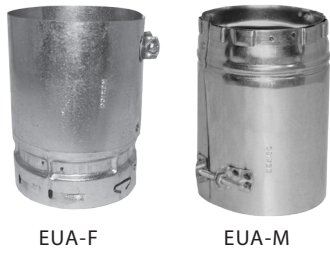

EUA-F

EUA-M

- The universal adapters offer secure, listed connections between AmeriVent Type B Gas Vent and other manufacturers of gas vents.

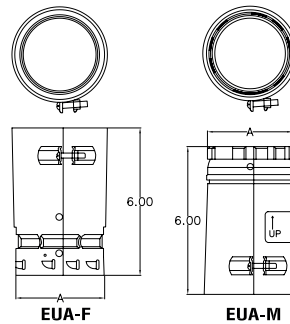

Part #	Size	A
3EUA-M	3"	3½"
3EUA-F	3"	3½"
4EUA-M	4"	4½"
4EUA-F	4"	4½"
5EUA-M	5"	5½"
5EUA-F	5"	5½"
6EUA-M	6"	6½"
6EUA-F	6"	6½"

Vent Pipe Hangers

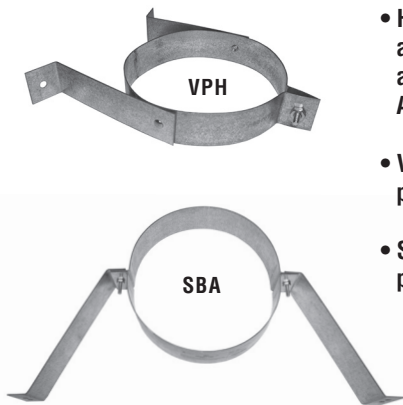

VPH

SBA

- Hangers provide support and resupport for offsets and horizontal runs of AmeriVent gas vent.
- VPH Vent Pipe Hanger provides 1½" spacing.
- SBA Vent Pipe Hanger provides 2" spacing.

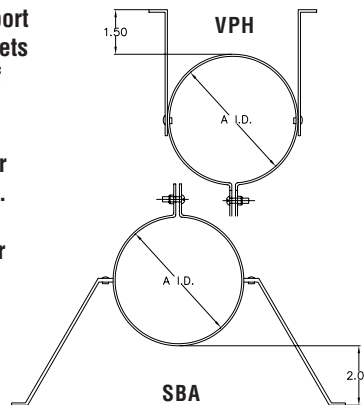

Part #	Pipe Size	A
3VPH	3" E	3½"
4VPH	4" E	4½"
5VPH	5" E	5½"
6VPH	6" E	6½"
7VPH	7" R	8"
6HS-SBA	8" R	9"
8HS-SBA	10" R	11½"
10FB-SBA	12" R	13"

Draft Hood Connector



- The draft hood connector connects Type B gas vent directly to an appliance draft hood.
- The flexible inlet can be shaped to fit oval draft hood outlets.

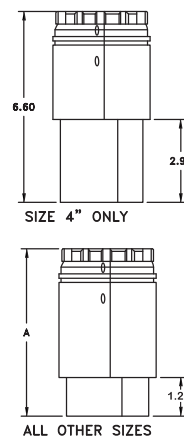

Part #	Size	A
3EDC	3"	6"
4EDC	4"	6.6"
5EDC	5"	6"
6EDC	6"	6"
7RDC	7"	6"
8RDC	8"	6"
9RDC	9"	7"
10RDC	10"	7"
12RDC	12"	7"

Increaser



- The increaser is used to increase the vent size.
- A max of 4 steps of increase.

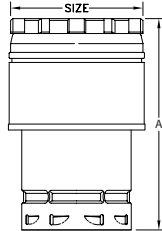

Size	Part #	Size	Part #	Size	Part #	Size	Part #
4"	3EIX4	9"	5EIX9	16"	9RIX16	24"	16RIX24
			6EIX9		10RIX16		18RIX24
5"	3EIX5	10"	7RIX9	18"	12RIX16	26"	20RIX24
	4EIX5		8RIX9		14RIX16		22RIX24
	3EIX6		6EIX10		10RIX18		18RIX26
6"	4EIX6	12"	7RIX10	20"	12RIX18	28"	20RIX26
	5EIX6		8RIX10		14RIX18		22RIX26
			9RIX10		16RIX18		24RIX26
	3EIX7		7RIX12		12RIX20		20RIX28
7"	4EIX7	14"	8RIX12	22"	14RIX20	30"	22RIX28
	5EIX7		9RIX12		16RIX20		24RIX28
	6EIX7		10RIX12		18RIX20		26RIX28
8"	4EIX8	16"	8RIX14	24"	14RIX22	32"	22RIX30
	5EIX8		9RIX14		16RIX22		24RIX30
	6EIX8		10RIX14		18RIX22		26RIX30
	7RIX8		12RIX14		20RIX22		28RIX30

Gripper Support

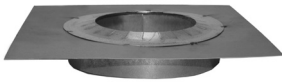

- UL-listed as a support and firestop, the gripper support is strong enough to hold up to 30' of vent pipe.
- It installs very quickly and allows for adjustment of the pipe to wherever needed.
- A ring on the bottom provides the UL-required, one-inch clearance to combustibles (3" to 6" only; 7" to 10" are not UL-listed).
- No tools are required.

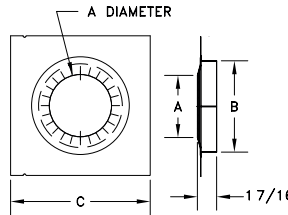

Part #	Size	A	B	C
3EGS	3"	3½"	5½"	9"
4EGS	4"	4½"	6½"	10"
5EGS	5"	5½"	7½"	11"
6EGS	6"	6½"	8½"	12"
7EGS	7"	8"	10"	13"
8EGS	8"	9"	11"	14"
9EGS	9"	10"	12"	15"
10EGS	10"	11"	13"	16"

Bucket Connector



- The Bucket Connector (EBC) is used to make the connection of either AmeriVent single-wall connector pipe, or AmeriVent Type B Gas Vent, utilized as connector through the bottom of the AmeriVent Bucket.

Part #	Size
3EBC	3"
4EBC	4"
5EBC	5"
6EBC	6"
7EBC	7"
8EBC	8"

Bucket Support & Hanger



- The bucket support and hanger is used for starting a vent at ceiling level.
- Supports provide proper clearance and automatic positioning.
- Designed to fit between 16" O.C. joists.
- Buckets only are available in sizes 9" through 22".
- Does not act as a firestop. Use firestop (FS).
- Supports up to 30'.

Bucket Support

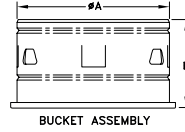

Part #	Size	A	B
3-4AB	3"	6½"	3¾"
3-4AB	4"	6½"	3¾"
5AB	5"	8"	3¾"
6AB	6"	9"	3¾"
7AB	7"	10¾"	6½"
8AB	8"	11⅞"	6½"
9AB	9"	13⅛"	6½"
10AB	10"	13⅛"	6½"
12AB	12"	16¼"	6½"
14AB	14"	18⅛"	6½"
16AB	16"	20⅞"	6½"
18AB	18"	22¼"	6½"
20AB	20"	24¾"	6½"
22AB	22"	26½"	6½"

Bucket Hanger

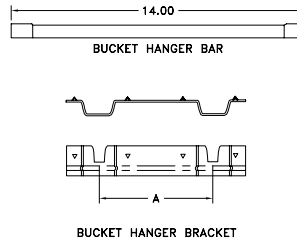

Part #	Size	A
3-4ABH	3"	5⅜"
3-4ABH	4"	5⅜"
5ABH	5"	6½"
6ABH	6"	7¾"
7ABH	7"	8½"
8ABH	8"	9¾"

Firestop Support

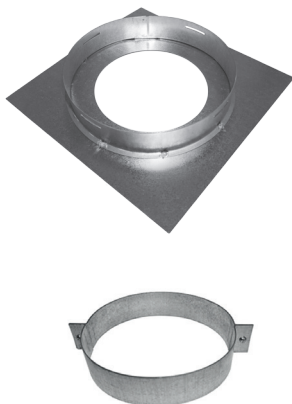

- The firestop support supports Type B gas vent starting at the appliance level and includes a support bucket.
- The support bracket (SB) and firestop (FS) are sold separately.
- Supports up to 20'.

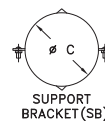
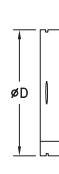
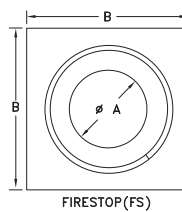

Firestop Support

Part#	Size	A	B	C	D
3FSP	3"	3⅝"	7½"	3½"	5½"
4FSP	4"	4⅝"	8½"	4½"	6½"
5FSP	5"	5⅝"	9½"	5½"	7½"
6FSP	6"	6⅝"	10½"	6½"	8½"
7FSP	7"	8⅛"	21"	8"	10"
8FSP	8"	9⅛"	13"	9"	11"

Firestop		Support Bracket	
Part#	Size	Part#	Size
3FS	3"	3SB	3"
4FS	4"	4SB	4"
5FS	5"	5SB	5"
6FS	6"	6SB	6"
7FS	7"		
8FS	8"		

Support Plate

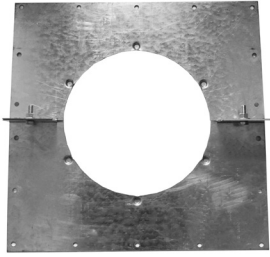

- The support plate is designed to provide strength and durability for supporting large size pipe sections, and serves as a firestop.
- Supports up to 30'.

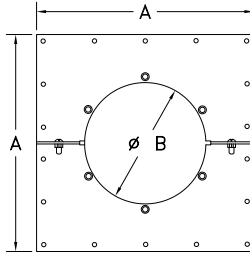

Part#	Size	A	B
9RSP	9"	17"	9 ⁵ / ₈ "
10RSP	10"	18"	10 ⁵ / ₈ "
12RSP	12"	20"	12 ⁵ / ₈ "
14SP	14"	22"	14 ⁵ / ₈ "
16SP	16"	24"	16 ⁵ / ₈ "
18SP	18"	26"	18 ⁵ / ₈ "
20SP	20"	28"	20 ⁵ / ₈ "
22SP	22"	30"	22 ⁵ / ₈ "
24SP	24"	32"	24 ⁵ / ₈ "
26SP	26"	34"	26 ⁵ / ₈ "
28SP	28"	36"	28 ⁵ / ₈ "
30SP	30"	38"	30 ⁵ / ₈ "

Tee Support Plate



- The support plate supports tee sizes 3" through 6".
- Used as a base for Type B gas vent.

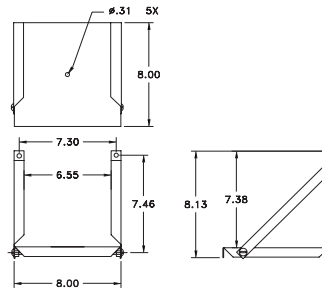

Part#
3-6SP

Vent Collar



- The vent collar provides a cover for a rough wall opening.
- Fits double-wall pipe only.

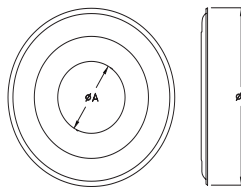

Part#	Size	A	B
3EVC	3"	3 ⁵ / ₈ "	8 ³ / ₄ "
4EVC	4"	4 ⁵ / ₈ "	8 ³ / ₄ "
5EVC	5"	5 ⁵ / ₈ "	10 ⁷ / ₈ "
6EVC	6"	6 ⁵ / ₈ "	12 ⁷ / ₈ "
7RVC	7"	8 ¹ / ₈ "	14 ⁷ / ₈ "
8RVC	8"	9 ¹ / ₈ "	16 ⁷ / ₈ "
9RVC	9"	10 ¹ / ₈ "	18 ⁷ / ₈ "
10RVC	10"	11 ¹ / ₈ "	20 ⁷ / ₈ "
12RVC	12"	13 ¹ / ₈ "	22 ⁷ / ₈ "

Wall Thimble



- Used to install pipe through an interior wall and provide proper clearance from combustibles.

- The wall thimble adjusts for various wall thicknesses from 4" to 6".

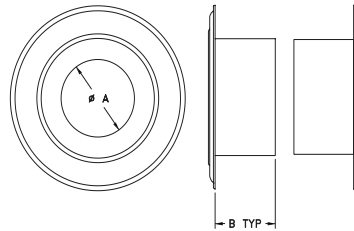

Part#	Size	A	B
3EWT	3"	3 ⁹ / ₁₆ "	3 ¹ / ₁₆ "
4EWT	4"	4 ⁹ / ₁₆ "	3 ¹ / ₁₆ "
5EWT	5"	5 ⁹ / ₁₆ "	3 ¹ / ₁₆ "
6EWT	6"	6 ⁹ / ₁₆ "	3 ¹ / ₄ "
7RWT	7"	8 ¹ / ₁₆ "	3 ¹ / ₄ "
8RWT	8"	9 ¹ / ₁₆ "	3 ¹ / ₄ "
9RWT	9"	10 ¹ / ₁₆ "	3 ¹ / ₄ "
10RWT	10"	11 ¹ / ₁₆ "	3 ¹ / ₄ "
12RWT	12"	13 ¹ / ₁₆ "	3 ¹ / ₄ "

Storm Collar

FIXED



- Used to provide weather strip seal to pipe above flashing.

- Seal the inner edge with sealant against pipe.

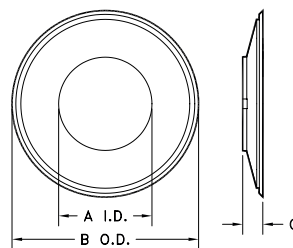

Part#	Size	A I.D.	B O.D.	C
3ESC	3"	3 ¹ / ₂ "	6 ⁵ / ₈ "	1 ⁷ / ₁₆ "
4ESC	4"	4 ¹ / ₂ "	7 ⁵ / ₈ "	1 ¹ / ₂ "
5ESC	5"	5 ¹ / ₂ "	8 ⁵ / ₈ "	1 ⁵ / ₈ "
6ESC	6"	6 ¹ / ₂ "	9 ⁵ / ₈ "	1 ¹ / ₂ "

ADJUSTABLE

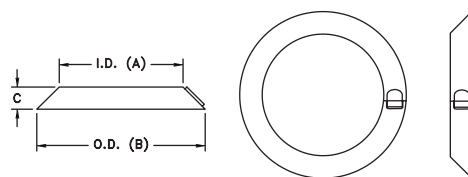

Part#	Size	A I.D.	B O.D.	C
7RSC	7"	8"	10 ⁷ / ₈ "	1 ⁷ / ₁₆ "
8RSC	8"	9"	11 ⁷ / ₈ "	1 ⁷ / ₁₆ "
9RSC	9"	10"	13 ³ / ₁₆ "	1 ¹ / ₂ "
10RSC	10"	11"	14 ¹ / ₂ "	1 ³ / ₄ "
12RSC	12"	13"	16 ¹ / ₂ "	1 ³ / ₄ "
14SC	14"	15"	18 ¹ / ₂ "	1 ¹⁵ / ₁₆ "
16SC	16"	17"	21 ¹ / ₄ "	2 ¹ / ₈ "
18SC	18"	19"	23 ³ / ₄ "	2 ⁵ / ₁₆ "
20SC	20"	21"	25 ¹⁵ / ₁₆ "	2 ¹ / ₂ "
22SC	22"	23"	28 ⁵ / ₁₆ "	2 ¹¹ / ₁₆ "
24SC	24"	25"	30 ¹¹ / ₁₆ "	1 ⁷ / ₈ "
26SC	26"	27"	33 ¹ / ₁₆ "	3 ¹ / ₁₆ "
28SC	28"	29"	35 ¹ / ₁₆ "	3 ¹ / ₄ "
30SC	30"	31"	37 ¹ / ₁₆ "	3 ⁷ / ₁₆ "

Standard Flashing

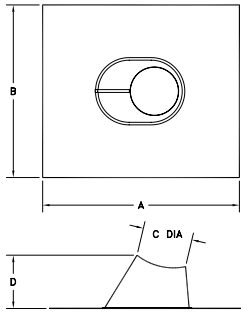
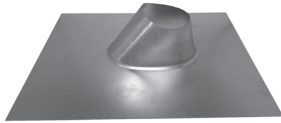

- Flashing used where the vent installation passes through the roof.
- The standard flashing fits flat to 6/12 pitch roof.
- Built with double-seamed construction for protection from leakage.

Part #	Size	A	B	C Dia	D
3EF	3"	14 ³ / ₄ "	12 ¹ / ₂ "	3 ⁵ / ₈ "	4"
4EF	4"	16 ³ / ₈ "	13 ³ / ₄ "	4 ⁵ / ₈ "	5"
5EF	5"	17 ¹⁵ / ₁₆ "	15"	5 ⁵ / ₈ "	4 ⁹ / ₁₆ "
6EF	6"	18 ³ / ₄ "	16 ¹ / ₈ "	6 ⁵ / ₈ "	6"
7RF	7"	20"	17 ⁷ / ₈ "	8 ⁵ / ₃₂ "	6 ⁵ / ₈ "
8RF	8"	21"	21"	9 ⁵ / ₃₂ "	6 ⁵ / ₈ "
9RF	9"	22"	22"	10 ⁵ / ₃₂ "	6 ⁵ / ₈ "
10RF	10"	24 ¹ / ₈ "	24 ¹ / ₈ "	11 ⁵ / ₃₂ "	7 ¹ / ₈ "
12RF	12"	25 ¹ / ₆ "	25 ¹ / ₆ "	13 ¹ / ₈ "	7 ⁵ / ₈ "

Part #	Size	A	B
14F	14"	28"	28"
16F	16"	30 ¹ / ₈ "	30 ¹ / ₈ "
18F	18"	31 ¹ / ₂ "	31 ¹ / ₂ "
20F	20"	34"	34"
22F	22"	34 ¹ / ₂ "	34 ¹ / ₂ "
24F	24"	37"	37"
26F	26"	43"	43"
28F	28"	45"	45"
30F	30"	46"	46"

6" Skirt Standard Flashing

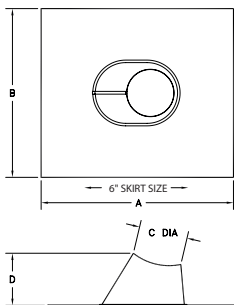

- A standard flashing with a 6" skirt.

Part #	Size	A	B	C Dia	D
3EFFU	3"	20 ¹ / ₄ "	15 ¹ / ₂ "	3 ⁵ / ₈ "	4"
4EFFU	4"	20 ¹ / ₄ "	18"	4 ⁵ / ₈ "	5"
5EFFU	5"	24"	19"	5 ⁵ / ₈ "	4 ⁹ / ₁₆ "
6EFFU	6"	24"	19"	6 ⁵ / ₈ "	6"
7RFFU	7"	25 ¹ / ₆ "	21 ¹ / ₂ "	8 ⁵ / ₃₂ "	6 ⁵ / ₈ "
8RFFU	8"	25 ¹ / ₆ "	25 ¹ / ₆ "	9 ⁵ / ₃₂ "	6 ⁵ / ₈ "
9RFFU	9"	26"	26"	10 ⁵ / ₃₂ "	6 ⁵ / ₈ "
10RFFU	10"	29"	27"	11 ⁵ / ₃₂ "	7 ¹ / ₈ "
12RFFU	12"	29"	29 ⁹ / ₁₆ "	13 ¹ / ₈ "	7 ⁵ / ₈ "
14RFFU	14"	32"	32"	15 ¹ / ₈ "	8 ¹ / ₈ "

Steep Pitch Flashing

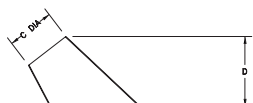
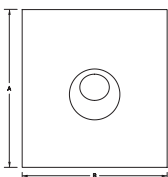
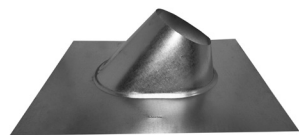

- The Steep Pitch Flashing handles roof pitches of 6/12 to 12/12.

Part #	Size	A	B	C Dia	D
3EF12	3"	17 ⁷ / ₈ "	15"	3 ⁵ / ₈ "	6 ¹ / ₂ "
4EF12	4"	17 ⁷ / ₈ "	15"	4 ⁵ / ₈ "	6 ¹³ / ₁₆ "
5EF12	5"	22 ⁵ / ₈ "	17"	5 ⁵ / ₈ "	7 ¹ / ₂ "
6EF12	6"	22 ⁵ / ₈ "	17"	6 ⁵ / ₈ "	8"
7RF12	7"	21 ¹³ / ₁₆ "	21 ¹³ / ₁₆ "	8 ¹ / ₈ "	8 ⁷ / ₈ "
8RF12	8"	23 ¹ / ₈ "	23 ¹ / ₈ "	9 ¹ / ₈ "	9 ¹ / ₂ "

Tall Cone Flashing

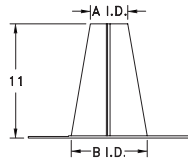
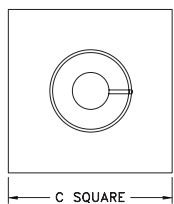

- The flashing with a tall cone fits flat to 1/12 roof pitch.
- Used on flat roofs in snow packed areas to reduce chances of snow covering vent.

Part #	Size	A I.D.	B O.D.	C
3EFT	3"	3 ⁵ / ₈ "	7 ¹ / ₂ "	16"
4EFT	4"	4 ⁵ / ₈ "	7 ¹ / ₂ "	16"
5EFT	5"	5 ⁵ / ₈ "	7 ¹ / ₂ "	16"
6EFT	6"	6 ⁵ / ₈ "	7 ¹ / ₂ "	16"
7RFT	7"	8 ¹ / ₈ "	11"	18 ⁹ / ₁₆ "
8RFT	8"	9 ¹ / ₈ "	11"	18 ⁹ / ₁₆ "
10RFT	10"	11 ¹ / ₈ "	16"	24 ¹ / ₈ "
12RFT	12"	13 ¹ / ₈ "	16"	24 ¹ / ₈ "
14FT	14"	15 ⁹ / ₁₆ "	19 ⁵ / ₁₆ "	27"

Part #	Size	A I.D.	B O.D.	C
16FT	16"	17 ⁹ / ₁₆ "	19 ⁵ / ₁₆ "	30"
18FT	18"	19 ⁹ / ₁₆ "	23 ⁹ / ₁₆ "	32 ⁵ / ₁₆ "
20FT	20"	21 ⁹ / ₁₆ "	23 ⁹ / ₁₆ "	36"
22FT	22"	23 ⁹ / ₁₆ "	27 ⁹ / ₁₆ "	39"
24FT	24"	25 ⁹ / ₁₆ "	27 ⁹ / ₁₆ "	40"
26FT	26"	27 ⁹ / ₁₆ "	31 ⁹ / ₁₆ "	43"
28FT	28"	29 ⁹ / ₁₆ "	31 ⁹ / ₁₆ "	45"
30FT	30"	31 ⁹ / ₁₆ "	35 ⁹ / ₁₆ "	46"

Pipe Section

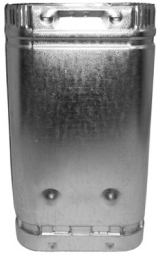

• The oval pipe offers all the advantages of AmeriVent round pipe, and may be used for the following types of installation.

4" Oval: Conventional Type B, Type B-2x4 when used with firestop Type BW

5" Oval: Type B Type B-2x4

6" Oval: Type B

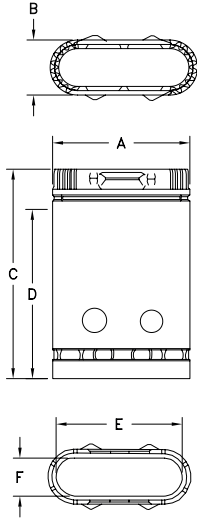

Part #	Size	A	B	C	D	E	F
406	4"	7 ¹ / ₁₆ "	2 ⁷ / ₈ "	6"	4 ³ / ₄ "	6 ¹ / ₂ "	2 ¹ / ₄ "
4012	4"	7 ¹ / ₁₆ "	2 ⁷ / ₈ "	12"	10 ³ / ₄ "	6 ¹ / ₂ "	2 ¹ / ₄ "
4018	4"	7 ¹ / ₁₆ "	2 ⁷ / ₈ "	18"	16 ³ / ₄ "	6 ¹ / ₂ "	2 ¹ / ₄ "
4024	4"	7 ¹ / ₁₆ "	2 ⁷ / ₈ "	24"	22 ³ / ₄ "	6 ¹ / ₂ "	2 ¹ / ₄ "
403	4"	7 ¹ / ₁₆ "	2 ⁷ / ₈ "	36"	34 ³ / ₄ "	6 ¹ / ₂ "	2 ¹ / ₄ "
404	4"	7 ¹ / ₁₆ "	2 ⁷ / ₈ "	48"	46 ³ / ₄ "	6 ¹ / ₂ "	2 ¹ / ₄ "
405	4"	7 ¹ / ₁₆ "	2 ⁷ / ₈ "	60"	58 ³ / ₄₈ "	6 ¹ / ₂ "	2 ¹ / ₄ "
506	5"	10 ³ / ₄ "	2 ⁷ / ₈ "	6"	4 ³ / ₄ "	9 ³ / ₄ "	2 ¹ / ₄ "
5012	5"	10 ³ / ₄ "	2 ⁷ / ₈ "	12"	10 ³ / ₄ "	9 ³ / ₄ "	2 ¹ / ₄ "
5018	5"	10 ³ / ₄ "	2 ⁷ / ₈ "	18"	16 ³ / ₄ "	9 ³ / ₄ "	2 ¹ / ₄ "
5024	5"	10 ³ / ₄ "	2 ⁷ / ₈ "	24"	22 ³ / ₄ "	9 ³ / ₄ "	2 ¹ / ₄ "
503	5"	10 ³ / ₄ "	2 ⁷ / ₈ "	36"	34 ³ / ₄ "	9 ³ / ₄ "	2 ¹ / ₄ "
504	5"	10 ³ / ₄ "	2 ⁷ / ₈ "	48"	46 ³ / ₄ "	9 ³ / ₄ "	2 ¹ / ₄ "
505	5"	10 ³ / ₄ "	2 ⁷ / ₈ "	60"	58 ³ / ₄ "	9 ³ / ₄ "	2 ¹ / ₄ "
606	6"	11 ¹ / ₂ "	3 ¹ / ₄ "	6"	4 ³ / ₄ "	10 ⁷ / ₈ "	2 ⁵ / ₈ "
6012	6"	11 ¹ / ₂ "	3 ¹ / ₄ "	12"	10 ³ / ₄ "	10 ⁷ / ₈ "	2 ⁵ / ₈ "
6018	6"	11 ¹ / ₂ "	3 ¹ / ₄ "	18"	16 ³ / ₄ "	10 ⁷ / ₈ "	2 ⁵ / ₈ "
6024	6"	11 ¹ / ₂ "	3 ¹ / ₄ "	24"	22 ³ / ₄ "	10 ⁷ / ₈ "	2 ⁵ / ₈ "
603	6"	11 ¹ / ₂ "	3 ¹ / ₄ "	36"	34 ³ / ₄ "	10 ⁷ / ₈ "	2 ⁵ / ₈ "

Type B: AmeriVent (Sizes 3" through 30" round and sizes 4", 5", and 6" oval) may be installed with 1" minimum clearance to combustibles.

Type BW: Four-inch oval AmeriVent (when installed in 2 x 4 stud wall with recessed heater) requires clearances as determined by use of 40HD hold-down plate, 40PS ceiling plate spacers, and 40FS firestop spacers.

Type B 2 x 4: Four and five inch oval AmeriVent (when installed in 2 x 4 stud wall with other than recessed heater) requires clearance as determined by use of 40FS or 50FS firestop spacers at ceiling level.

Clearances		
Underwriters' Laboratories-listed Minimum Clearance to Combustibles		
<u>AmeriVent Description</u>	<u>Type</u>	<u>Minimum Clearance</u>
4" Oval (when installed in 2x4 stud wall with recessed heater)	BW	Clearances as determined by use of 40HD hold-down plate, 40PS ceiling plate spacers, and 40FS firestop spacers
4" and 5" Oval (when installed in 2x4 stud wall with other than recessed heater)	B-2x4	Clearance as determined by use of firestop spacers at each ceiling level
4", 5", and 6" Oval	B	1"
3" through 30" Round	B	1"

Adjustable Length



- The adjustable length telescopes onto standard pipe sections to permit adjustments from 3" to 10" to reach desired installation length.

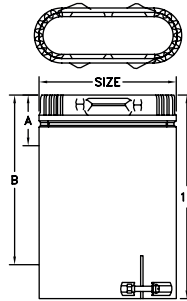

Part #	Size	Extension From A	Range to B
4012A	4"	3"	10"
5012A	5"	3"	10"
6012A	6"	3"	10"

Increaser



- The increaser permits vent to be increased from 4" oval to 5" oval.

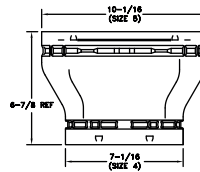

Part #	Size
40IX5	4"

Adapters



- The oval-to-round adapter is used for conversion of vent from oval to round.

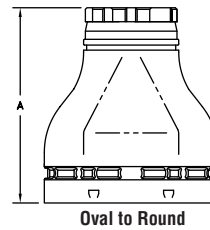

Part #	Size	A
40E	4"	6 ⁷ / ₈ "
50E	5"	9 ³ / ₈ "
60E	6"	10 ³ / ₈ "



- The round-to-oval adapter is used for conversion of vent from round to oval.

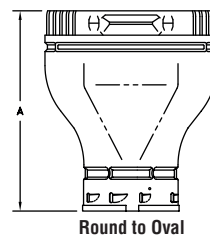

Part #	Size	A
4EO	4"	6 ⁷ / ₈ "
5EO	5"	9 ³ / ₈ "
6EO	6"	10 ³ / ₈ "

45° Elbow - Standard



- The standard 45° elbow is used in pairs where offsets are desired in 1" minimum clearance enclosures or open spaces, such as attics or basements.
- Add pipe sections between pairs to produce additional offset.

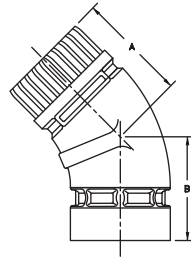

Part #	Size	A	B
4045S	4"	3"	3"
5045S	5"	3½"	3½"
6045F	6"	4"	4"

45° Elbow - Flat



- The flat 45° elbow is used in pairs where offsets are desired in 1" minimum clearance enclosures or open spaces, such as attics or basements.
- Add pipe sections between pairs to produce additional offset.

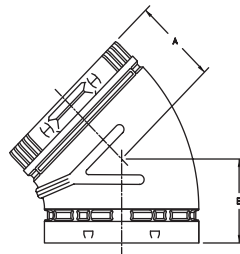

Part #	Size	A	B
4045F	4"	3¾"	3¾"
5045F	5"	4¾"	4¾"
6045F	6"	5"	5"

Tee



- The branch size and trunk size have the same diameter.
- The tee branch accepts either double or single wall pipe.

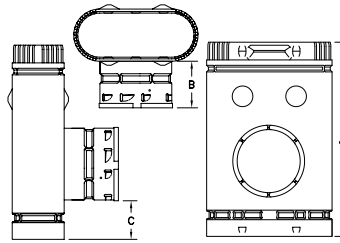

Part #	Size	A	B	C
4OT	4"	12"	2 ⁹ / ₁₆ "	2 ³ / ₈ "
5OT	5"	12"	2 ⁹ / ₁₆ "	2 ³ / ₈ "
6OT	6"	12"	2 ⁵ / ₈ "	2 ³ / ₄ "

Reducing Tee



- The branch size of the reducing tee is one inch smaller than the trunk size.

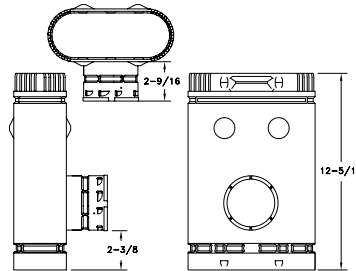

Part #	Size	A	B	C
4OT-3	4"	12"	2 ⁹ / ₁₆ "	2 ³ / ₈ "

Oval Tee Cap

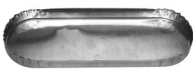

- The aluminum tee cap is used for closing off the bottom of a tee.

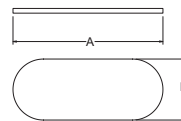

Part #	Size	A	B
4OTC	4"	6 ³ / ₁₆ "	2 ¹ / ₄ "
5OTC	5"	9 ⁷ / ₈ "	2 ¹ / ₄ "
6OTC	6"	10 ³⁷ / ₈ "	2 ⁵ / ₈ "

Tee Support

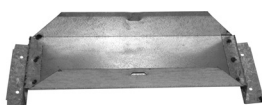

- The tee support is used to support and center the oval tee.
- Use with the tee cap (OTC).

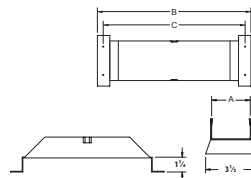

Part #	Size	A	B	C
4OTS	4"	3"	11 1/2"	10 ⁵ / ₈ "
5OTS	5"	3"	12 ⁷ / ₈ "	12"
6OTS	6"	4 1/4"	4 1/4"	13 ³ / ₈ "

Tee Collar



- The tee collar may be used to cover the rough wall opening and the exposed double-wall connector
- The 3-40TVC collar features a knock-out for a 3" or 4" single wall connector.

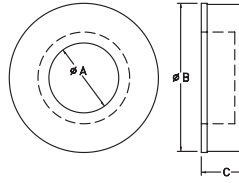

Part #	Size	A	B	C
3-40TVC	4"	3 1/8" - 4 1/8"	6 3/4"	2"
50TVC	5"	5 1/8"	6 3/4"	2"
60TVC	6"	6 1/8"	8 3/4"	2"

Oval Cap



- Model OCA (Locking)
- Model OC (Universal)

Part #	Size	A	B
4OCA	4" oval	5 3/8" x 8 1/2"	3 1/2"
4OC	4" oval	5 3/8" x 8 1/2"	3 1/2"

Oval Storm Collar



- Used to provide a weather proof seal to an oval pipe above a roof line.
- Installed above the oval flashing.
- Seal inner edge with sealant.

Part#	Size
40SC	4"
50SC	5"
60SC	6"

All-Pitch Flashing

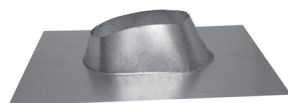

- All-Pitch Flashing is installed either parallel or perpendicular to the roof ridge.
- Fits roof pitches flat to 5/12.

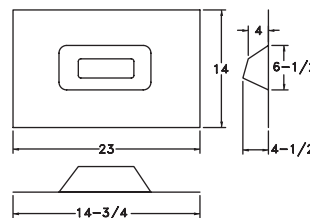

Part #	SIZE
40F	4"
50F	5"
60F	6"

Firestop Spacers

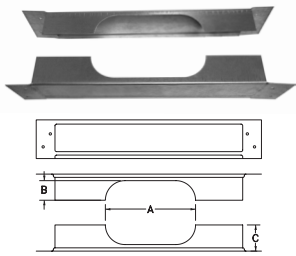

- The firestop spacers center vent in 16" O.C. stud space and serve as a firestop at the ceiling level.
- A required component for Type B 2 x 4 and multi-story Type BW installations.

Part #	SIZE	WALL SIZE	A	B	C
40FS	4"	2" X 4"	7 1/4"	1 1/2"	2"
50FS	5"	2" X 4"	10 13/16"	1 1/2"	2"
40FS-6	4"	2" X 6"	7 1/4"	1 1/2"	3"
50FS-6	5"	2" X 6"	10 13/16"	1 1/2"	3"
60FS	6"	2" X 6"	11 9/16"	1 11/16"	3"

Type BW Hold-Down Plate

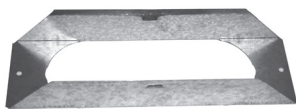

- The Type BW hold-down plate is required for connecting Type BW vent to a wall furnace outlet.

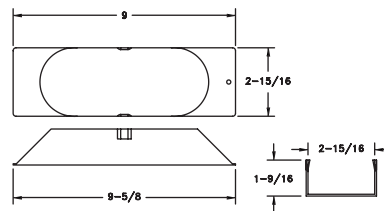

Part #	SIZE
40HD	4"

Type BW Plate Spacers



- The Type BW plate spacers are required at the first ceiling level above a wall furnace.
- The spacers center and provide the required opening between floors.
- Firestop spacers must be used at subsequent levels.

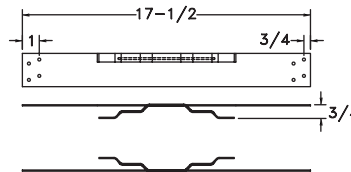

Part #	SIZE
40PS	4"

Type BW Attic Shield

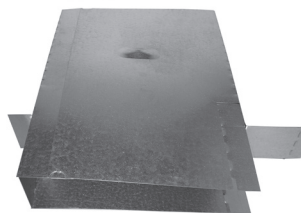

- The Type BW attic shield is used on a single-story building or on the top story of a multi-story building for Type BW gas vent.
- A 26-gauge galvanized sleeve should extend from the top of the ceiling plate into the attic.
- A Type BW attic shield is required by Los Angeles Code and UMC.

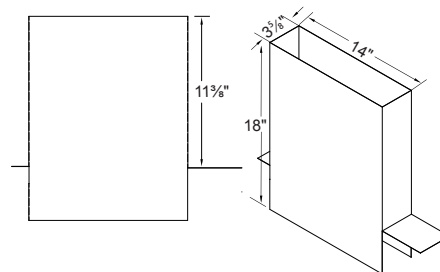

Part #
AVS

Type BW Installation Kit



- The Type BW installation kit contains one pair of Type BW plate spacers (40PS) and one BW hold-down plate (40HD).



Part #
40BW

Gas Vent Termination Table

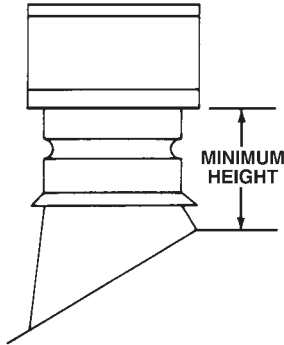

AmeriVent caps in 3" through 12" sizes may be installed in accordance with the Gas Vent Termination Table if the vent is at least 8' from any vertical wall.

For installation of caps 14" and larger, or for caps that are less than 8' from a vertical wall, the cap is to be located no less than 2' above the highest point where the vent passes through the roof and at least 2' higher than any portion of a building within 10'.

Roof Pitch	Minimum Height
flat to 7/12	1.0 feet
over 7/12 to 8/12	1.5 feet
over 8/12 to 9/12	2.0 feet
over 9/12 to 10/12	2.5 feet
over 10/12 to 11/12	3.25 feet
over 11/12 to 12/12	4.0 feet
over 12/12 to 14/12	5.0 feet
over 14/12 to 16/12	6.0 feet
over 16/12 to 18/12	7.0 feet
over 18/12 to 20/12	7.5 feet
over 20/12 to 21/12	8.0 feet

Gas Vent Offsets Table

This table is used to determine the offset produced by two AmeriVent 45° adjustable elbows set at the maximum angle of 45°. Also shown are the offsets produced by introducing various lengths of AmeriVent between the two elbows.

Maximum Offset in Inches

Vent Size	With Two 45° Elbows Only	One 6" Length	One 12" Length	One 18" Length	One 24" Length	One 3' Length	One 4' Length	One 5' Length
3	3 1/4	6 3/4	11	15 1/4	19 1/2	28	36 1/2	45
4	3 1/2	7	11 1/4	15 1/2	19 3/4	28 1/4	36 3/4	45 1/4
5	4 1/4	7 3/4	12	16 1/4	20	29	37 1/2	46
6	4 1/2	8	12 1/4	16 1/2	20 3/4	29 1/4	37 3/4	46 1/4
7	5	8 1/2	12 3/4	17	21 1/4	29 3/4	38 1/4	46 3/4
8	5 1/2	9	13 1/4	17 1/2	21 3/4	30 1/4		47 1/4
9	6		13 3/4	18	22 1/4	30 3/4		
10	7 1/4		15	19 1/4	23 1/2	32		
12	7 1/4		15	19 1/4	23 1/2	32		
14	8 1/2		16 1/4	20 1/2	24 3/4	33 1/4		
16	9 1/4		17	21 1/4	25 1/2	34		
18	10		17 3/4	22	26 1/4	34 3/4		
20	10 1/4		18	22 1/4	26 1/2	35		
22	10 1/4		18	22 1/4	26 1/2	35		
24	11 1/4		19	23 1/4	27 1/2	36		
26	12		19 3/4	24	28 1/4	36 3/4		
28	12 3/4		20 1/2	24 3/4	29	37 1/2		
30	13 1/2		21 1/4	25 1/2	29 3/4	38 1/4		

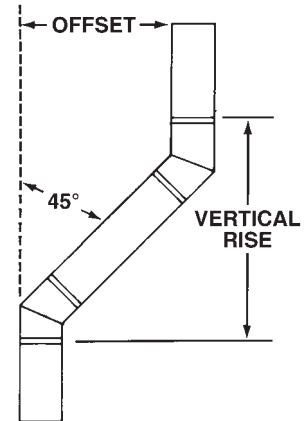

Note: The vertical rise can also be closely estimated by adding one "A" and one "B" dimension to Maximum Offset figures. (See page 5 for "A" and "B" dimensions of Round Adjustable 45° Elbows.)

System Design and Installation Guides

The following installation guidelines have been prepared to assist you in your particular application and in installing a vent correctly.

Before laying out a gas vent system for any gas appliance, the installer should first consult the local code and the appliance manufacturer's installation requirements. Only then should you pick your components and design your vent system.

AmeriVent offers a wide range of round and oval pipe sizes and adjustable components to provide maximum design flexibility. All three basic gas vent installations (as defined by Underwriters Laboratories, Inc.) can be constructed using AmeriVent. These three are:

TYPE B

AmeriVent (Sizes 3" through 30" round and sizes 4", 5", and 6" oval) may be installed with 1" minimum clearance to combustibles.

TYPE BW

Four-inch oval AmeriVent (when installed in 2 x 4 stud wall with recessed heater) requires clearances as determined by use of 40HD hold-down plate, 40PS ceiling plate spacers, and 40FS firestop spacers.

TYPE B 2X4

Four- and five-inch oval AmeriVent (when installed in 2 x 4 stud wall with other than recessed heater) requires clearance as determined by use of 40FS or 50FS firestop spacers at each ceiling level.

To graphically illustrate the use of AmeriVent components in typical installations, we offer the diagrams on the next page. Here you'll see just about every AmeriVent part and how each in its natural setting contributes to the whole.

To guide you in these and other installations, the following general rules should be followed.

1. Provide an adequate air supply. Remember, you must meet local code minimum requirements for both combustion air and draft hood dilution air.
2. Attach vent to appliances draft hood with sheet metal screws and terminate the vent at least 5 feet above the draft hood. For wall furnaces, vents must terminate at least 12 feet from bottom of heater. See Gas Vent Termination Table on page 19 for required height above roof.
3. One gas vent may serve more than one gas appliance. Prudent advance planning (see diagrams on next page) can save you time.
4. Keep offsets and lengths of laterals to a minimum to reduce vent resistance.
5. Strap the vent securely in position, always maintaining at least 1" clearance to combustibles. Firestops should be used where vents pass through floors, walls, or ceilings. (See Product Description section for Round Wall Thimble, Vent Collar, Bucket Support, Support Plate, Firestop Support Plate, and Oval Firestop Spacer.)
6. The vent termination must be securely guyed or braced if it extends more than 5 feet above the roof.
7. For longer-lasting durability and better appearance, all vents exposed to the weather (except caps) should be painted.
8. Outside vents reduce venting action; therefore, such installations are not recommended.

Typical AmeriVent Type B Gas Vent Installations

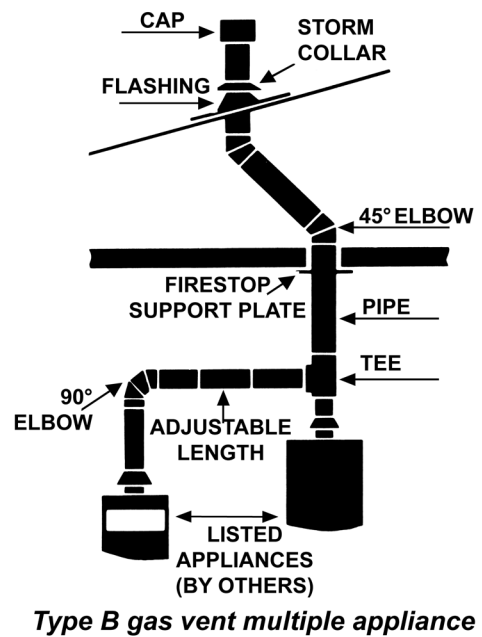
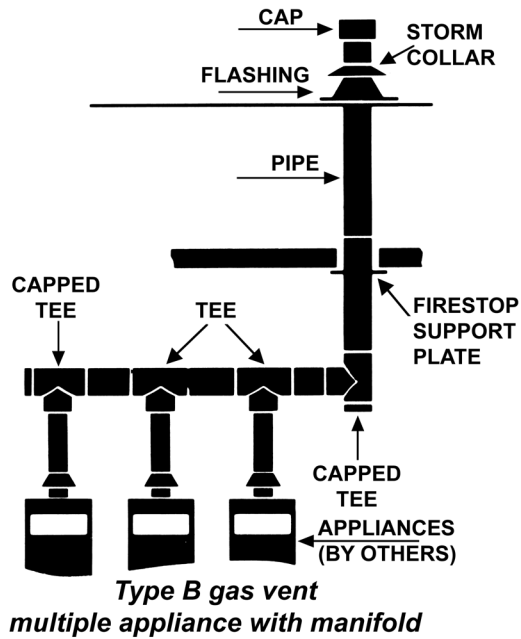
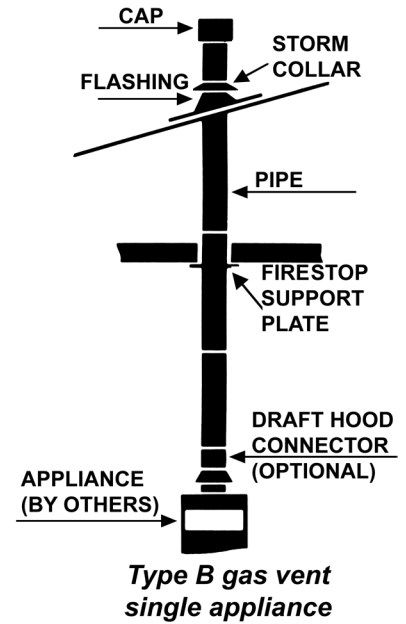
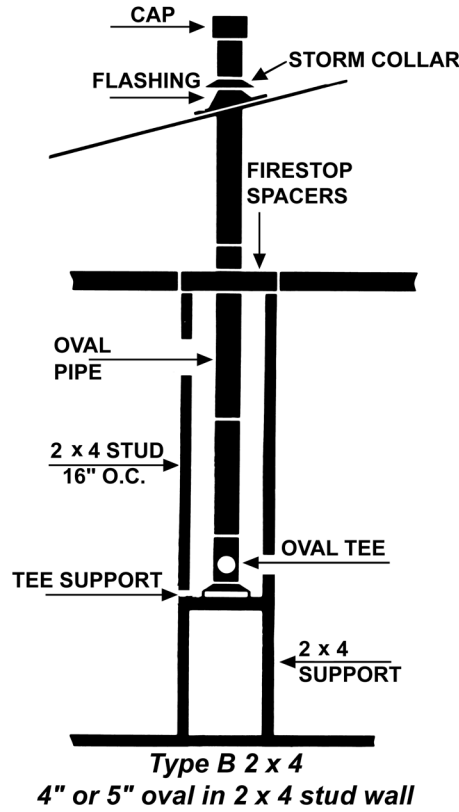
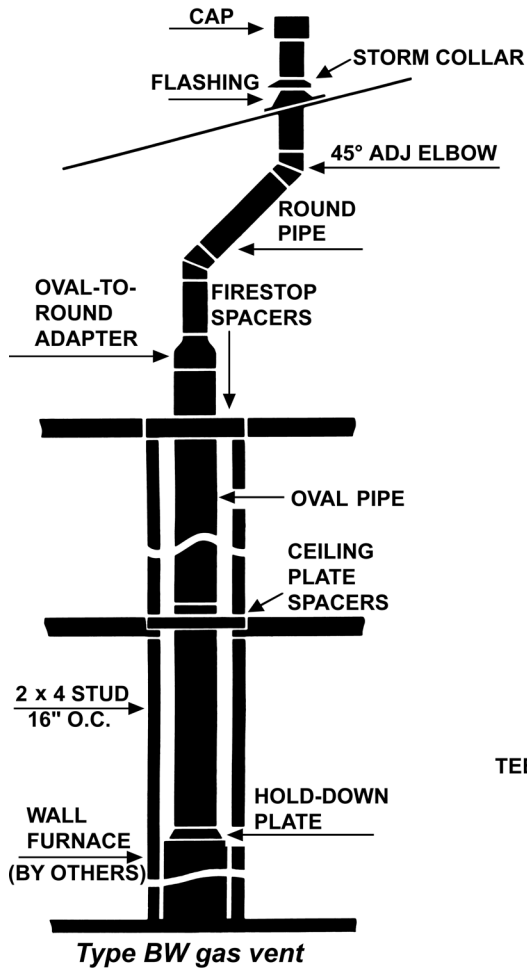

GAS VENT CONNECTORS

Specifications and Dimensions

Double-Wall Segment

Usage

The double-wall flexible gas vent segment can be used as a connector or a segment of a Type B gas vent system. That means it can be installed in unconditioned spaces, such as attics and crawl spaces, anywhere Type B gas vent is used, except where it passes through walls, ceilings, floors, or the roof.

Available Flexible Pipe Sizes

3", 4", 5"

Available Lengths

24", 3', 4', 5'

Material

Flexible Pipe: Aluminum Alloy 3003
Single-wall Ends: Aluminum-zinc coated steel
Rigid Components: Aluminum-zinc coated steel

Material Thickness

Flexible Pipe: .012"
Single-wall Pipe Ends: .018"
Rigid Components: .018"

Clearance

One (1) inch to combustibles. Do not enclose. Do not pass through walls, floors or ceilings.

Single-Wall Connector

Usage

Single-wall flexible gas vent connectors connect appliances to double-wall Type B gas vent. AmeriVent gas vent connectors are used with listed gas appliances with drafthoods or other gas appliances listed for use with Type B gas vent. They cannot be used in unconditioned spaces.

Available Flexible Pipe Sizes

3", 4", 5"

Available Lengths

12", 24", 3', 4', 5'

Material

Flexible Pipe: Aluminum Alloy 3003
Single-wall Ends: Aluminum-zinc coated steel
Rigid Components: Aluminum-zinc coated steel

Material Thickness

Flexible Pipe: .012"
Single-wall Pipe Ends: .018"
Rigid Components: .018"

Clearance

One (1) inch to combustibles. Do not enclose. Do not pass through walls, floors or ceilings.

Double-Wall Gas Vent Segment



- Double-wall corrugated aluminum with B vent ends can be used anywhere B vent is used, except where it passes through walls, floors, ceiling, and inside enclosures.
- May be compressed to fit.

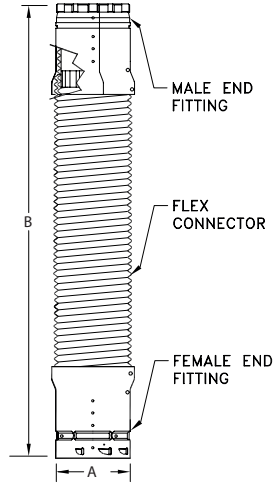

Part #	A	B
3ADFC24	3"	24"
3ADFC3	3"	3'
3ADFC4	3"	4'
3ADFC5	3"	5'
4ADFC24	4"	24"
4ADFC3	4"	3'
4ADFC4	4"	4'
4ADFC5	4"	5'
5ADFC24	5"	24"
5ADFC3	5"	3'
5ADFC4	5"	4'
5ADFC5	5"	5'

Single-Wall Gas Vent Segment



- Single-wall corrugated aluminum easily connects from the appliance to AmeriVent Type B gas vent.
- May be compressed 4" per foot to shorten length.
- Sturdy galvalume ends offer proven snap-lock design.
- This product can only be used in the room with the equipment in occupied spaces, not in unoccupied spaces such as attics or crawl spaces.
- It cannot be used to pass through a wall, roof or ceiling, and cannot be totally enclosed.

Part #	A	B
3FC12	3"	12"
3FC24	3"	24"
3FC3	3"	3'
3FC4	3"	4'
3FC5	4"	5'
4FC12	4"	12"
4FC24	4"	24"
4FC3	4"	3'
4FC4	4"	4'
4FC5	4"	5'
5FC12	5"	12"
5FC24	5"	24"
5FC3	5"	3'
5FC4	5"	4'
5FC5	5"	5'

Assemblies

- Assemblies consist of a single-wall flexible connector with an appliance connector and a universal adapter pre-attached.
- An assembly allows easy connection from an appliance to any brand of B vent.

Part #	6 Pack consists of:
R3FCA-24	6 each of 24" length
R3FCA-3	6 each of 36" length

Standard Single-Wall Wye



- The branch, trunk, and base diameters of the standard single-wall wye are the same size.

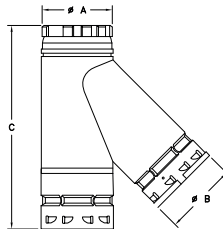

Part#	Size	A	B	C
3FCY	3 1/2"	3 1/2"	3 1/2"	9"
4FCY	4 1/2"	4 1/2"	4 1/2"	10 1/2"

Reduction Single-Wall Wye



- The reduction single-wall wye features a branch and/or base with a diameter smaller than the trunk size.
- Convenient connection for furnace and water heater into a common connector.

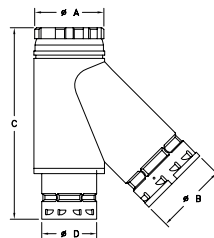

Part#	Size	A	B	C	D
4FCY-3	4"	4 1/2"	4 1/2"	9"	3 1/2"
4FCY-33	4"	4 1/2"	3 1/2"	12"	3 1/2"
5FCY-34	5"	5 1/2"	4 1/2"	12"	3 1/2"
5FCY-44	5"	5 1/2"	4 1/2"	13 1/2"	3 1/2"
5FCY-43	5"	5 1/2"	3 1/2"	13 1/2"	3 1/2"

Single-Wall Increaser



- The single-wall increaser is used to increase the connector diameter.

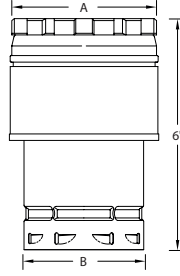

Part #	Size	A	B
3FCX4	4"	4 ½"	3 ½"
3FCX5	5"	5 ½"	3 ½"
3FCX6	6"	6 ½"	3 ½"
4FCX5	5"	5 ½"	4 ½"
4FCX6	6"	6 ½"	4 ½"
5FCX6	6"	6 ½"	5 ½"

Single-Wall Appliance Connector



- The single-wall connector is sized to fit outlet.
- Use sheet metal screws for code-approved appliance connection.

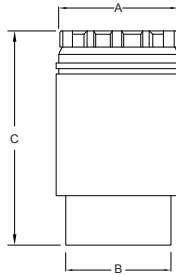

Part #	Size	A	B	C
3FC-AC	3"	3 ½"	3"	6"
4FC-AC	4"	4 ½"	4"	6"
5FC-AC	5"	5 ½"	5"	6"

Single-Wall Universal Adapter



- The single-wall universal adapter provides a short slip connector with the AmeriVent single-wall snap-lock base.

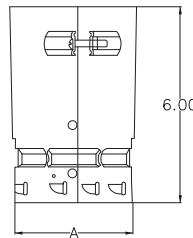

Part #	Size	A
3FCA	3"	3 ½"
4FCA	4"	4 ½"
5FCA	5"	5 ½"

GAS VENT CONNECTORS

Typical Installations

Multiple Appliances with Common Vent

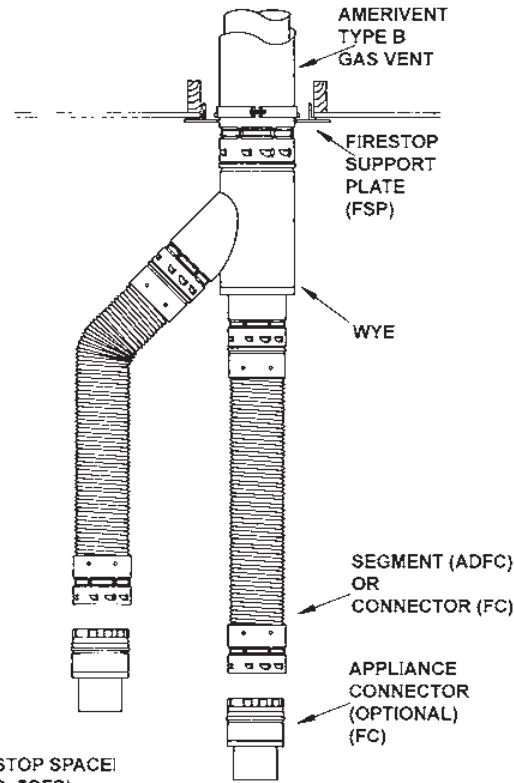

Oval Type B (2x4) in 2x4 Stud Space

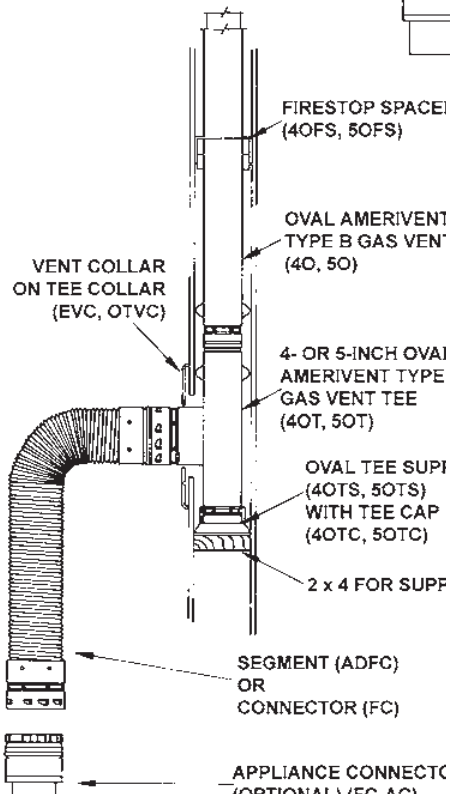

Single Appliance

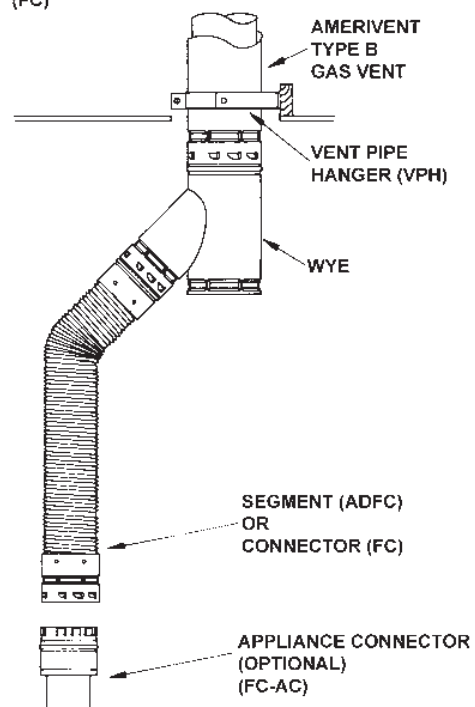

Flexi-Liner Aluminum Chimney Liner Kits

- Kits include flexible length, round top, flashing, mortar guard.
- Standard kit lengths of 25' and 35'.
- Available in 3", 4", 5", 6", 7" and 8" diameters in both kits and 10' extensions.
- 10' insulated sleeve has tough polyethylene exterior.
- Extension kit includes Flexi-Liner tube with attached connector and fastener package.
- Pull-downs stretch and lead the Flexi-Liner down the chimney and assist in pulling insulated sleeve over liner.

Specifications:

Liner Material

Aluminum 3003, 2-ply (0.005" each)

Maximum Flue Gas Temperature

470°F

Available Size Range

3" to 8" diameter

Standard Kit Lengths

25' and 35'

Stretch Ratio

5:1 (approximate)

Clearances

0" between liner and chimney interior

0" between combustible materials and chimney exterior

Lifetime Warranty



Kit Aluminum

Part #	Size	Width	Length
3ALK15	3"	3"	15'
3ALK25	3"	3"	25'
3ALK35	3"	3"	35'
4ALK15	4"	4"	15'
4ALK25	4"	4"	25'
4ALK35	4"	4"	35'
5ALK15	5"	5"	15'
5ALK25	5"	5"	25'
5ALK35	5"	5"	35'
55ALK15	5.5"	5.5"	25'
55ALK25	5.5"	5.5"	35'
6ALK25	6"	6"	25'
6ALK35	6"	6"	35'
7ALK25	7"	7"	25'
7ALK35	7"	7"	35'
8ALK25	8"	8"	25'
8ALK35	8"	8"	35'

Insulated Sleeves

Part #	Size	Width	Length
4ALK-FS	3"-4"	3"-4"	10'
5ALK-FS	5"	5"	10'
6ALK-FS	5.5"-6"	5.5"-6"	10'
7ALK-FS	7"	7"	10'
8ALK-FS	8"	8"	10'

Extension Kits

Part #	Size	Width	Length
3ALKE10	3"	3"	10'
4ALKE10	4"	4"	10'
5ALKE10	5"	5"	10'
55ALKE10	5.5"	5.5"	10'
6ALKE10	6"	6"	10'
7ALK10	7"	7"	10'
8ALK10	8"	8"	10'

Flex Connectors

Part #	Size
3ALK-FC3	3"
4ALK-FC4	4"
5ALK-FC5	5"
55ALK-FC55	5.5"
6ALK-FC6	6"
7ALK-FC7	7"
8ALK-FC8	8"

Pull-Downs

Part #	Size
3FX-PD3	3"
4FX-PD4	4"
5FX-PD5	5"
55FX-PD55	5.5"
6FX-PD6	6"
7FX-PD7	7"
8FX-PD8	8"

Universal B-Vent Adapters

Part #	Size
3ALK-VA	3"
4ALK-VA	4"
5ALK-VA	5"
6ALK-VA	6"
7ALK-VA	7"
8ALK-VA	8"

CHIMNEY LINER KITS

Recommended Installations for Listed Gas Appliances

Single Freestanding Appliance

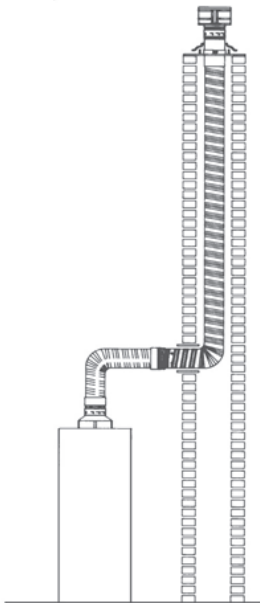

Multiple Freestanding Appliance

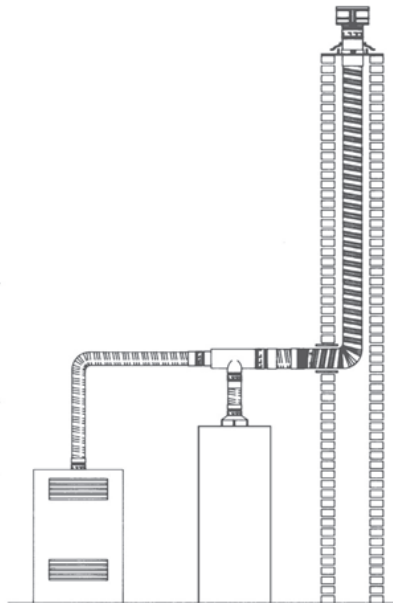

Gas Insert

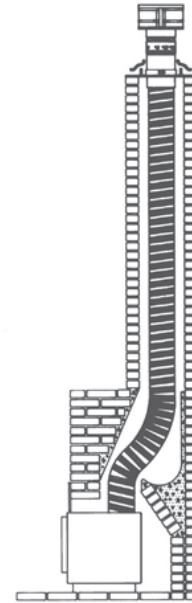

Note: *Installations are shown with AmeriVent flexible single-wall connectors. Freestanding appliances may also use AmeriVent Type B gas vent or code-approved single-wall material between appliance and liner.*

LIMITED LIFETIME WARRANTY

Ameri-Vent ("we," "us," "our") warrants chimney and venting products to be free from defects in material and workmanship for as long as the original consumer owns the system. For products installed after January 15, 2007, for a period of ten (10) years from original installation, we will provide replacement product with a similar or like quality of available product, **free of charge** excluding any installation costs. From the eleventh (11th) through fifteenth (15th) years, we will provide replacement product to the original consumer at a cost of 75% off the published retail price in effect on the date the claim is received, excluding any installation costs. At expiration of the fifteen- (15) year term, we will provide replacement product to the original consumer at a cost of 50% off the published retail price in effect on the date the claim is received, excluding any installation costs.

PROFESSIONAL INSTALLATIONS:

If installation is performed by Professional Installers certified in the USA by NFI and CSIA, we will provide replacement product with a similar or like quality of available product, free of charge (excluding any installation costs) for the full Fifteen (15) years from the date of original installation. To be eligible for this additional warranty the consumer must provide a proof of installation by a Professional Installer when submitting a claim.

LIMITATIONS:

- Products must be installed for their intended purpose.
- Products must be connected to residential appliance listed with an accredited testing laboratory.

WARNING: FAILURE TO INSTALL PRODUCTS ACCORDING TO THE MANUFACTURER'S INSTRUCTIONS WILL VOID ALL APPLICABLE WARRANTIES AND MAY RESULT IN FIRE, CARBON MONOXIDE POISONING OR DEATH. SEE OUR PRODUCT INSTALLATION INSTRUCTIONS FOR COMPLETE INSTRUCTIONS.

WARRANTY COVERAGE:

All lengths, tees and elbows, and components are applicable to warranty coverage.

THIS LIMITED WARRANTY DOES NOT COVER:

- (a) any nonstainless base tee unit mounted or connected to an insulated chimney system;
- (b) costs (labor or otherwise**) associated with either removing a previously installed product, installing a replacement product, transportation or return of a product, or transportation of replacement product;
- (c) damage to the finish of products caused by the use of improper solvents/chemicals or improper cleaning methods;
- (d) damage resulting from failure to reasonably clean, care for, or maintain products in accordance with our installation instructions/recommendations;
- (e) damage (to products, appliances or structure) based on or resulting from improper installation or repair, misuse or abuse (including, but not limited to, excessive or improper operating condition), or alteration or adjustment other than in conformity with our installation instructions and specifications, whether performed by a contractor, service company, technician, or yourself;
- (f) any products that have been moved from their original installation site.
- (g) damage caused by burning driftwood, garbage, or any other prohibitive material in the appliance served by the chimney
- (h) damage that results from accidents such as fire, flood, high winds, "acts of God," or any other contingency beyond our control.

****Due to the wide variance in installation practices and other conditions beyond our control, we do not guarantee or in any way warrant the installation of chimney and venting products.**

CLAIM PROCEDURE:

If you believe that a product is defective, notify us in writing at the following location.

HCI
Attn: Warranty Claims
5030 Corporate Exchange Blvd. SE
Grand Rapids, MI 49512

800.423.4270 p
800.623.3825 f
www.ameri-vent.com

Notification should include a description of the product, model and serial number (if applicable), and a description of the product defect. Upon receipt of a written claim under this limited warranty and evidence of the date of purchase or installation, at our option and in our sole discretion, we will provide replacement product with similar or like quality of available product excluding any installation costs. We reserve the right to inspect or investigate any warranty claims prior to determining whether to provide replacement product. If, as determined by us that repair or replacement of the product is not commercially practicable or cannot be completed in a timely manner, we may refund the prorated purchase price paid for the product upon verification by providing a copy of your invoice or receipt of bill of sale.

NOTES



is proud to be an HCI brand

**5030 Corporate Exchange Blvd.
Grand Rapids, MI 49512**

**P (800) 423-4270
F (800) 626-3825**

**Technical Support
(800) 669-3190**

ameri-vent.com